

OREGON CORNER RESTORATION FORM

FILED

JK

Section 22 Township 22S Range 9W

OCT 2 1990

County Douglas Date 9/13/90

COUNTY SURVEYOR
DOUGLAS COUNTY, ORE.

Corner Designation

Center West 1/16

- Condition Report Only
- Not Found
- Renewed
- Unrecorded
- Surveyed In
- Referenced Out

Previous Renewals/Surveys, etc.

Monument(s) & Accessories Found: (Condition and Source)

Referenced corner monument and pulled corner during Road construction. Reset corner after Road construction to original position.

13" DF Bears N13°W 16.2 FT. (destroyed by Rd Construction)
16" DF Bears S78°E 11.1 FT.

Monument Detail

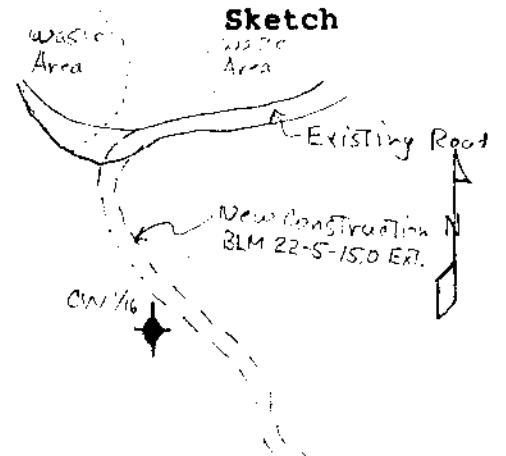
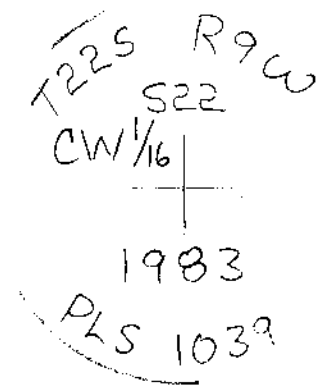

Monument Set (Procedures and Description)

Brass cap on 2" Iron pipe 36" long set firmly into ground at top of fill from new road construction with a 1/2" x 4 foot rebar 2' feet North of corner driven 1/2 feet into ground.

New Accessories

- 30" DF bears S24°W 29.8 feet To midbase. I scribe CW 1/16 S22 RT and Tag Tree
- 24" DF bears N52°E 85.54 feet To 5" spike midbase. I scribe CW 1/16 S22 RT + Tag Tree
- 26" DF bears S85 1/2°W 39.45 feet midbase. I Tag Tree
- 18" maple in clump bears N34°E 100.55 ft To 5" spike in face. I Tag Tree

Location & Comments

Lone Rock Timber Co
P.O. Box 1127
Roseburg OR 97470

Compass Declination 19 1/2°
Firm/Agency _____

Surveyor's Seal

REGISTERED
PROFESSIONAL
LAND SURVEYOR

Ken W Hoffine

OREGON
JULY 18, 1987
KEN W. HOFFINE
2291