

M189-74 A+B

FILED

JH

OREGON CORNER RESTORATION FORM

APR 9 1990

Section 11 Township 22S Range 26W

COUNTY SURVEYOR
DOUGLAS COUNTY, ORE.

County DOUGLAS Date 3/23/90

Corner Designation

EAST 1/4 CORNER, ALSO
BEING THE COMMON 1/4
CORNER TO SECTION 12

- Condition Report Only
- Not Found
- Renewed
- Unrecorded
- Surveyed In
- Referenced Out

Previous Renewals/Surveys, etc. _____

Monument(s) & Accessories Found: (Condition and Source)

NO CONCLUSIVE EVIDENCE OF THE ORIGINAL
CORNER WAS FOUND. FOUND 3/4" BOLT
BEARING S 80° 22' 51" E 34.54 FEET AND
CORNER FENCE POST BEARING S 82° 14' E
35.0 FEET FROM REESTABLISHED CORNER.
ORIGIN OF 3/4" BOLT IS UNKNOWN, ROTTED 20"
FIR STUMP BEARS N 22° 52' W 32.2 FEET
FROM FENCE CORNER, NO SCRIBE MARKS FOUND.

Monument Detail

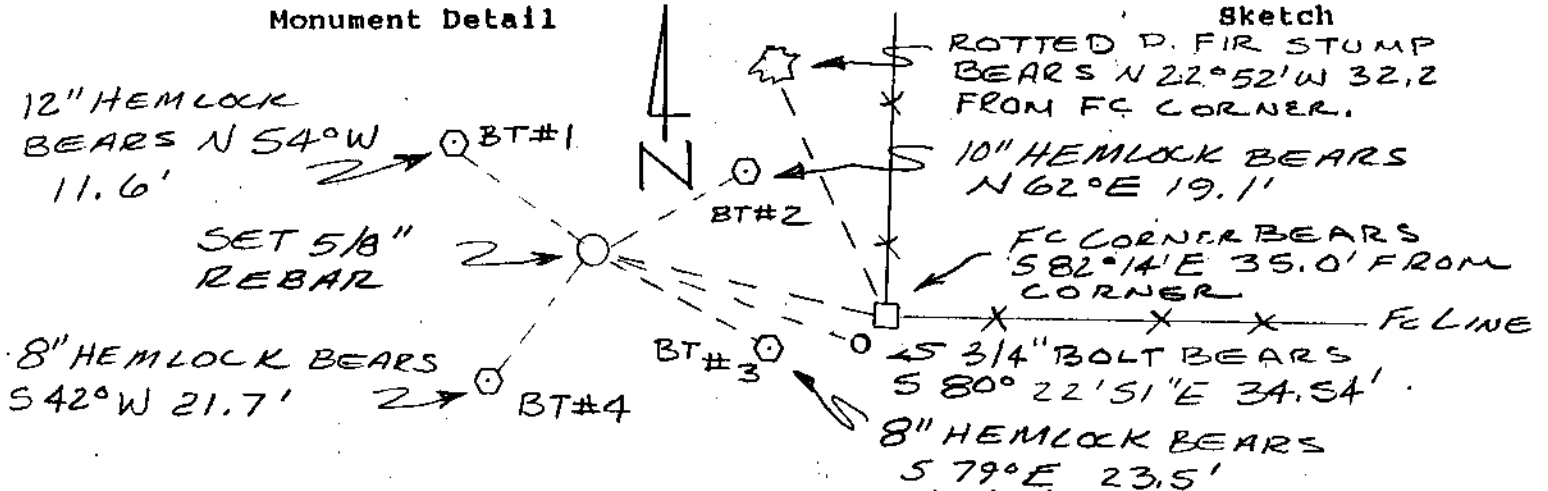

Monument Set (Procedures and Description)

SET 5/8" X 30" REBAR WITH YELLOW
PLASTIC CAP MARKED "BRANCH ENG
LS 1138". CORNER WAS SET BY PROPORTIONATE
MEASUREMENT, ON LINE AT THE MIDPOINT
BETWEEN THE NE AND SE SECTION CORNERS.

New Accessories

- 1) 12" HEMLOCK SCRIBED "E 1/4 S 11 BT" BEARS N 54° W 11.6'
- 2) 10" HEMLOCK SCRIBED "W 1/4 S 12 BT" BEARS N 62° E 19.1'
- 3) 8" HEMLOCK SCRIBED "W 1/4 S 12 BT" BEARS S 79° E 23.5'
- 4) 8" HEMLOCK SCRIBED "E 1/4 S 11 BT" BEARS S 42° W 21.7'

Location & Comments

Compass Declination _____
Firm/Agency BRANCH
ENGINEERING
Address 212 Q STREET
SPRINGFIELD, OR
Party Chief R. OLSON
Notes _____
Witness G. HOFFMAN

Surveyor's Seal

REGISTERED
PROFESSIONAL
LAND SURVEYOR

for A. Deak
OREGON
SEPT. 23, 1977
JAMES A. BRANCH
1138

#1524

C.S. File No. 63/104-10