

SURVEYORS FILE DATA
 NOT REMOVE FROM RECORD

FILED
 1992 JP
 COUNTY CLERK
 EUGENE, OREGON

SURVEY FOR BOUNDARY LINE ADJUSTMENT
 (SEE FILE NO. 91-087)
 FOR
 BOHEMIA, INC.
 IN
 NE 1/4 SECTION 20, T21S, R4W, W.M.
 NW 1/4 SECTION 20, T21S, R4W, W.M.
 DOUGLAS COUNTY, OREGON
 BY
 ROBERTS SURVEYING INC.
 29 WEST 29TH STREET
 EUGENE, OREGON 97405

NOVEMBER 21, 1991
 SCALE 1" = 100'

Keith L. Cubie 12/10/91
 DOUGLAS COUNTY PLANNING DIRECTOR DATE

- "1" = N67°13'50"E, 158.00'
- "2" = N24°04'00"W, 52.58'
- "3" = N24°04'00"W, 91.21'

NARRATIVE, THE PURPOSE OF THIS BOUNDARY LINE ADJUSTMENT IS TO ADJUST THE BOUNDARIES BETWEEN TAX LOTS 100, 300 AND 700 IN ORDER TO SELL AN EXISTING HOUSE TOGETHER WITH APPROXIMATELY 10 ACRES OF LAND. SAID BOUNDARY LINE ADJUSTMENT WAS APPROVED BY THE DOUGLAS COUNTY PLANNING DEPARTMENT ON MAY 6, 1991 (SEE FILE NO. 91-087) AND NOW BOHEMIA, INC WANTS THE BOUNDARIES OF THE NEWLY CREATED PARCEL MONUMENTED. STATE HIGHWAY R/W MONUMENTS WERE FOUND ALONG THE WESTERLY BOUNDARY OF SAID NEW PARCEL AS SHOWN. MONUMENTS "A", "B", "C" AND "D" WERE ARBITRARILY SET SO THAT SAID NEW PARCEL WOULD CONTAIN 10 PLUS ACRES.

- LEGEND
- MONUMENTS FOUND AS NOTED
 - MONUMENTS SET, 5/8" x 30" IRON PINS MARKED "P.L.S. 1039"
 - LINES MARKED WITH 60" ALUMINUM FENCE POSTS.

63/102
 M115-33

Lee G. Roberts



M 115-33

FILED

JUL 14 1992

OREGON CORNER RESTORATION FORM

Section 20 Township 21S Range 4W

County Douglas Date 12-15-91

COUNTY SURVEYOR
DOUGLAS COUNTY, ORE.

CORNER DESIGNATION

N.E. Corner
Section 20

- Condition Report Only
- Not Found
- Renewed
- Unrecorded
- Surveyed In
- Referenced Out

Previous Renewals/Surveys, etc. 1854 G.L.O. Survey by Harvey Gordon; Survey CS41/183 by Charles Bayles in 1953; Re-est. #86 by Milo Godfrey in 1964; B.L.M. Survey by Peter Peterson in 1972; Survey M104-12 by Donald Peel in 1987 and B.L.M. Survey dated 1988.
 Monument(s) & Accessories Found: (Condition and Source)

- Found 1964 Douglas County Brass Cap set firmly in the ground.
- 50" Fir Stump, S14E, 20.5' (Scribe Vis.), 1854 BT. Record S15E, 19.8'
- 10" Fir, S42W, 25.5' (Scar Vis.), 1964 BT. Record S43 1/4 W, 25.7'
- 16" Fir Stump, S07E, 60.5' (Scar Vis.), 1964 BT. Record S08E, 60.5'
- 24" Fir, N54W, 45.8' (Scar Vis.), 1964 BT. Record N55W, 45.5'
- 48" Fir, N31E, 59.1' (Scar Vis.), 1964 BT. Record N31E, 59.0'
- 13" Fir, S85E, 31.2' (Scribe Vis.), 1988 BT. Record S84E, 31.0'

Monument Detail

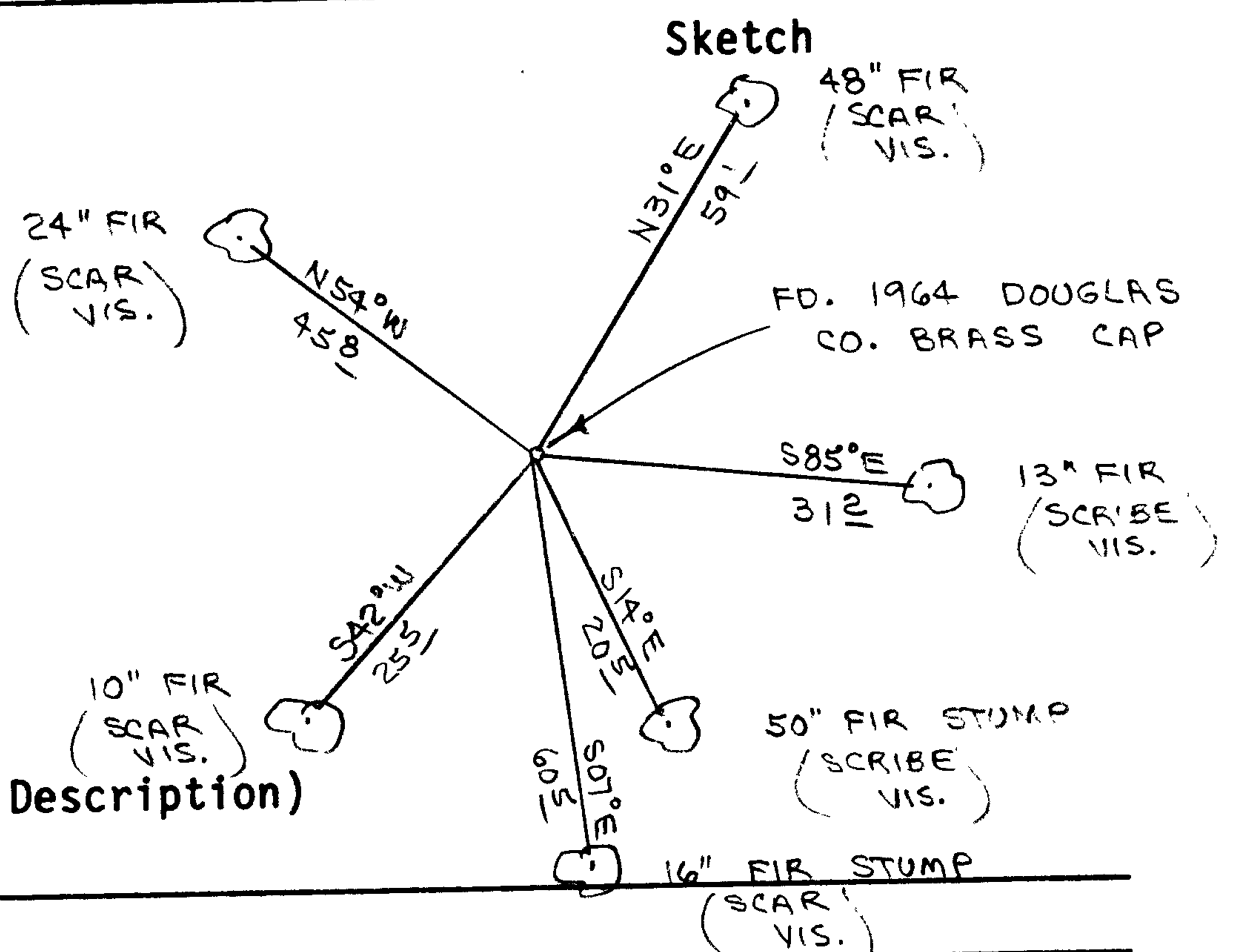
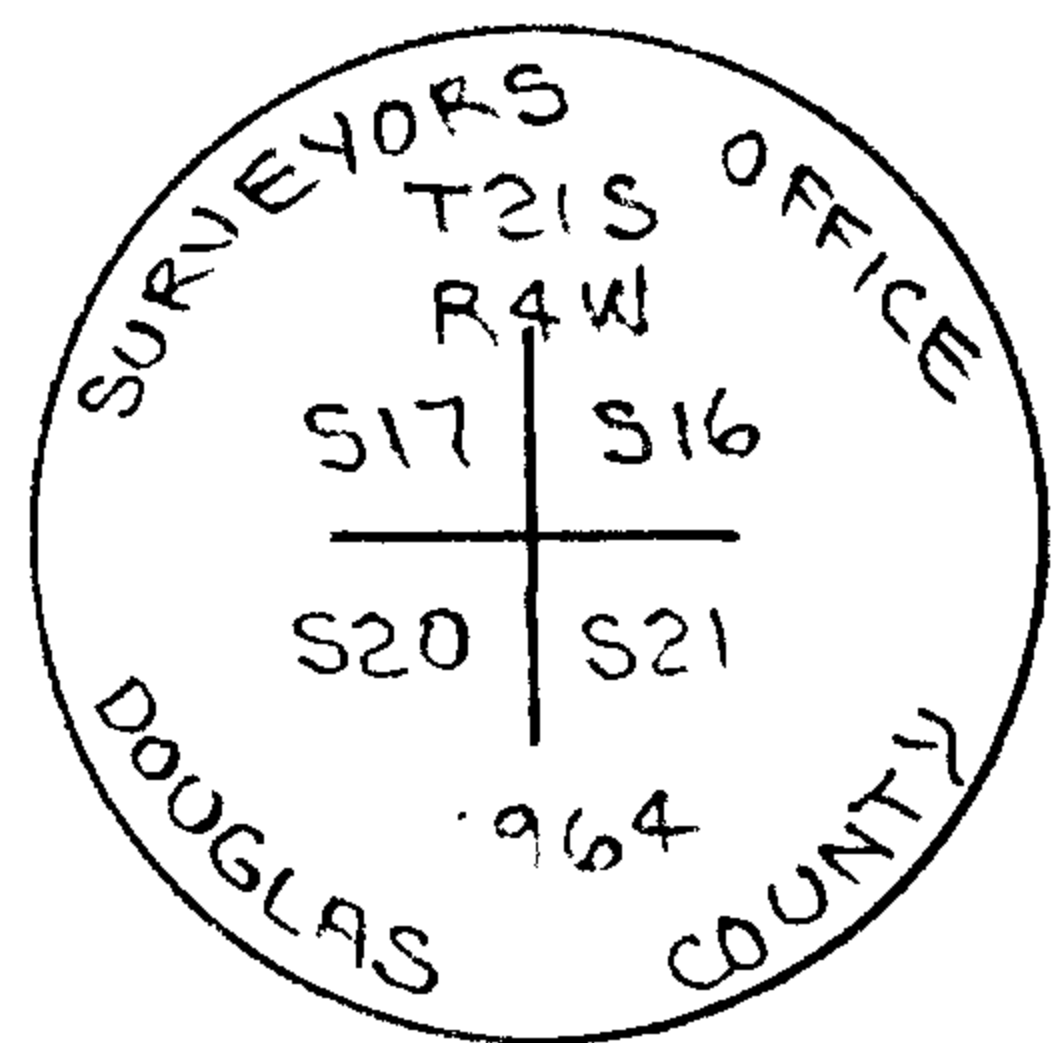

Monument Set (Procedures and Description)

None

New Accessories

None

Location & Comments

Corner lies on S.W. slope
at N.W. corner of new
logged unit.

Compass Declination 20
 Firm/Agency Roberts
Surveying Inc.
 Address 29 West 29th St.
Eugene, Oregon 97405
 Party Chief Ted Baker
 Notes _____
 Witness Brad Cole

Surveyor's Seal

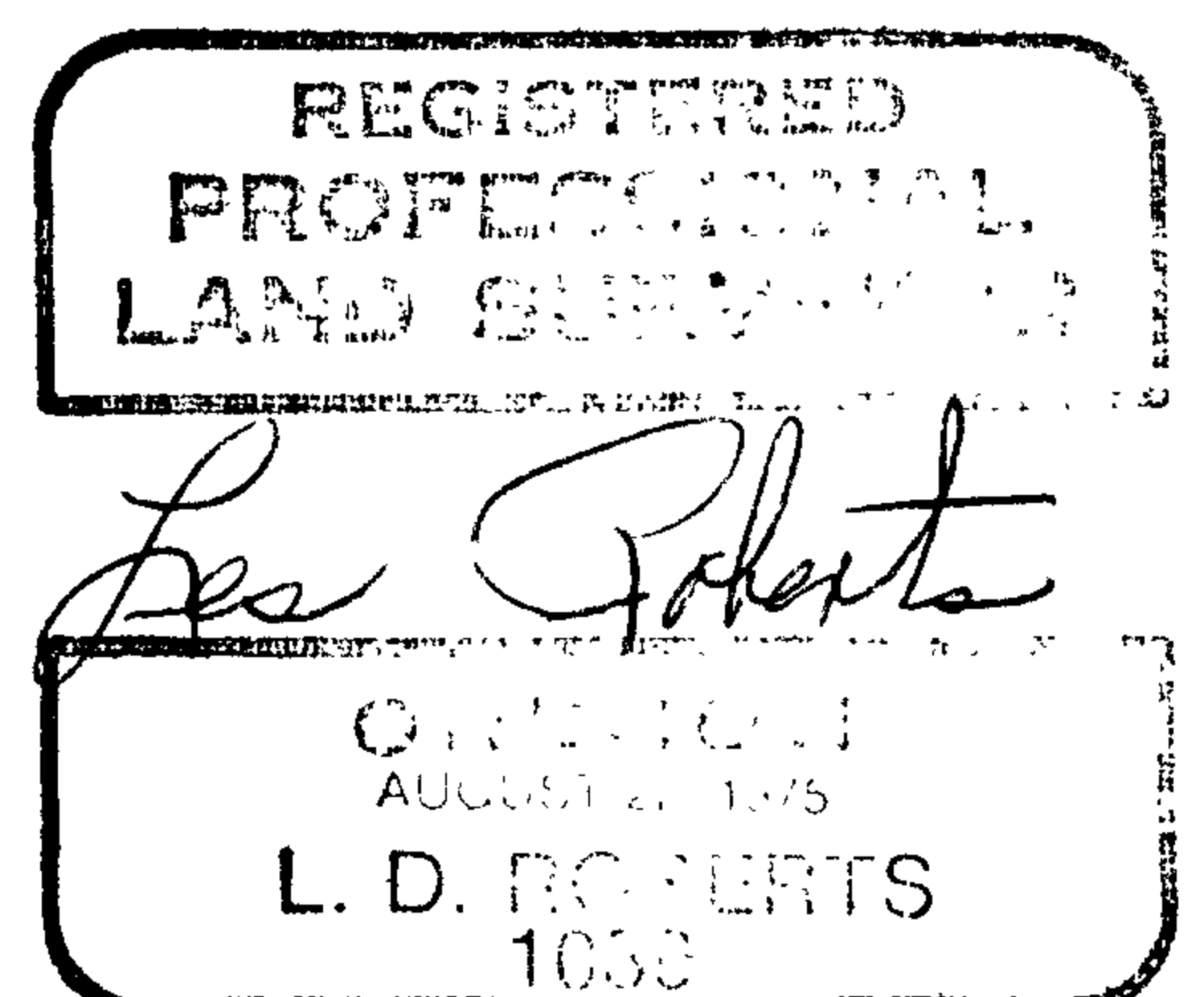

C.S. File No. 63/102