

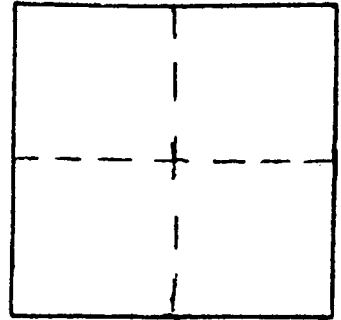

Station: RSBG 49 T 27 S, R 6 W , Sec 21  
 Set By (Agency): CITY (RSBG)  
 Date Set: 1/89  
 Recovered By \_\_\_\_\_  
 Date Recovered \_\_\_\_\_  
 Recovered By \_\_\_\_\_  
 Date Recovered \_\_\_\_\_  
 Recovered By \_\_\_\_\_  
 Date Recovered \_\_\_\_\_



VERTICAL CONTROL

Elevation: 624.67 NGS Line # \_\_\_\_\_ USGS Line # \_\_\_\_\_ OSHD Line # \_\_\_\_\_  
 Precision: \_\_\_\_\_ Agency: \_\_\_\_\_ Proj. # \_\_\_\_\_ Date: \_\_\_\_\_

HORIZONTAL CONTROL

South Zone State Plane Coordinates: Y(Northing) 575,283.33 X(Easting) 1,224,297.35  
 Precision: 1/20,000 Agency: CITY (RSBG) Proj. # \_\_\_\_\_ Date: \_\_\_\_\_  
 Approximate Geographic Position: Latitude 43°12'30" Longitude 123°24'37"

DESCRIPTION and TO REACH

Brass cap stamped "RSBG 49"  
 set flush in concrete.

TO REACH:

Go up Long Meadow Lane  
 turn at first right, go to  
 425 Long Meadow Lane, then  
 Southwest about 300' along  
 ridge.

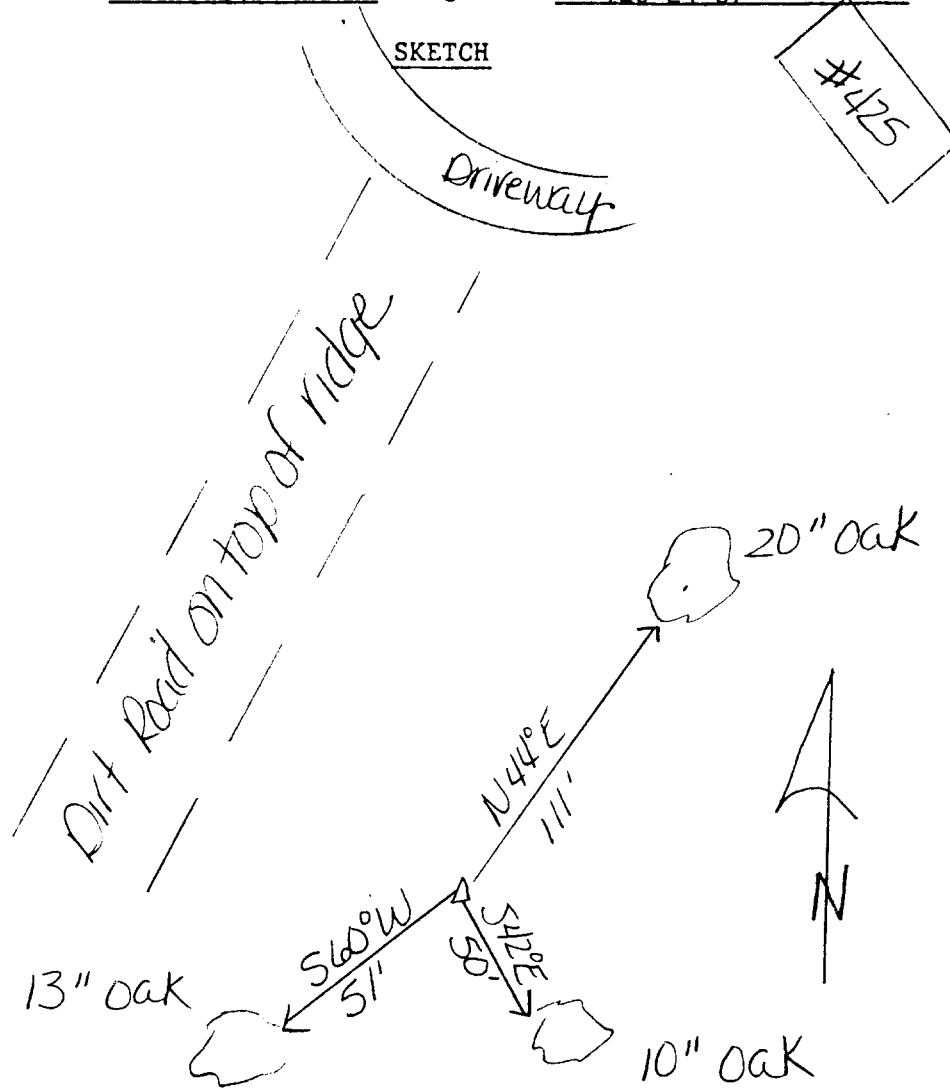

Reference Marks: