



Station: RSBG 60 T 26 S, R 6 W, Sec 35

Set By (Agency): CITY(RSBG)

Date Set: 1/89

Recovered By _____

Date Recovered _____

Recovered By _____

Date Recovered _____

Recovered By _____

Date Recovered _____

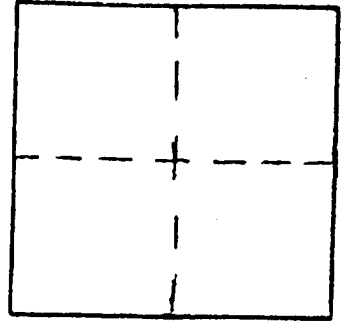

VERTICAL CONTROL

Elevation: 1225.2 NGS Line # _____ USGS Line # _____ OSHD Line # _____

Precision: VA Agency: _____ Proj. # _____ Date: _____

HORIZONTAL CONTROL

South Zone State Plane Coordinates: Y(Northing) 593,437.31 X(Easting) 1,236,368.60

Precision: 1/20,000 Agency: CITY(RSBG) Proj. # _____ Date: _____

Approximate Geographic Position: Latitude 43°15'33" Longitude 123°22'02"

DESCRIPTION and TO REACH

Alum. cap stamped "RSBG 60" on 2" alum. pipe set flush in concrete.

TO REACH:

Go up Kline Street and Moorea Road, about 0.85 miles past water tank on Moorea Road to intersection of dirt road on left side.

SKETCH

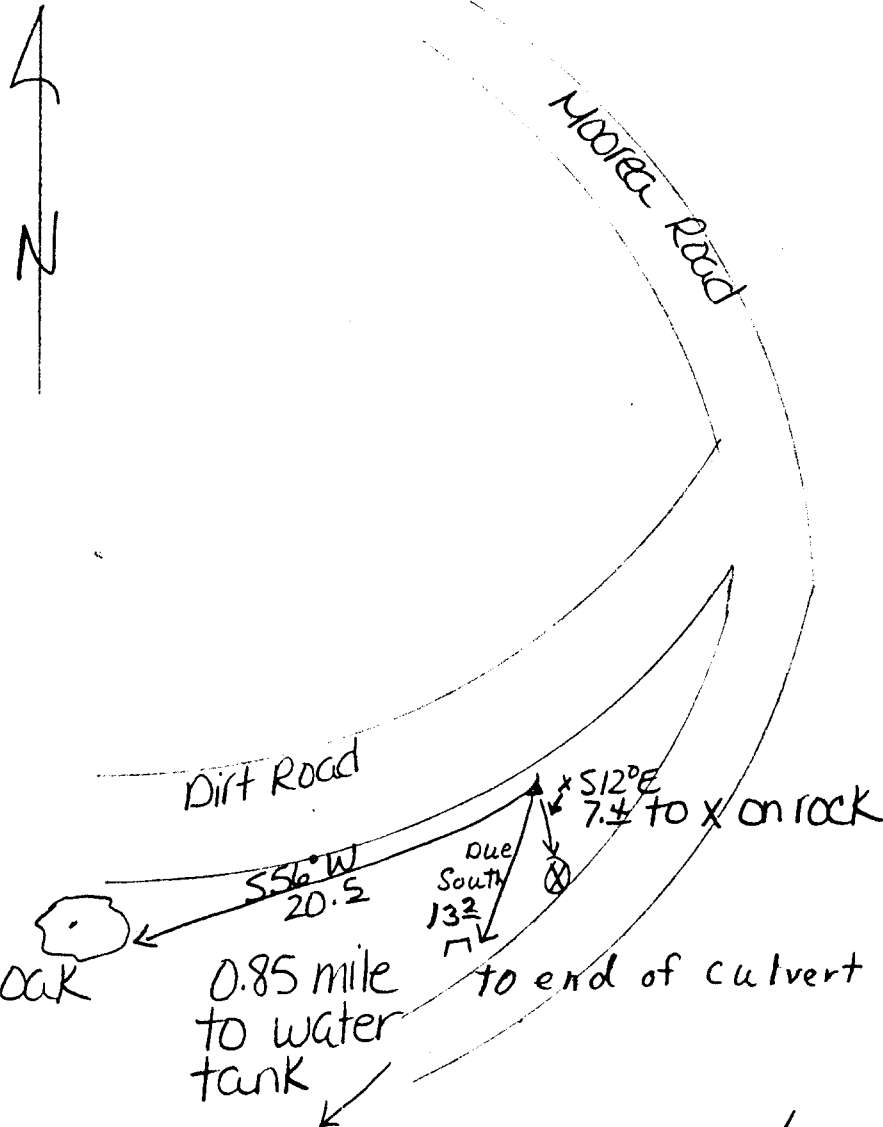

Reference Marks: