

PROPERTY SURVEY ALONG THE WEST BOUNDARY OF SECTION 27, LOCATED IN THE N. 1/2 OF SECTION 27, T. 27 S., R. 7 W., W.M., DOUGLAS COUNTY, OREGON

FOR: PAUL D. KAUZLARICH
677 SUNRISE LN.
ROSEBURG, OR. 97470

DATE: APRIL 1993

SCALE: 1" = 500'

BY: ROBERT L. DOLAN
3614 NONPARIEL RD.
SUTHERLIN, OR. 97479

Legend: ● FD. BRASS CAP AS NOTED

● SET 5/8" x 30" IRON ROD W/CAP LS
/076

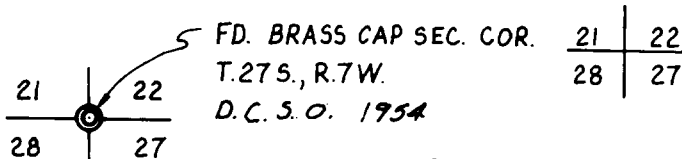

NARRATIVE: SURVEY TO MONUMENT N 1/16 CORNER COMMON TO SECTION 27 & 28. COMPUTED FROM FOUND MONUMENTS.

INSTRUMENTS:
NIKON D.T.M. - A10 L.G.
TOTAL STATION

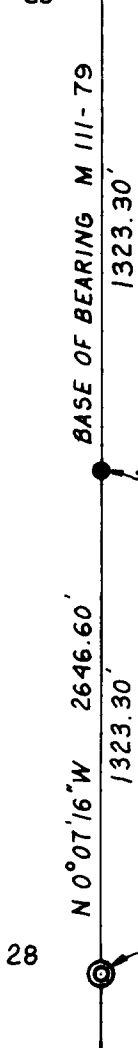

A 7" DOUGLAS FIR BEARS N 58° 47' 39" E 36.95'
SCRIBED B.T. N 1/16 SEC. 27

N 1/16 SECTION 28 & 27

A 10" MADRONE BEARS N 56° 19' 06" W 56.56'
SCRIBED B.T. N 1/16 SEC. 28

**COUNTY SURVEYORS FILE DATA
DO NOT REMOVE FROM OFFICE**

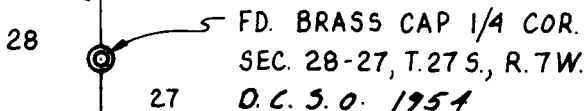

REGISTERED
PROFESSIONAL
LAND SURVEYOR

Robert L. Dolan

OREGON EXP. 12-93
July 30, 1976
ROBERT L. DOLAN
1076

