

M108-12

FILED

jh

MAY 31 1989

OREGON CORNER RESTORATION FORM

Section 20 Township 21S Range 4W

County Douglas Date 01-04-89

COUNTY SURVEYOR
DOUGLAS COUNTY, ORE.

CORNER DESIGNATION

North N.W. Corner
Samuel Hall D.L.C.

- Condition Report Only
- Not Found
- Renewed
- Unrecorded
- Surveyed In
- Referenced Out

Previous Renewals/Surveys, etc. Corner Renewal by Vernon Tracy in 1969. See C.S. File 54/14

Monument(s) & Accessories Found: (Condition and Source)

Found 1968 Douglas County Brass Cap at East-West-South fence corner. Also found 1" iron pipe beside brass cap.
20" Incense Cedar, S64W, 29.5' (Scar Vis.), 1968 BT. Rec. S64W 29.0'

Monument Detail

Sketch

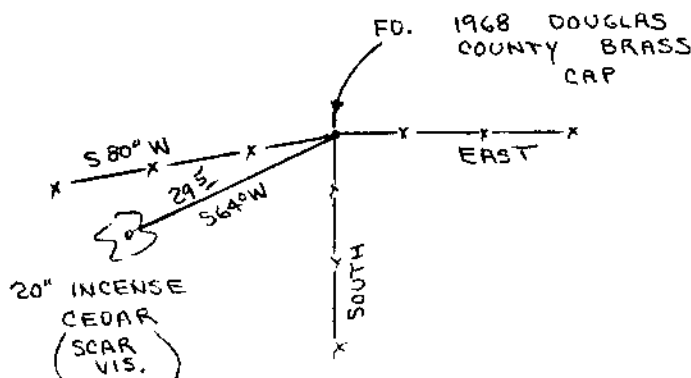

Monument Set (Procedures and Description)

New Accessories

None

Location & Comments

Surveyor's Seal

Corner lies on East slope and on the South edge of a X-mas tree plantation Compass Declination 20 1/2
Firm/Agency Roberts Surveying Inc.
Address 29 West 29th St. Eugene, Oregon 97405
Party Chief Les Roberts
Notes Ted Baker
Witness Norman Hamar



C.S. File No. 63/85-22