

M108-12

FILED

MAY 31 1989

OREGON CORNER RESTORATION FORM

Section 19 Township 21S Range 4W

COUNTY SURVEYOR  
DOUGLAS COUNTY, ORE.

County Douglas Date 01-03-89

CORNER DESIGNATION

S.E. Corner  
Section 19

- Condition Report Only
- Not Found
- Renewed
- Unrecorded
- Surveyed In
- Referenced Out

Previous Renewals/Surveys, etc. Survey RM-2-17 by Bruce Shaner filed 02-16-62. Survey M43-28 by Victor McLind filed 08-12-71. Survey M96-40 by Robert Dean in 1984.

Monument(s) & Accessories Found: (Condition and Source)

Could not find the R.R. Spike set by Robert Dean in C.S. M90-40. #131  
Found the 3/4" x 43" iron rebar Robert Dean set in place of Bruce Shaner's 1 1/4" iron pipe. I set a rock nail in the asphalt, South, 42.00 feet, from said 3/4" iron rebar and used said nail for the S.E. corner of Section 19. My basis of bearing is from Bruce Shaner's survey RM-2-17. I found a 33" fir stump, S60W, 32.82' from rock nail. Distance is to hub tack in the bark. BARK.

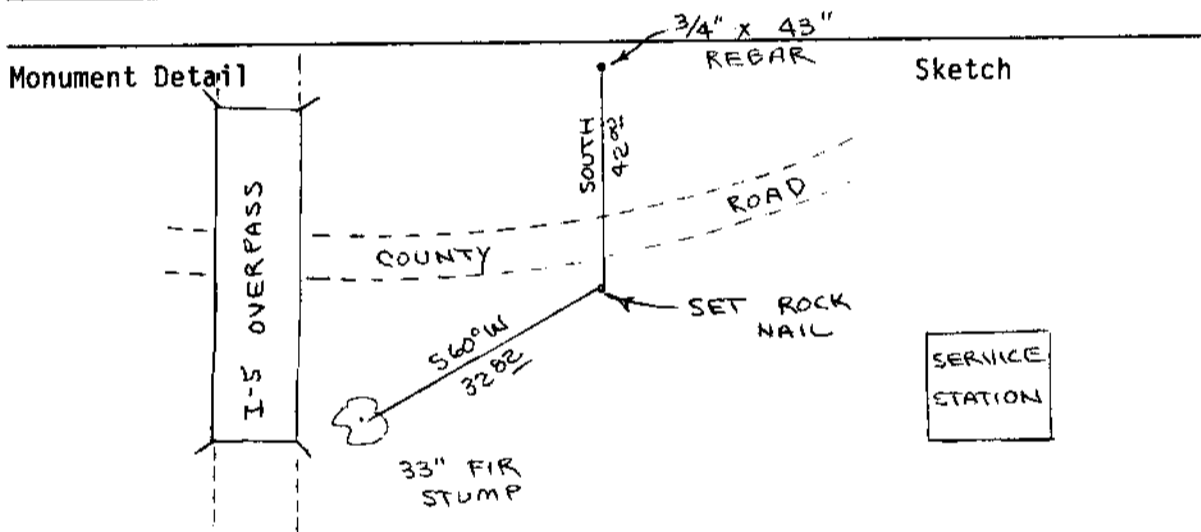

Monument Set (Procedures and Description)

\_\_\_\_\_  
\_\_\_\_\_  
\_\_\_\_\_  
\_\_\_\_\_

New Accessories

None

\_\_\_\_\_  
\_\_\_\_\_  
\_\_\_\_\_

Location & Comments

This corner lies about Compass Declination 20 1/2  
250' East of Freeway Firm/Agency Roberts  
and on South side of Surveying Inc.  
County Road. Address 29 West 29th St.  
Eugene, Oregon 97405  
Party Chief Les Roberts  
Notes Ted Baker  
Witness Norman Hamar

Surveyor's Seal



C.S. File No. 63/85-200

#148+