

FILED

2/r
MAY 31 1989

OREGON CORNER RESTORATION FORM
Section 18 Township 20S Range 8W
County Douglas Date 05-05-89

COUNTY SURVEYOR
DOUGLAS COUNTY, ORE.

CORNER DESIGNATION

North $\frac{1}{4}$ Corner
Section 18



- Condition Report Only
- Not Found
- Renewed
- Unrecorded
- Surveyed In
- Referenced Out

Previous Renewals/Surveys, etc. G.L.O. Survey by W.P. Wright in 1883 and G.L.O. Survey by Thomas Tillman in 1954. Also C.S. M 103-36 By Roberts Surveying dated December 30, 1986.

Monument(s) & Accessories Found: (Condition and Source)

Found 1954 G.L.O. Brass Cap laying on cut-bank of new dirt logging road. Both 1954 hemlock B.T.'s have been destroyed.

Monument Detail

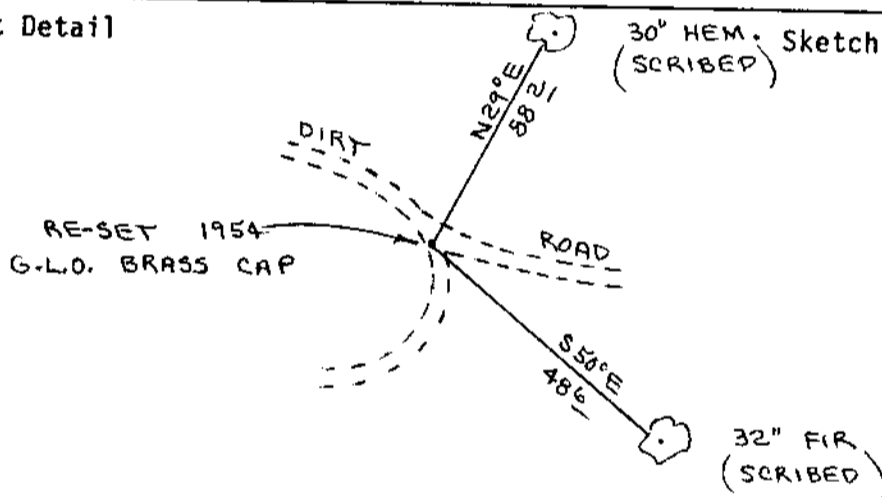

Monument Set (Procedures and Description)

Re-set 1954 G.L.O. Brass Cap from M 103-36 traverse points. Brass Cap buried 6" below surface of dirt road. Buried purple magnetic marker under pipe.

New Accessories

30" Hemlock, N29E, 88.2' (Scribed/Painted Red)
32" Fir, S50E, 48.6' (Scribed/Painted Red)
Distances are measured to 6" spike driven into center of tree.

Location & Comments

Compass Declination 20 $\frac{1}{2}$
Firm/Agency Roberts Surveying Inc.
Address 29 West 29th Street, Eugene, Oregon
Party Chief Ted Baker
Notes Ted Baker
Witness Norman Hamar

Surveyor's Seal

REGISTERED
PROFESSIONAL
LAND SURVEYOR

Lee Roberts

OREGON
AUGUST 22 1976
L. D. ROBERTS
1039

C.S. File No. 63/85-14 C

20 X