

FILED

JK

JUN 20 1988

OREGON CORNER RESTORATION FORM

Section 18 Township 19S Range 8W

County DOUGLAS Date 5/13/88

COUNTY SURVEYOR
DOUGLAS COUNTY, ORE.

Corner Designation

NORTHEAST SECTION CORNER

- Condition Report Only
- Not Found
- Renewed
- Unrecorded
- Surveyed In
- Referenced Out

Previous Renewals/Surveys, etc.

1974 BLM Admin. Survey - M57-31

Monument(s) & Accessories Found: (Condition and Source)

FND. 3/4" REBAR - M57-31

13" FIR, N67°E, 17' - CLOSED FACE

23" FIR, S36 1/2°E, 17' - CLOSED FACE

14" FIR, S73 1/2°W, 9' - CLOSED FACE

16" FIR, N68 1/2°W, 26.9' - CLOSED FACE

M57-31

Monument Detail

20" FIR
SCRIBED
T195 R8W S7
BT
(NEW BT)

Sketch

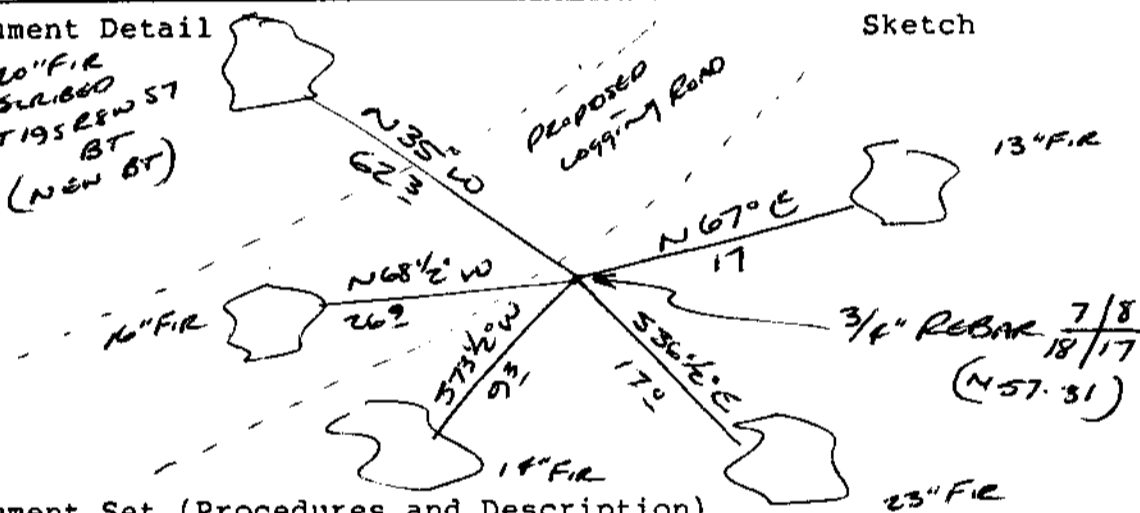

Monument Set (Procedures and Description)

New Accessories

20" FIR, N35°W, 62.3' - SCRIBED T195 R8W, S7 BT

RAILROAD SPIKE IN 16" FIR STUMP, N83°E, 27.1'

RAILROAD SPIKE IN 10" FIR STUMP, S19°E, 26.73'

Location & Comments

CORNER FALLS ON SOUTHERLY R/W OF A PROPOSED LOGGING ROAD AND A NEW BT WAS SET TO REDUCE THE BT IN THE ROAD. THIS CORNER WAS ALSO REFERENCED WITH RR SPIKES IN STUMPS

Compass Declination 20°
 Firm/Agency PEEL BAKER LAND SURVEYING INC.
 Address 1262 LAWRENCE EMEUS, ORE 97401
 Party Chief DAN BAKER
 Notes _____
 Witness _____

Surveyor's Seal

