

CERTIFIED RECORD OF LAND CORNER MONUMENTATION

History of original corner establishment:

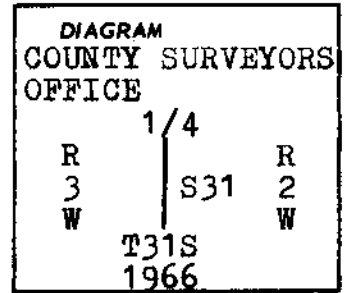

FILED *JH*
 MAY 5 1988
 COUNTY SURVEYOR
 DOUGLAS COUNTY, ORE.

Description of corner evidence found:

Found 1" galv. iron pipe with 2 1/2" brass cap extended 9" above ground and marked as shown in diagram. Also found 1" iron pipe to the Southwest and alongside brass cap.

A 14" D. Fir snag bears N76°29'E, 21.5 feet (healed blaze).
A 19" Hemlock bears S49°41'E, 7.2 feet. (healed blaze)

Description of monument and accessories I established to perpetuate the original location of this corner

New Bearing Tree:

A 20" W. Fir bears N43°E, 11.9 feet, scribed "T31S R2W S31 1/4 BT", doubled blaze, set 1/2" brass washer in lower blaze.

I hereby certify the above corner was perpetuated as hereon described on April 21, 1988. Bearing tree signs and monument signs were placed on all bearing trees without them and a 6" red band and face blazes were painted on all bearing trees.

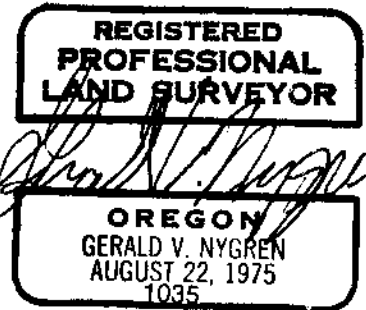

Office of Surveyor County of Douglas
 State of Oregon , I hereby certify that the within instrument was filed in this office
 for record on the 5 day of May 1988 at o'clock m. (signed)
 Fritz Ingram by *Magdalena P. Ingram*
 (COUNTY OFFICIAL) (DEPUTY)

Form R6-7100-57 (9/66)

#229 T.31-2 X
#256 T.31-3 X

C.S. File No. 63/69-23
C