

M 105-50

REGISTERED  
PROFESSIONAL  
LAND SURVEYOR



FILED

FEB 9 1988

COUNTY SURVEYOR  
DOUGLAS COUNTY, ORE.

OREGON  
JULY 13, 1979  
ROBERT G. DEAN  
1808

SURVEY NARRATIVE

Survey for Boundary Line Agreement & Lot Line Adjustment  
for the Comstock Cemetery Association  
(see map)

Location: NE 1/4 Sec. 20 T.21 S., R.4 W., W.M., Douglas County, Oregon.

Date of Survey: January 24, 1988.

Basis of Bearings: Solar observations using the hour angle method.

Purpose: To describe the locations of existing cemetery fences for conveyances to establish boundary lines and also to describe additional land to be added to the cemetery through lot line adjustment procedures.

Procedure: Topcon DMC2 EDM and Topcon TL50E theodolite were used to run control traverses, as follows:

- 1) Primary traverse from I-5 Lawrence house to section corner, along Weyerhaeuser road, and return, 6 repetitions per angle (closure 1:60,000 before compass rule adjustment).
- 2) Secondary traverse around perimeter of subject parcel, 2 repetitions per angle (closure 1:17,000 before compass rule adjustment).

History:

- March 1915 -- Original Comstock Cemetery deed Vol. 120 Page 293.
- August 1953 -- Final Judgment CC-14662 establishing the right-of-way lines of I-5, per O.S.H.D. survey shown in DRG #7B-7-8. (Note the discrepancy between these two documents in their designations of the easterly right-of-way line as it runs from station 183+50 to station 187+50).
- June 1965 -- Addition to Comstock Cemetery per deed #65-1924.
- June 1978 -- O.S.H.D. acquisition of additional right-of-way per O.S.H.D. survey shown in DRG #9B-14-23, by deed #78-11903.

Findings: The monuments of O.S.H.D. DRG #7B-7-8 at stations 180+00 and 183+50 were found. Distance/distance intersection calculates the radius point of the  $\frac{1}{4}$  curve S.39\*-03'-30" E. 2999.04 feet from the 3/4" iron rod 275 feet left of 183+50. The calculated point 140 feet left of 187+50 is then N.46\*-03'-30" W. 3134.04 feet from the radius point by the combination of record radius and arc length.

76841 HOOTON'S CORNER • COTTAGE GROVE, OR 97424

C.S. FILE NO. 63/67-1

M 105-50

FILED

✓/L

OREGON CORNER RESTORATION FORM

FEB 9 1988

Section 17/16 Township 21S Range 4W

County 20/21 Douglas Date Jan. 24, 1988

COUNTY SURVEYOR  
DOUGLAS COUNTY, ORE.

Corner Designation

17 | 16  
20 | 21

- Condition Report Only
- Not Found
- Renewed
- Unrecorded
- Surveyed In
- Referenced Out

Previous Renewals/Surveys, etc. 1854 GLO, by Harvey Gordon,  
1953 CS4/183 by Chas. C. Bayles, 1964 Reest. # 86 by Milo Godfrey,  
1972 BLM by Peter Peterson, 1987 M104-12 by Donald Peel.

Monument(s) & Accessories Found: (Condition and Source)

Found 1" galv. iron pipe with 2 1/2" brass cap per Reest. # 86 from which:  
49" DF, healed scar, bears N31°15'E 58.2' (record N31°E 59.0' per Reest #86),  
46" sawed DF stump, "S" visible, bears S14°00'E 20.3' (record S15°E 19.8' per GLO.);  
16" sawed DF stump, face visible, bears S6°37'E 60.4' (record S8°E 60.5' per Reest #86);  
10" DF, healed scar, bears S42°10'W 25.5' (record S43 1/4°W 25.7' per Reest #86);  
23" DF, healed scar, bears N54°10'W 45.5' (record N55°W 45.5' per Reest #86).

Monument Detail

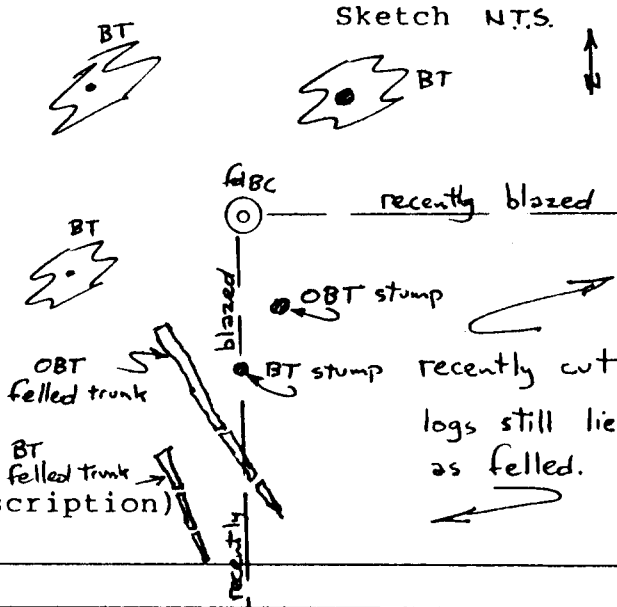
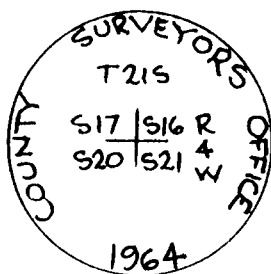

Monument Set (Procedures and Description)

None

New Accessories

None

Location & Comments

Bearings are turned from Compass Declination ± 19°E  
traverse with theodolite Firm/Agency Cottage Grove  
on solar basis. Land Surveying, Robert G. Dean  
Dists. are horiz. to Address 76841 Hooton's Cor.  
center of root crown. Cottage Grove, OR.  
See survey for Comstock Party Chief R. Dean,  
Cemetery Assoc. in NE 1/4 Notes Comstock Cemetery  
Sec. 20, T. 21S. R. 4W. Witness C. Booher

Surveyor's Seal

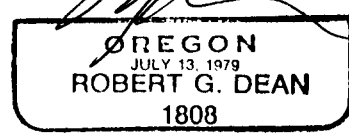
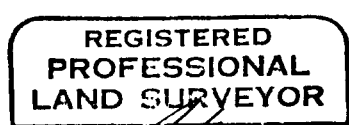

C.S. File No. 63/67-1