

M 105-24

FILED

JK

DEC 16 1987

OREGON CORNER RESTORATION FORM

Section 3 Township 235 Range 5W

COUNTY SURVEYOR
DOUGLAS COUNTY, ORE.

County Douglas Date 10/20/87

Corner Designation

NW Cor. D.L.C. #42

- Condition Report Only
- Not Found
- Renewed
- Unrecorded
- Surveyed In
- Referenced Out

Previous Renewals/Surveys, etc. See Renewal 116

Monument(s) & Accessories Found: (Condition and Source)

Found rod with "Baughman Technical Serv." plastic cap. Noted that monument noted on Baughman Survey (M92-69A, CS File 58/440) and renewal notes set at "S.E. corner of formerly Elmer Daugherty property" is not in evidence. New fence post has been set where reference pin was.

Monument Detail

Sketch

Monument Set (Procedures and Description)

New Accessories

Location & Comments

Surveyor's Seal

Compass Declination _____
 Firm/Agency Stephen H. Ford, Inc.
 Address 120 Bailey Hill Rd
Eugene, Oregon
 Party Chief Curt Liesentfelt
 Notes _____
 Witness R. Deckendorf

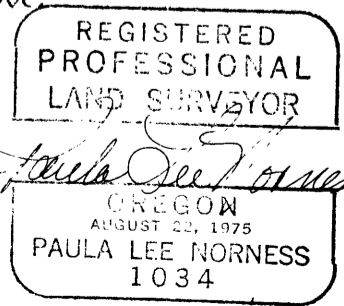

C.S. File No. 63/6-A

M 115-27

FILED

DEC 16 1987

OREGON CORNER RESTORATION FORM

Section 3 Township 23S Range 5W

COUNTY SURVEYOR
DOUGLAS COUNTY, ORE.

County Douglas Date 10/20/87

Corner Designation

NE corner D.L.C. #42

- Condition Report Only
- Not Found
- Renewed
- Unrecorded
- Surveyed In
- Referenced Out

Previous Renewals/Surveys, etc. See Renewal #114

Monument(s) & Accessories Found: (Condition and Source)

Found standard brass cap properly marked
in barn yard as noted in renewed corner
record #114. Tied in process of survey
for Four Slide Products, Inc. Could not occupy
and tie accessories as property owner (Hilmer
849-2593) would allow only limited access to
monument (indicated hogs would catch diseases
from surveyor). Monument in good condition.

Monument Detail

Sketch

Monument Set (Procedures and Description)

New Accessories

Location & Comments

Surveyor's Seal

Compass Declination _____

Firm/Agency STEPHEN H. FORD, INC.

Address 1120 Bailey Hill Rd.

Eugene, Or. 97402

Party Chief C. Liesantfelt

Notes _____

Witness R. Dockendorf

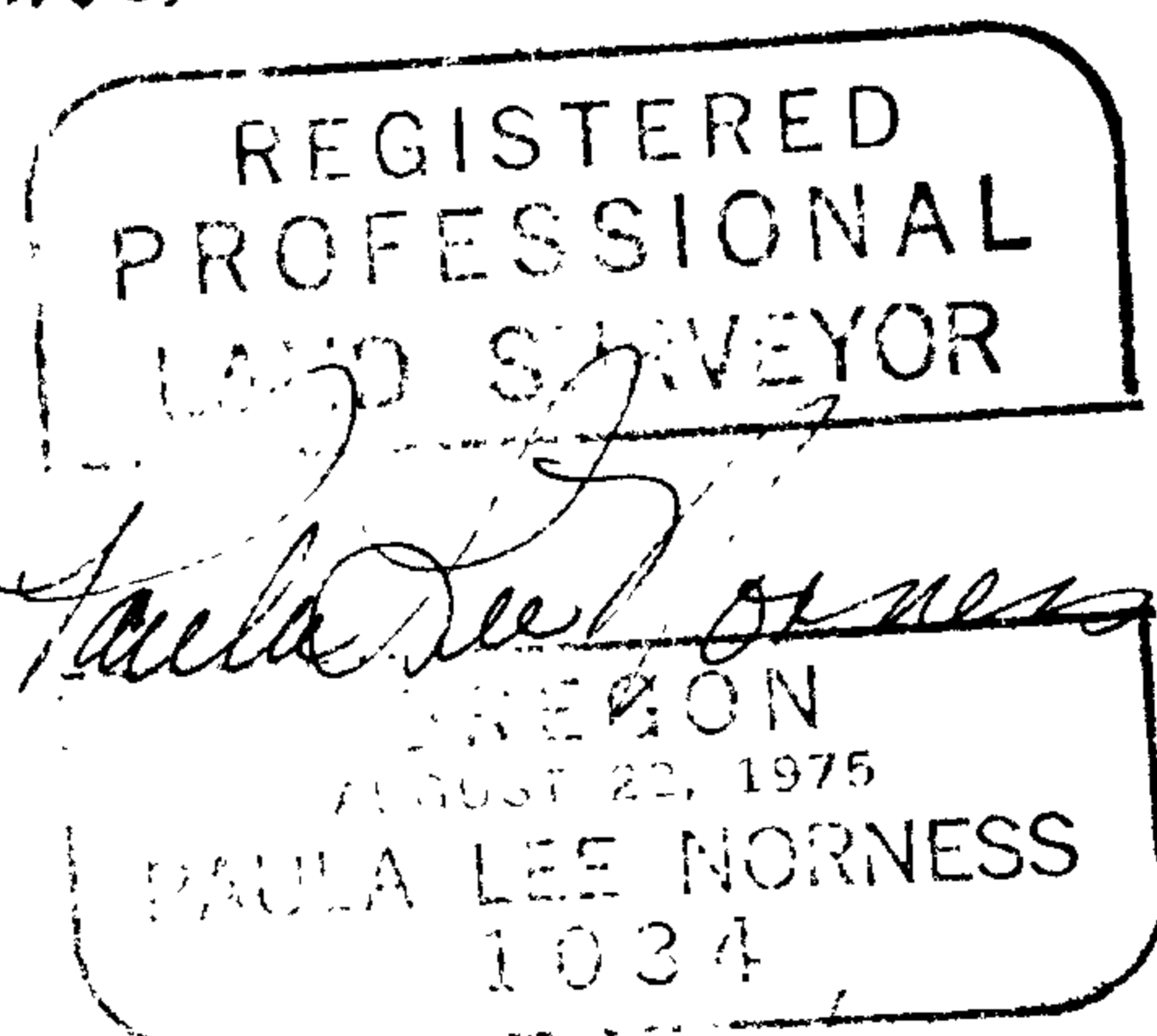

C.S. File No. 63/66-B

✓

14105-24

FILED

ff

DEC 16 1987

OREGON CORNER RESTORATION FORM

Section 4 Township 235 Range 5W

County Douglas Date 10/27/87

COUNTY SURVEYOR
DOUGLAS COUNTY, ORE.

Corner Designation

NW cor. D.L.C. #40

- Condition Report Only
- Not Found
- Renewed
- Unrecorded
- Surveyed In
- Referenced Out

Previous Renewals/Surveys, etc. Last visitation of record: Amended Plat of Devore's Addition to Yencalla (Vol. 3, page 38)
However erroneously referred to as D.L.C. No. 48

^{NOTE #3} Monument(s) & Accessories Found: ~~(Condition and Source)~~

see survey by this firm for Four Slide Products, Inc.
Projected search location from monuments reportedly set for lot corners in said plat. Also as referred to in Town of Yencalla (Vol. 2, pg. 17) Absolutely no evidence recovered in either location. Interviewed Vernon Whitaker (owner since 1969) who indicated this had been the site of a "prune orchard & dryer". Found evidence to support this. Assume after much digging, that stone and accessories have been

Monument Detail

Sketch

gone for quite some time. Used projected location from ".... Devore's Addition." to determine direction of the north line of the D.L.C. which is south line County Road #63 (Hole Trail Road) but didn't set monument.

Assumed monument removed during site preparation for prune orchard.

Monument Set (Procedures and Description)

New Accessories

Location & Comments

Surveyor's Seal

Compass Declination _____
 Firm/Agency Stephan A. Ford, Inc.
 Address 120 Bailey Hill Rd.
Eugene, Oregon 97402
 Party Chief C. Liesantfelt
 Notes _____
 Witness R. Dockendorf

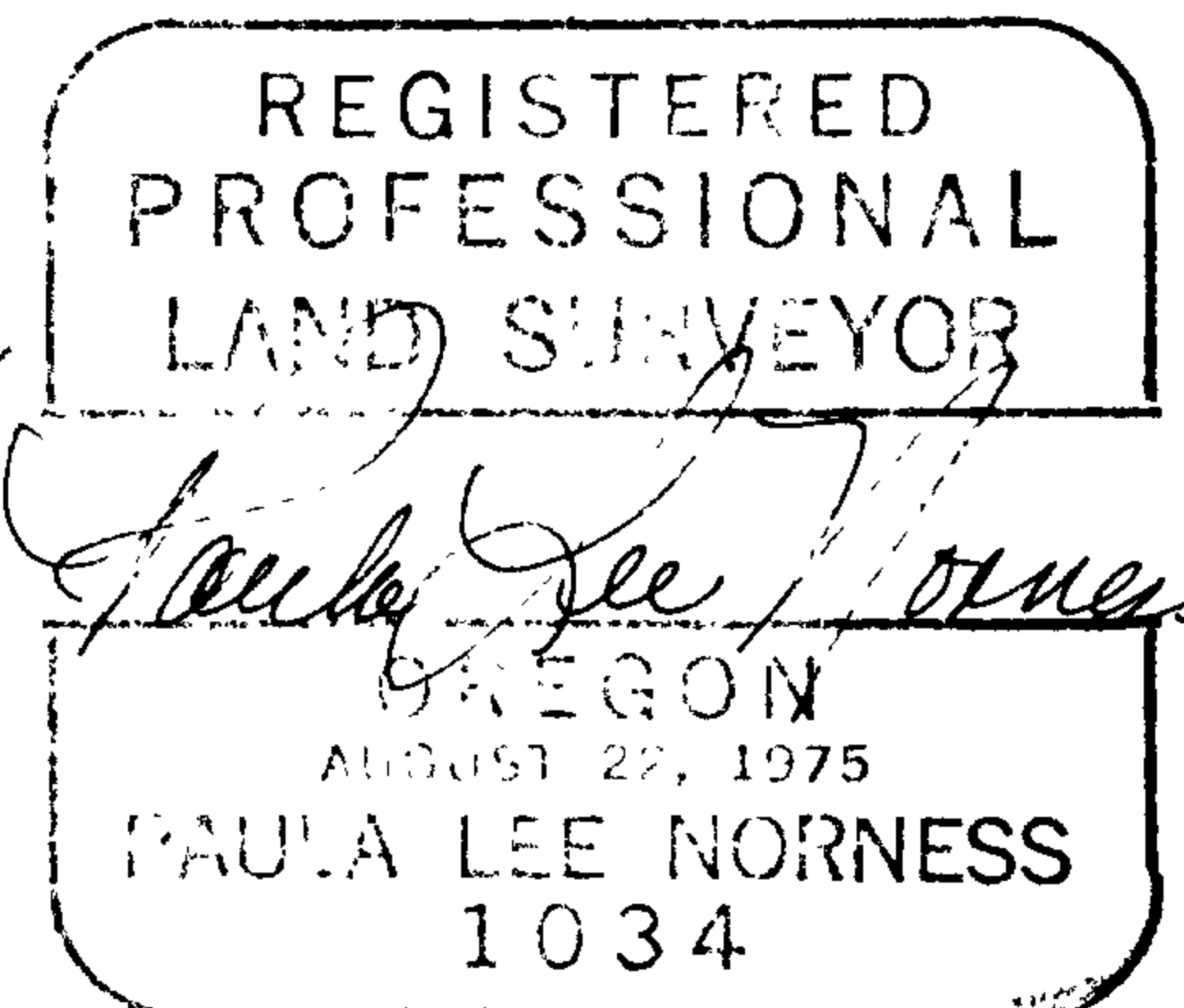

C.S. File No. 63/66c

X

M 105-24

FILED

YR

DEC 16 1987

OREGON CORNER RESTORATION FORM

Section 4 Township 235 Range 5W

County Douglas Date 10/27/87

COUNTY SURVEYOR
DOUGLAS COUNTY, ORE.

Corner Designation

NW Cor. D.L.C. 40

- Condition Report Only
- Not Found
- Renewed
- Unrecorded
- Surveyed In
- Referenced Out

Previous Renewals/Surveys, etc. Last visitation of record
Amended Plat of Devore's Addition to Yoncalla (vol. 3,
page 38)

Monument(s) & Accessories Found: (Condition and Source)

Monument Detail

Sketch

Monument Set (Procedures and Description)

New Accessories

Location & Comments

Surveyor's Seal

See Survey by this firm Compass Declination _____
for Four Slide Products, Inc. Firm/Agency _____
Projected search location Address _____
from monuments reported Party Chief _____
edly set for Lot Corners Notes _____
in said plat. Also as Witness _____
referred to in Town of _____
Yoncalla plat (vol. 2, pg. _____
17?). Absolutely no evidence recovered. Discussion with
property owner there (Verion Whitaker) ~~was~~ indicated
this to have been the location of a "prune drier"

C.S. File No. 637/66

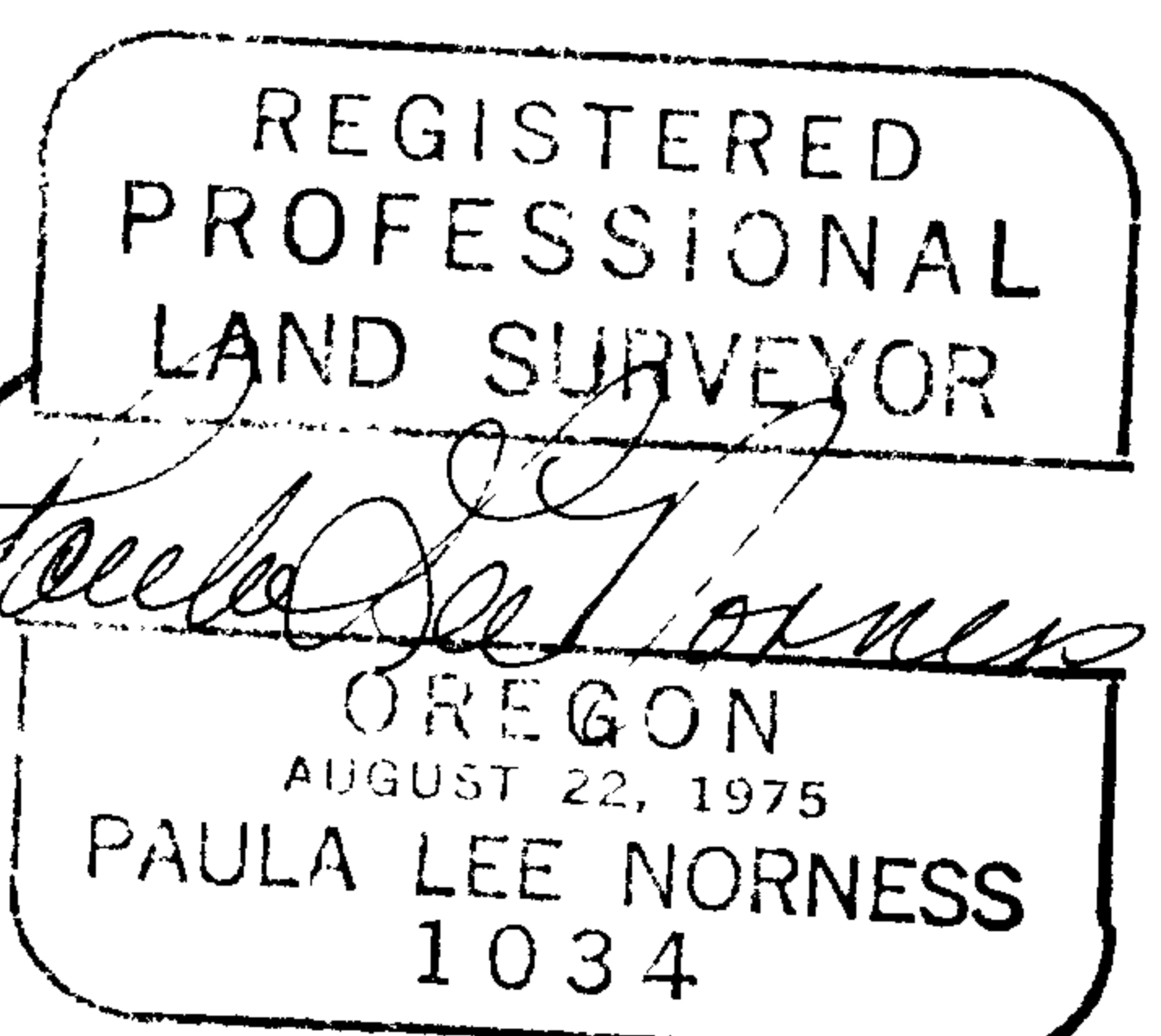

over:

Found evidence to support this. Additionally he indicated a dam previously upstream on the creek nearby had caused depositing of loam in this area, and considerable disturbance of ground. Dug large hole at location arrived at from "...Devore's Addition" but found no monument. Line from here to NW cor. D.L.C. #42 (NE Cor D.L.C. #40) fits original notes well. Did not remonument.

If monument were in, its recovery would necessitate excavation with a back hoe, not available at this time. ~~It~~ I feel monument probably was destroyed in construction of prune

M105-24

FILED

DEC 16 1987

OREGON CORNER RESTORATION FORM

Section 4 Township 235 Range 5W

County Douglas Date 10/27/87

COUNTY SURVEYOR
DOUGLAS COUNTY, ORE.

Corner Designation

SW Cor. D.L.C. 48

- Condition Report Only
- Not Found
- Renewed
- Unrecorded
- Surveyed In
- Referenced Out

Previous Renewals/Surveys, etc. Last visitation: shown on Amended Plat of Devore's Addition to Yoncalla (vol. 3, page 38) but distance to NW Cor. D.L.C. # 40 not shown.

Monument(s) & Accessories Found: (Condition and Source)

Monument Detail

Sketch

Monument Set (Procedures and Description)

New Accessories

Location & Comments

Developed search tie for NW Cor. D.L.C. #40 and looked for this corner 1.79 chs. east of that location. Assumed to have been removed in site preparation of prune orchard.

Compass Declination _____
 Firm/Agency Stephen H. Ford, Inc.
 Address 1120 Bailey Hill Rd #5 Eugene, Oregon 97402
 Party Chief C. Kiesenfelt
 Notes _____
 Witness R. Dockendorf

Surveyor's Seal



C.S. File No. 63/66E