

FILED *JS*

APR 8 1988

OREGON CORNER RESTORATION FORM

Section 12 Township 28S Range 4W

COUNTY SURVEYOR
DOUGLAS COUNTY, ORE.

County DOUGLAS Date 4-7-88 (visited 3-28-88)

Corner Designation

N.W. Sec. - Cor.

- Condition Report Only
- Not Found
- Renewed
- Unrecorded
- Surveyed In
- Referenced Out

Previous Renewals/Surveys, etc. Co. Surveyor set BCIP from original N.W. Pt. in 1957.

Monument(s) & Accessories Found: (Condition and Source)

- 36" ORIGINAL CEDAR BEARS N 57° W, 23.1' SCRIBING VISIBLE IN OPEN FACE
- 14" FIR BEARS N 47° E, 9.7' CLOSED FACE (1957)
- 18" FIR BEARS WEST, 5.2' " " "
- 26" FIR BEARS S 71° E, 30.0' " " "

Monument Detail

2 1/2" BRASS CAP SET ON A
1" IRON PIPE, EXTENDING
15" ABOVE GROUND.

Sketch
Co. Surveyor
T28S R4W

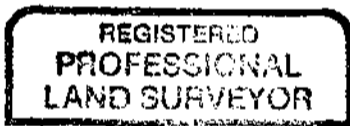
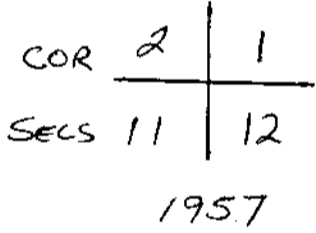

Ronald G. Geisler

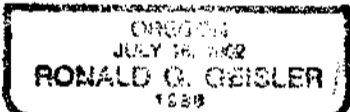

Monument Set (Procedures and Description)

New Accessories

Location & Comments

1974 BLM P/L METAL TAGS Compass Declination 20° E
ALONG W. LINE SEC. 12. Firm/Agency CHAMPION
BLUE & ORANGE FLAGGING INTL. CORP.
RUN EAST FROM COR. Address P.O. Box 1328
ALONG N. LINE SEC. 12 ROSEBURG, OR. 97470
 Party Chief R. GEISLER
COR. ON SPUR RIDGE BETWEEN Notes R. HANSON
2 DRAWS. Witness _____

Surveyor's Seal

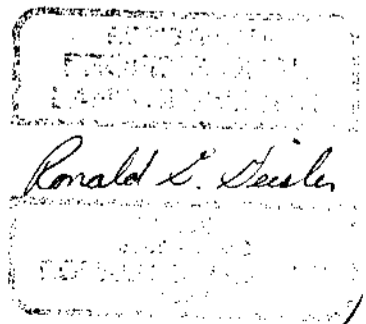

C.S. File No. 63/60-1