

M 105-29

FILED

JH

DEC 29 1987

OREGON CORNER RESTORATION FORM

Section 10 Township 22S Range 12W

County Douglas Date 7-15-87

COUNTY SURVEYOR
DOUGLAS COUNTY, ORE.

CORNER DESIGNATION

South $\frac{1}{4}$ Corner
Section 10

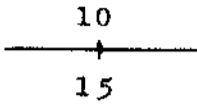

- Condition Report Only
- Not Found
- Renewed
- Unrecorded
- Surveyed In
- Referenced Out

Previous Renewals/Surveys, etc. Original G.L.O. Survey by William Thiel in 1889. Survey M92-57 by Robert Ward in 1982 and Survey RM3-59 by Bruce Shaner in 1982.

Monument(s) & Accessories Found: (Condition and Source)

Found 1982 Brass Cap and 2 1/2" iron pipe set in C.S. M92-57.
12" Alder, N68W, 11.0' (Bark Scribed), 1982 B.T. Rec. N68W, 11.2'
14" Alder, S16W, 5.4' (Bark Scribed), 1982 B.T. Rec. S16W, 5.5'

Monument Detail

Sketch

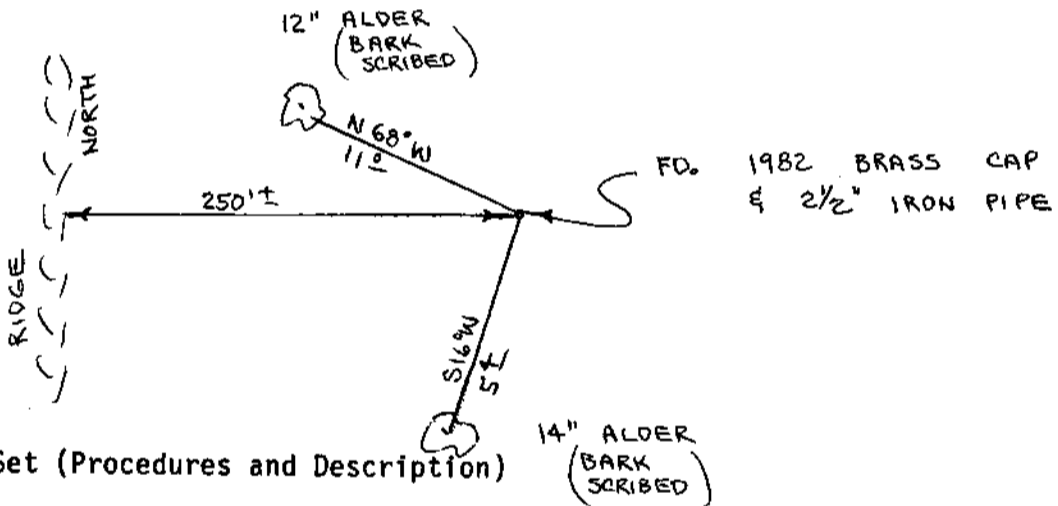

Monument Set (Procedures and Description)

New Accessories

Painted all B.T.'s red.

Location & Comments

Corner lies on a N.E. slope about 250' East of a North-South ridge. Compass Declination 20 1/2
Firm/Agency Roberts
Surveying Inc.

Address 29 west 29th St.
Eugene, Oregon 97405

Party Chief Ted Baker

Notes

Witness Jim Metzler

Surveyor's Seal



C.S. File No. 63/55-11