

FILED

*RL*

DEC 21 1987

OREGON CORNER RESTORATION FORM

Section 9 Township 21S Range 9W

County Douglas Date 11-26-86

COUNTY SURVEYOR  
DOUGLAS COUNTY, ORE.

CORNER DESIGNATION

Center  $\frac{1}{4}$  Corner  
Section 9

- Condition Report Only
- Not Found
- Renewed
- Unrecorded
- Surveyed In
- Referenced Out

Previous Renewals/Surveys, etc. See survey by Roberts Surveying Inc. dated November 30, 1981. Map #M90-13. Also see corner restoration form by Roberts Surveying dated 04-17-86

Monument(s) & Accessories Found: (Condition and Source)

1 1/2" x 36" iron pipe set in C.S. #M90-13 has been up-rooted by recent logging activity.

18" Fir Stump, N10E, 8.7' (scribe vis.), 1981 BT. Rec. N10E, 8.7'

20" Fir, S79W, 38.4' (Scribe vis.), 1981 BT. Rec. S79W, 38.4'

Monument Detail

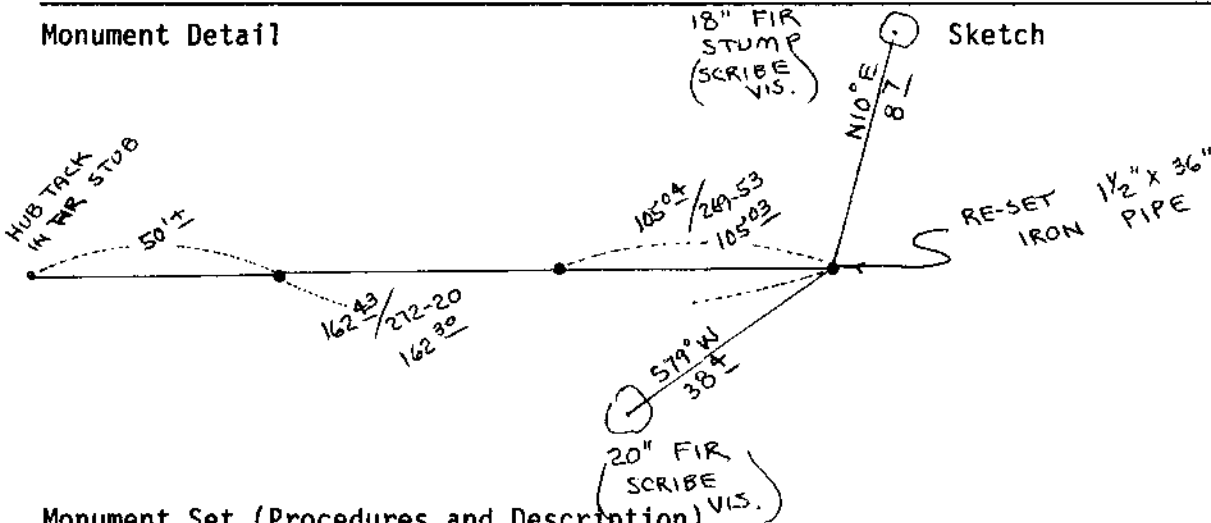

Monument Set (Procedures and Description)

Re-set 1 1/2" x 36" iron pipe by using R.P. hubs set on 04-17-86. Buried purple magnetic marker under 36" iron pipe. Set metal fence post, with survey attention sign attached to, beside iron pipe. Painted B.T.'s red.

New Accessories

Location & Comments

Surveyor's Seal

Compass Declination 20 1/2  
 Firm/Agency Roberts Surveying Inc.  
 Address 29 West 29th St. Eugene, Oregon 97405  
 Party Chief Ted Baker  
 Notes \_\_\_\_\_  
 Witness Jim Metzler



C.S. File No. 63/52-29

#514