

FILED

LL

DEC 21 1987

OREGON CORNER RESTORATION FORM

Section 9 Township 21S Range 9W

County Douglas Date 04-17-86

COUNTY SURVEYOR
DOUGLAS COUNTY, ORE.

CORNER DESIGNATION

Center $\frac{1}{4}$ Corner
Section 9

- Condition Report Only
- Not Found
- Renewed
- Unrecorded
- Surveyed In
- Referenced Out

Previous Renewals/Surveys, etc. See survey by Roberts Surveying Inc. dated November 30, 1981, Map M90-13

Monument(s) & Accessories Found: (Condition and Source)

Found $1\frac{1}{2}$ " x 36" iron pipe set in C.S. M90-13

18" Fir, N10E, 8.7' (Scribe Vis.), 1981 BT. Record N10E, 8.7'

20" Fir, S79W, 38.4' (Scribe Vis.), 1981 BT. Record S79W, 38.4'

Monument Detail

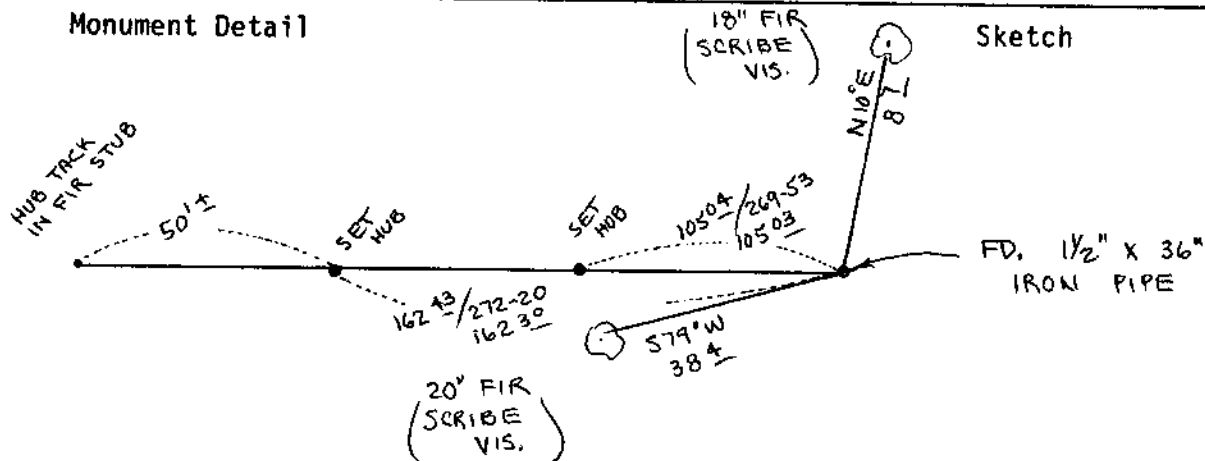

Monument Set (Procedures and Description)

Set additional corner R.P.'s with transit and chain because of planned logging activity in the near future. See sketch.

New Accessories

Location & Comments

Compass Declination 20 $\frac{1}{2}$
 Firm/Agency Roberts
Surveying Inc.
 Address 29 West 29th St.
Eugene, Oregon 97405
 Party Chief Les Roberts
 Notes _____
 Witness Ted Baker

Surveyor's Seal

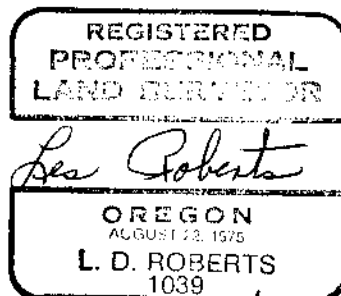

C.S. File No. 63/50-28