

OREGON CORNER RESTORATION FORM

Section 35 Township 20S Range 10W

County DOUGLAS Date 3/11/87

Corner Designation

WEST 1/4 CORNER

- Condition Report Only
- Not Found
- Renewed
- Unrecorded
- Surveyed In
- Referenced Out

Previous Renewals/Surveys, etc.

1867 GLO-ORIGINAL, 1951 BLM, 1983 BLM

Monument(s) & Accessories Found: (Condition and Source)

FND. 2 1/2" IRON PIPE WITH BLM BRASS CAP "1983"

8" FIR, N 71 1/2° E, 111 lbs.

10" FIR, N 80 3/4° W, 54 lbs

Monument Detail

Sketch

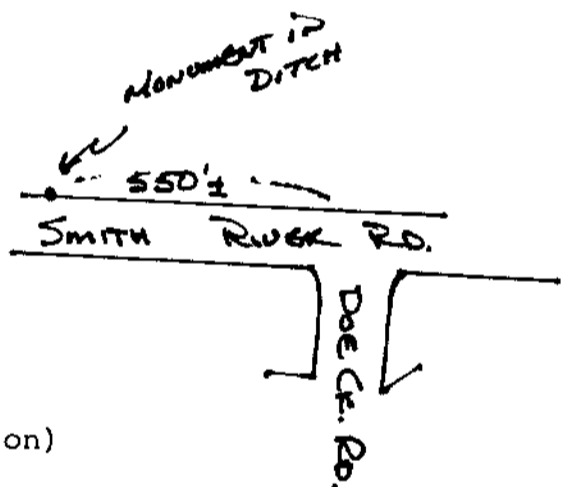

Monument Set (Procedures and Description)

New Accessories

Location & Comments

Surveyor's Seal

MONUMENT IS IN Compass Declination 20°  
DITCH ON NORTH Firm/Agency PEEL BAKER  
SIDE OF SMITH RIVER LAND SURVEYING  
RD., APPROX 550' Address 1262 LAWRENCE  
WEST OF THE JCT. EUGENE, OREGON 97401  
WITH D.C. RD. Party Chief DAN BAKER  
 Notes \_\_\_\_\_  
 Witness DARYL STANLEY

