

FILED

DEC 21 1987

OREGON CORNER RESTORATION FORM

Section 27 Township 20S Range 9W

County Douglas Date 11-26-86

COUNTY SURVEYOR
DOUGLAS COUNTY, ORE

CORNER DESIGNATION

South $\frac{1}{4}$ Corner
Section 27
27
34

- Condition Report Only
- Not Found
- Renewed
- Unrecorded
- Surveyed In
- Referenced Out

Previous Renewals/Surveys, etc. Wm. Thiel's 1877 G.L.O. Survey;
Tillman and Gawron's 1953-1954 G.L.O. Survey; Glenn and Jelley's
1967 B.L.M. Survey, Survey by Roberts Surveying dated 03-15-84,
Monument(s) & Accessories Found: (Condition and Source)

Found 1953 G.L.O. Brass cap bent over from recent logging
activity.

50" Fir Stump, S59W, 76.4' (Scar Vis.), 1953 BT. Rec. S59W, 72.6'
N.E. Maple BT set in 1953 is gone.

6" Alder set in 1967 is down.

Monument Detail

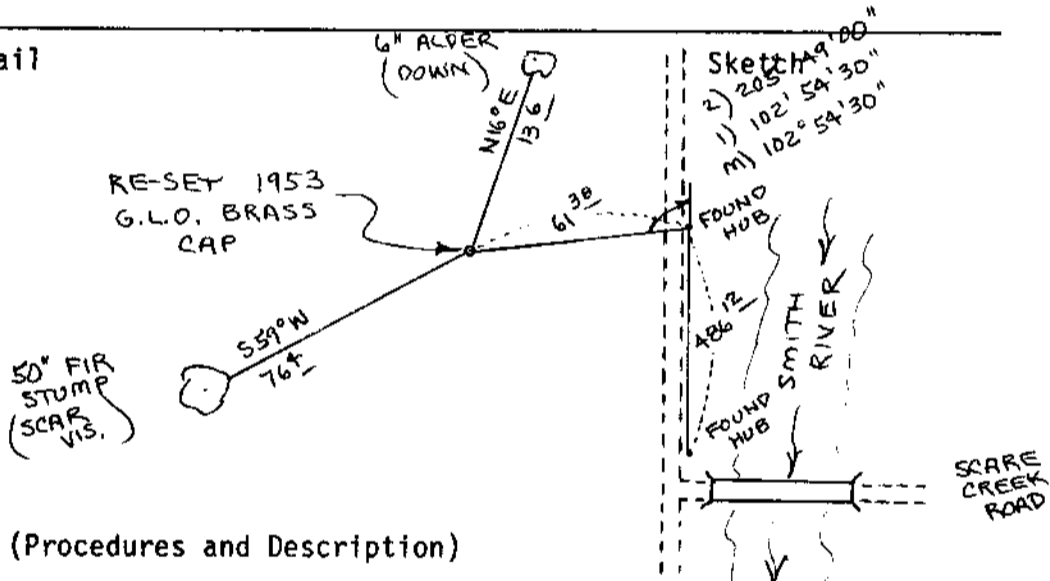

Monument Set (Procedures and Description)

Re-set 1953 G.L.O. Brass Cap firmly in ground using hub and
tack R.P.'s set on 03-13-86. Buried purple magnetic marker
under iron pipe. Set metal fence post, with survey attention
sign wired to, beside brass cap.

New Accessories

Location & Comments

Corner lies on steep Compass Declination 20 $\frac{1}{2}$
East slope about 50' Firm/Agency Roberts
West of Smith River Surveying Inc.
Road. Corner is also Address 29 West 29th St.
about 500' North of Eugene, Oregon 97405
Scare Creek Bridge. Party Chief Ted Baker
Notes
Witness Jim Metzler

Surveyor's Seal

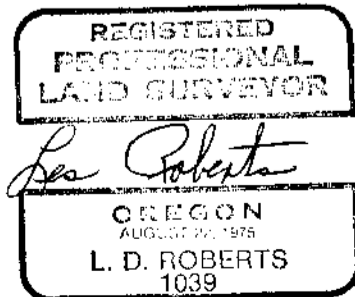

C.S. File No. 63/50-17

#654