

FILED

LR

DEC 21 1987

OREGON CORNER RESTORATION FORM

Section 18 Township 19S Range 8W

County Douglas Date 11-26-86

COUNTY SURVEYOR
DOUGLAS COUNTY, ORE.

CORNER DESIGNATION

Center $\frac{1}{4}$ Corner
Section 18

- Condition Report Only
- Not Found
- Renewed
- Unrecorded
- Surveyed In
- Referenced Out

Previous Renewals/Surveys, etc. Original G.L.O. Survey by C.M. Collier in 1891. Also a survey by the Eugene District of Bureau of Land Management dated October 1974, see map M57-31.

Monument(s) & Accessories Found: (Condition and Source)

3/4" iron pin set by B.L.M. in 1974 was destroyed by recent logging.

- 16" Fir, S77E, 31.0' (Scar Vis.), 1974 B.T. Rec. S77 $\frac{1}{4}$ E, 31.2'
- 28" Fir Stump, N36W, 48.0' (Scar Vis.), 1974 B.T. Rec. N36 $\frac{1}{2}$ W, 48.1'
- 36" Fir Stump, N28E, 41.4' (Scar Vis.), 1974 B.T. Rec. N26 $\frac{3}{4}$ E, 41.0'
- 24" Alder, S54E, 8.80' to R.R. spike in Base. R.P. set 11-04-85
- 36" Fir Stump, N31E, 39.60' to R.R. spike in Base. R.P. set 11-04-85

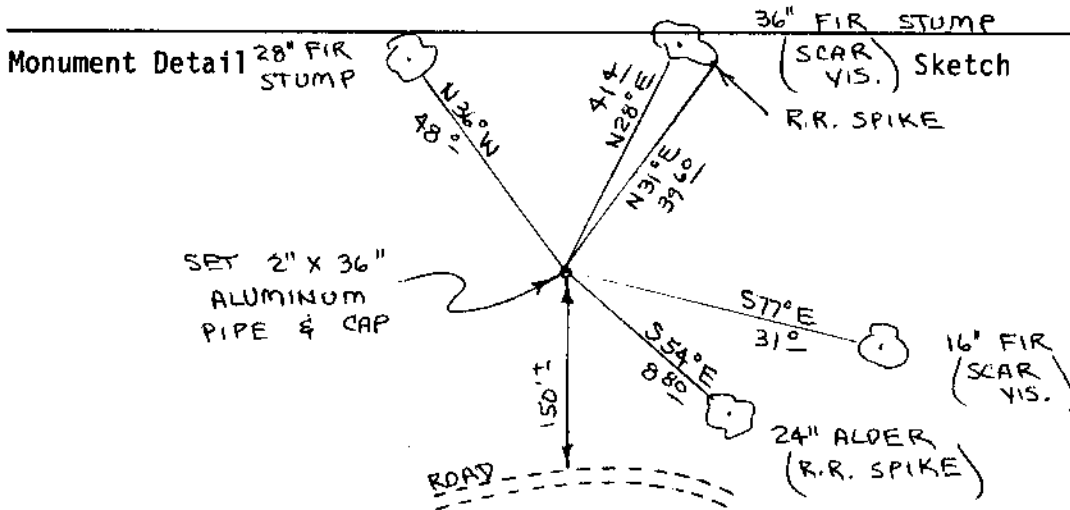

Monument Set (Procedures and Description)

Set 2" x 36" aluminum pipe and cap using distances of 8.80' and 39.60' from R.R. spikes set on 11-04-85. Buried purple magnetic marker under 36" pipe. Set metal fence post, with survey attention sign wired to, beside aluminum pipe. Painted all B.T.'s red.

New Accessories

None set

Location & Comments

Corner lies on N.E. slope about 150' North of road.

Compass Declination 20 $\frac{1}{2}$
 Firm/Agency Roberts Surveying Inc.
 Address 29 West 29th St. Eugene, Oregon 97405
 Party Chief Ted Baker
 Notes _____
 Witness Jim Metzler

Surveyor's Seal

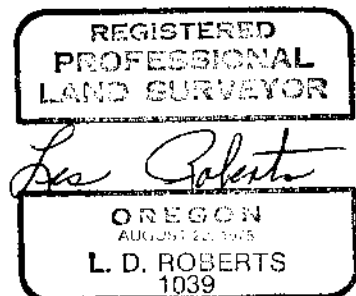

C.S. File No. 63/50-130

#32 x