

FILED *jr*

MAR 3 1987

OREGON CORNER RESTORATION FORM

Sect on 12 Town h p 20 S Range 9 W

County DOUGLAS Date 2-1-87

COUNTY SURVEYOR
DOUGLAS COUNTY ORE.

Corner Des g at o

511 | 512
514 | 513

- Cond t on Report O ly
- Not Found
- Renewed
- Unrecord d
- Surveyed I
- Referenced Out

Prev ous R newals/Surveys etc BLM SURVEY IN 1954
HIAITZ SURVEY IN SEC 12 DATED 1972

Monum nt() & Acce ories Fou d (Cond t on and Source)

- [1953] 7 FIR BRS $\downarrow 34^\circ E$ 48.55
 - [1953] 18 FIR BRS $N 26 \frac{1}{2}^\circ W$ 19.96
 - [1953] 12' ALDER BRS $S 12^\circ W$ 31.50 w/VISIBLE SCRIBING
 - [1753] 26' FIR BRS ~~S 55 1/2 E~~ $S 55^\circ E$ 19'E 17.28
- ALL FIR BT'S HAVE HEALED BLAZES, BT TAGS,
RED PAINTED RINGS,

Monument D ta l

Sketch

FD 1" PIPE WITH ALUM
CAP MARKED

T 20 S R 9 W

511 | 512
514 | 513
1953

SET 6' ALUM POST WITH
ATTENTION SIGN NEXT
TO CAP

Monum nt Set (Proc dure and Description)

New Acce sor es

Locat on & Comments

Surveyor s Seal

Compass Declination $20 E$
F rm/Agency BRANCH
ENGINEERING
Address 212 Q ST
SPRINGFIELD, OR
Party Chief D BRANCH
Note _____
W tness L DILL

REGISTERED
PROFESSIONAL
LAND SURVEYOR

OREGON
DONALD L BRANCH
1137

is r u to 63/48-1b

FILED

MAR 3 1987

OREGON CORNER RESTORATION FORM

Sect on 11 Townsh p 205 Rang 9W
County DOUGLAS Date 2-1-87

COUNTY SURVEYOR
DOUGLAS COUNTY ORE.

Corner Designation

$\frac{1}{4}$ $\frac{511}{514}$

- Condition Report Only
- Not Found
- Renewed
- Unrecorded
- Surveyed In
- Referenced Out

Previous Renewals/Survey etc BLM SURVEY IN 1954
HATZ SURVEY IN SEC 12 DATED 1972

Monument () & Accessories Found (Condition and Source)

- (ORIG) 36 MAPLE BR5 N81°E 67.5 W/ROTTEN BLAZE & HEALED BLAZE
- (1953) 14' ALDER BR5 S77°E 65' W/VISIBLE BARK SCIBE 14514 BT

OTHER EVIDENCE NOT SEARCHED FOR
ED. BT'S WERE TAGGED, RED PAINTED (R1065)

Monument Detail

Sketch

FOUND 2 1/2" BRASS CAP
IN BEDROCK IN RIVER
NEAR WEST SHORELINE
MARKED

T205 R9W
 $\frac{1}{4}$ $\frac{511}{514}$
1953

SET 6' ALL ?' POST WITH
ATTENTION SIGN 15' WESTERLY
FROM MONUMENT

Monument Set (Procedures and Description)

New Accessories

Location & Comment

Surveyor Seal

Compass Declination 20 E
 Firm/Agency BRANCH
ENGINEERING
 Address 212 Q ST
SPRINGFIELD, OR
 Party Chief D BRANCH
 Notes _____
 Witness L DILL

REGISTERED
PROFESSIONAL
LAND SURVEYOR

OREGON
DONALD L BRANCH
1137

FILED

JH

MAR 3 1987

OREGON CORNER RESTORATION FORM

Section 11 Township 20 S Range 9 W

COUNTY SURVEYOR
DOUGLAS COUNTY ORE.

County DOUGLAS Date 2-1-87

Corner Designation

$\frac{1}{4}$
511 | 512

- Condition Report Only
- Not Found
- Renewed
- Unrecorded
- Surveyed In
- Referred Out

Previous Renewals/Surveys etc BLM SURVEY IN 1954
HATZ SURVEY IN SEC 12 DATED 1972

Monument(s) & Accessories Found (Condition and Source)

- (1953) 37" D FIR BR5 S73°E 30.76
- (ORIG) 22 FIR SNAG BR5 S29°E 37.13
- (ORIG) 60" FIR BR5 S7½°W 38.38
- (1953) 30 CEDAR BR5 S72°W 13.0

BT'S WERE SIGNED & RED PAINT
RINGS ADDED,

Monument Detail

Sketch

FD 1" PIPE WITH STD
BLM CAP MARKED

$\frac{1}{4}$
511 | 512
1953

SET 6" ALUM POST WITH
ATTENTION SIGN

Monument Set (Procedures and Description)

New Accessories

Location & Comments

Surveyor's Seal

70' EAST OF Compass Declination 20 E
RIVER Firm/Agency BRANCH
ENGINEERING
 Address 212 Q ST
SPRINGFIELD, OR
 Party Chief D BRANCH
 Note _____
 Witness L DILL

REGISTERED
PROFESSIONAL
LAND SURVEYOR

Donald L Branch

OREGON
DONALD L BRANCH
1137

FILED

[Handwritten initials]

OREGON CORNER RESTORATION FORM

MAR 3 1987

Section 12 Township 20S Range 9W

County DOUGLAS Date 2-1-87

COUNTY SURVEYOR
DOUGLAS COUNTY ORE.

Corner Designation

1/4 512

- Condition Report Only
- Not Found
- Renewed
- Unrecorded
- Surveyed I
- Referenced Out

Previous Renewals/Surveys etc BLM SURVEY IN 1954
HATZ SURVEY IN SEC 12 DATED 1972

Monument(s) & Accessories Found (Condition and Source)

16" HEMLOCK (DOWN) W/BLAZE & BT TAG BRS
S74°W 21 ± TO HOLE
50' FIR BRS N41 1/2°W 197' W/SIGNS

Monument Detail

FD 1" PIPE WITH 2" BLM
CAP BURIED 6" IN GROUND
MARKED

Sketch

T20S
R9W R8W
1/4 512
1954

SET 6 ALUM POST WITH
ATTENTION SIGN

Monument Set (Procedures and Description)

New Accessories

8" HEMLOCK BRS S 5°E 160 SCRIBED 1/4 512 BT

Location & Comments

MONUMENT IS @ Compass Declination 20 E
TOE OF FILL Firm/Agency BRANCH
OF Rd. 50' WEST ENGINEERING
Address 212 Q ST
SPRINGFIELD, OR
Party Chief D BRANCH
Notes
Witness L DILL

Surveyor's Seal

REGISTERED
PROFESSIONAL
LAND SURVEYOR

[Handwritten signature]

OREGON
DONALD L BRANCH
1137

FILED

JK

MAR 3 1987

OREGON CORNER RESTORATION FORM

Section 11 Township 20 S Range 9 W

County DOUGLAS Date FEB. 4, '87

COUNTY SURVEYOR
DOUGLAS COUNTY, ORE.

Corner Designation

$\frac{1}{4}$ $\frac{S2}{S11}$

- Condition Report Only
- Not Found
- Renewed
- Unrecorded
- Surveyed In
- Referenced Out

Previous Renewals/Surveys, etc _____

Monument(s) & Accessories Found (Condition and Source)

60" FIR STUMP, 5' HIGH WITH TIN ON TOP FOR PHOTO I.D. & WITH HEALED BLAZES & BT TAGS. N34 1/2° E 186' TO FACE; SET SPIKE W/LS CAP IN TOP CENTER OF STUMP.

60" FIR STUMP, 5' HIGH WITH TIN TAGS, HEALED BLAZE: S 12° E 9.0' TO FACE; SET 5/8" x 30" I ROD IN TOP CENTER OF STUMP

Monument Detail NO TREES AVAILABLE FOR BT'S Sketch

STD. ALUM 2" CAP ON 1" I. PIPE MARKED

$\frac{1}{4}$ $\frac{S2}{S11}$

SET 6' ALUM POST WITH ATTENTION SIGN ALONG SIDE DOCUMENT CREEK BEARS NORTH 50' ±

Monument Set (Procedures and Description)

New Accessories

NO TREES AVAILABLE FOR BT'S (CLEAR CUT AREA)

Location & Comments

Surveyor's Seal

Compass Declination 20° E

Firm/Agency BRANCH ENGINEERING

Address 212 Q ST

SPRINGFIELD, OR

Party Chief D BRANCH

Notes _____

Witness L DILL

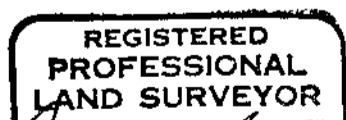

Donald L Branch

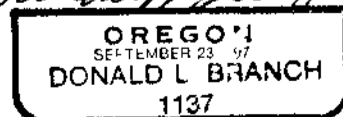

FILED

JR

MAR 3 1987

OREGON CORNER RESTORATION FORM

Section 11 Township 20S Range 9W

County DOUGLAS Date 2-1-87

COUNTY SURVEYOR
DOUGLAS COUNTY, ORE.

Corner Designation

1/4
S10 | S11

- Condition Report Only
- Not Found
- Renewed
- Unrecorded
- Surveyed In
- Referenced Out

Previous Renewals/Surveys, etc. _____

Monument(s) & Accessories Found (Condition and Source)

- (1954) 44" FIR STUMP BR'S S16°E 39.1' W/NO MARKS OR SIGNS
- (1954) 52" FIR " " N52°W 51.35' W/ BURNT BLAZE (NO SIGNS)
- (MEN'S & W) 24" " " " N43°E 11.52' W/NO MARKS OR SIGNS
- (THIEL) 24" " " " S 54°E 27.4' " " "

ADDED BT SIGNS, PAINT & FLAGGING

Monument Detail

Sketch

FD, 1" PIPE W/ 1/2" BLDG
CAP MARKED:

1/4
S10 | S11

FD OLD 1" PIPE ALONGSIDE

1954

ADDED 6" ALUM POST W/ ATTENTION SIGN

Monument Set (Procedures and Description)

New Accessories

NO TREES AVAILABLE FOR BT'S
CLEAR CUT AREA

Location & Comments

168' SOUTH
OF RIDGE RD

Compass Declination 20°E

Firm/Agency BRANCH
ENGINEERING

Address 212 Q ST
SPRINGFIELD OR

Party Chief D BRANCH

Notes _____

Witness L. DILL

Surveyor's Seal



FILED

jh
MAR 3 1987

OREGON CORNER RESTORATION FORM

Section 12 Township T20S Range 9W

County DOUGLAS Date 2 12 87

COUNTY SURVEYOR
DOUGLAS COUNTY, ORE.

Corner Designation

$\frac{1}{4}$ $\frac{512}{513}$

- Condition Report Only
- Not Found
- Renewed
- Unrecorded
- Surveyed In
- Referenced Out

Previous Renewals/Surveys, etc. BLM SURVEY 1A' 1954
HINTZ SURVEY IN SEC 12 DATED 1972

Monument(s) & Accessories Found (Condition and Source)

STD. BLM, 2 1/2" DIA CAP ON PIPE

1953 26" CEDAR STUMP BRS N 55 1/2° W 1546' WITH
VISIBLE SCRIBING 1/4 BT

OTHER STUMP NOT LOOKED FOR.

Monument Detail

$\frac{1}{4}$ $\frac{512}{513}$
1953

Sketch

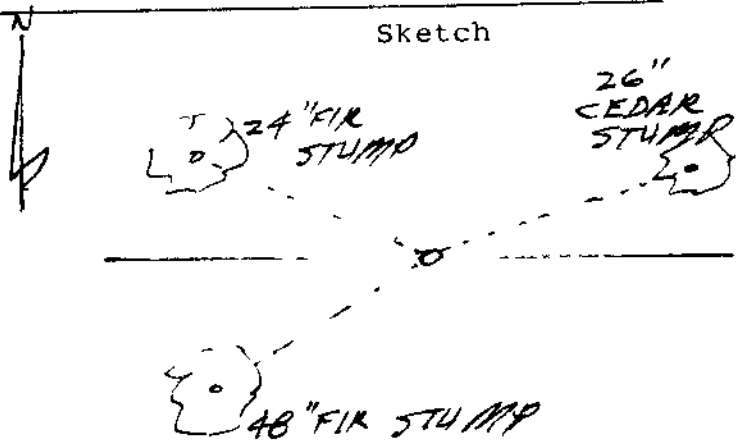

AERIAL PHOTO I.D.
PLASTIC STILL IN
PLACE

Monument Set (Procedures and Description)

SET 6" ALUM. POST WITH ATT'N SIGN
BESIDE MONUMENT

New Accessories

24" FIR STUMP WITH TAG BRS N 71° W 2480'

48" x 6" HIGH STUMP WITH SPIKE NAIL 1/4 L.S. CAP
1A' CENTER TOP BRS S 74° W 57.31'

Location & Comments

100' ± EAST
OF CREEK

Compass Declination 20° E

Firm/Agency BRANCH
ENGINEERING

Address 212 Q ST
SPRINGFIELD OR

Party Chief D BRANCH

Notes

Witness L. DILL

Surveyor's Seal

REGISTERED
PROFESSIONAL
LAND SURVEYOR

OREGON
SEPTEMBER 23 1899
DONALD L. BRANCH
1137

OREGON CORNER RESTORATION FORM

Section 12 Township 20S Range 9W

County DOUGLAS Date 2-1-87

FILED

MAR 3 1987

COUNTY SURVEYOR
DOUGLAS COUNTY, ORE.

Corner Designation

$\frac{1}{4}$ $\frac{S1}{S12}$

- Condition Report Only
- Not Found
- Renewed
- Unrecorded
- Surveyed In
- Referenced Out

Previous Renewals/Surveys, etc. BLM SURVEY IN 1954
HATZ SURVEY IN SEC 12 DATED 1972

Monument(s) & Accessories Found (Condition and Source)

19" FIR SAWAG BRS N37°W 67'
21" " " " S16°W 235' W/BARK SCRIBING & TAG

Monument Detail

Ed. 1" PIPE WITH B.L.M
CAP MARKED

Sketch

T20S R9W
 $\frac{1}{4}$ $\frac{S1}{S12}$
1954

SET 6' ALUM POST WITH
ATTENTION SIGN NEXT
TO MONUMENT

Monument Set (Procedures and Description)

New Accessories

8" D FIR BRS N5°E 14.0' SCRIBED $\frac{1}{4}$ S1 BT
8" D FIR BRS S8°E 3.1' " $\frac{1}{4}$ S12 BT

Location & Comments

Compass Declination 20°E
Firm/Agency BRANCH
ENGINEERING
Address 212 Q ST
SPRINGFIELD, OR
Party Chief D. BRANCH
Notes _____
Witness L DILL

Surveyor's Seal

REGISTERED
PROFESSIONAL
LAND SURVEYOR

OREGON
SEPTEMBER 23 1977
DONALD L. BRANCH
1137

FILED

MAR 3 1987

OREGON CORNER RESTORATION FORM

Section 11 Township 20S Range 9W

COUNTY SURVEYOR
DOUGLAS COUNTY, ORE.

County DOUGLAS Date 2-1-87

Corner Designation

E 1/16 511
514

- Condition Report Only
- Not Found
- Renewed
- Unrecorded
- Surveyed In
- Referenced Out

Previous Renewals/Surveys, etc BLM SURVEY IN 1954
HIATZ SURVEY IN SEC 12 DATED 1972

Monument(s) & Accessories Found (Condition and Source)

Monument Detail

STD I.P CO
CAP MARKED

Sketch

RLS
1137
T20S R9W
E 1/16 511
514
1986

Monument Set (Procedures and Description)

AS PER SURVEY, I SET A 5/8" X 36" ALUM ROD
WITH 7" ALUM. CAP WITH 6" ALUM. POST W/ SIGN
ALONGSIDE

New Accessories

30" FIR BR5 S88°W 390' SCRIBED E 1/16 514 BT
30" D. FIR BR5 N20 1/2° E 5678' " E 1/16 511 BT

Location & Comments

16' W'EST OF
E OF HIGH-
WAY

Compass Declination 20°E

Firm/Agency BRANCH
ENGINEERING

Address 212 Q ST
SPRINGFIELD, OR

Party Chief D. BRANCH

Notes

Witness L DILL

Surveyor's Seal

REGISTERED
PROFESSIONAL
LAND SURVEYOR

Donald L Branch

OREGON
SEPTEMBER 23, 1977
DONALD L BRANCH
1137

FILED

MAR 3 1987

OREGON CORNER RESTORATION FORM

Section 11 Township 20 S Range 9 W

County DOUGLAS Date 2-1-87

COUNTY SURVEYOR
DOUGLAS COUNTY, ORE.

Corner Designation

SE 1/16 511

- Condition Report Only
- Not Found
- Renewed
- Unrecorded
- Surveyed In
- Referenced Out

Previous Renewals/Surveys, etc BLM SURVEY IN 1954
HIAITZ SURVEY IN SEC 12 DATED 1972

Monument(s) & Accessories Found (Condition and Source)

NONE

Monument Detail

RLS
1137
T20 S R9 W
SE 1/16 511
1987

Sketch

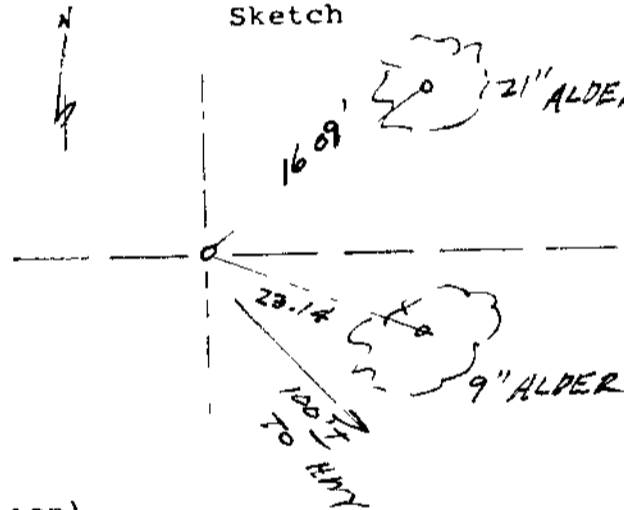

Monument Set (Procedures and Description)

3" DIA. INTERNATIONAL PAPER CO ALUM. CAP
ON 5/8" x 36" ALUM. ROD

New Accessories

21" ALDER BRS N22°E 16 09' BARK SCRIBED
SE 1/16 511 BT
9" ALDER BRS S 60°E 23 14' BARK SCRIBED
SE 1/16 511 BT

Location & Comments

CORNER LIES Compass Declination 20°E
ABOUT 1/2 WAY Firm/Agency BRANCH
BETWEEN RIVER ENGINEERING
& HWY Address 212 Q ST
SPRINGFIELD, OR
Party Chief D. BRANCH
Notes _____
Witness L DILL

Surveyor's Seal

REGISTERED
PROFESSIONAL
LAND SURVEYOR

Donald L Branch

OREGON
SEPTEMBER 21, 1977
DONALD L BRANCH
1137

CS File No 63/48-

FILED

js

MAR 3 1987

OREGON CORNER RESTORATION FORM

Section 12 Township 20S Range 9W

County DOUGLAS Date 2-1-87

COUNTY SURVEYOR
DOUGLAS COUNTY, ORE.

Corner Designation

SW 1/16 S12

- Condition Report Only
- Not Found
- Renewed
- Unrecorded
- Surveyed In
- Referenced Out

Previous Renewals/Surveys, etc. BLM SURVEY IN 1954
HIA'Z SURVEY IN SEC 12 DATED 1972

Monument(s) & Accessories Found (Condition and Source)

CEDAR STUMP BRS N 86° W 120' TO FACE
TAG READS N 83° E 136'
(STUMP HAS NO RECORD)

6" D.

Monument Detail

Sketch

STD INTERNATIONAL
PAPER CO. CAP
MARKED

RLS
1137

SW 1/16

S12

1986

T205 R9W

Monument Set (Procedures and Description)

PER FILED SURVEY, I SET A 5/8" x 30" ALUM
ROD WITH 3" ALUM. CAP ~~AND~~ MARKED PER
MANUAL. BURIED MAGNET ALONG SIDE

New Accessories

6" D. FIR BRS N 1° W 46 25'
L ALDER BRS S 76° W 28 21'

Location & Comments

40' SOUTH OF
CREEK

Compass Declination 20° E

Firm/Agency BRANCH
ENGINEERING

Address 212 Q ST

SPRINGFIELD, OR

Party Chief D. BRANCH

Notes

Witness L DILL

Surveyor's Seal

REGISTERED
PROFESSIONAL
LAND SURVEYOR

OREGON
SEPTEMBER 21 1977
DONALD L BRANCH
1137

FILED

JH

MAR 3 1987

OREGON CORNER RESTORATION FORM

Section 12 Township 20S Range 9W

County DOUGLAS Date 2-1-87

COUNTY SURVEYOR
DOUGLAS COUNTY, ORE.

Corner Designation

CW 1/6 S12

- Condition Report Only
- Not Found
- Renewed
- Unrecorded
- Surveyed In
- Referenced Out

Previous Renewals/Surveys, etc. BLM SURVEY IN 1954
HINTZ SURVEY IN SEC 12 DATED 1972

Monument(s) & Accessories Found (Condition and Source)

5/8" I. ROD & 11" ALDER BT W/TAG
PER HINTZ SURVEY 1972

Monument Detail

Sketch

STD. I. P. CO
CAP MARKED

RLS
1137
T20S R9W
CW 1/6 S12
1987

Monument Set (Procedures and Description)

AS PER SURVEY PLAT, I SET 5/8" x 36" ALUM
ROD WITH ALUM CAP ^{WITH} MAGNET, &
6' SIGN POST ALONGSIDE

New Accessories

11" ALDER BRS N 63 1/2° E 14.4'
11" ALDER (EXISTING BT BY HINTZ) BRS S 89° E 71'
12" ALDER BRS S 20° W 10'
5/8" I. ROD (HINTZ) BRS S 85° E 142'

Location & Comments

Surveyor's Seal

50' SE OF
HIGHWAY

Compass Declination 20° E
Firm/Agency BRANCH
ENGINEERING
Address 212 Q ST
SPRINGFIELD, OR
Party Chief D. BRANCH
Notes _____
Witness L DILL

REGISTERED
PROFESSIONAL
LAND SURVEYOR

Donald L. Branch

OREGON
SEPTEMBER 23 1972
DONALD L. BRANCH
1137

FILED

JR
MAR 3 1987

OREGON CORNER RESTORATION FORM

Section 12 Township 20S Range 9W
County DOUGLAS Date 2-1-87

COUNTY SURVEYOR
DOUGLAS COUNTY, ORE.

Corner Designation

S 1/6
S 11 | S 12

- Condition Report Only
- Not Found
- Renewed
- Unrecorded
- Surveyed In
- Referenced Out

Previous Renewals/Surveys, etc. BLM SURVEY IN 1954
HATZ SURVEY IN SEC 12 DATED 1972

Monument(s) & Accessories Found (Condition and Source)

Monument Detail

STD I. P CO
CAP MARKED

Sketch

RLS
1137
T20S R9W
S 1/6
S 11 | S 12
1986

Monument Set (Procedures and Description)

AS PER SURVEY, I SET A 5/8" x 30" ALUM. ROD
WITH ALUM. CAP. A MAGNET WAS
BURIED ALONG SIDE

SET 6' POST 3" SIGN ALONG SIDE

New Accessories

12" ALDER BR5 N84°E 4116' SCRIBED S 1/6 S 12 BT
39" CEDAR BR5 N10°E 1276' SCRIBED S 1/6 S 12 BT

Location & Comments

60' SOUTH OF
CREEK

Compass Declination 20°E

Firm/Agency BRANCH
ENGINEERING

Address 212 Q ST
SPRINGFIELD, OR

Party Chief D. BRANCH

Notes

Witness L DILL

Surveyor's Seal

REGISTERED
PROFESSIONAL
LAND SURVEYOR

Donald L Branch

OREGON
SEPTEMBER 23, 1977
DONALD L BRANCH
1137

FILED

js

MAR 3 1987

OREGON CORNER RESTORATION FORM

Section 12 Township 20S Range 9W

County DOUGLAS Date 2-1-87

COUNTY SURVEYOR
DOUGLAS COUNTY, ORE.

Corner Designation

N 1/4

511 | 512

- Condition Report Only
- Not Found
- Renewed
- Unrecorded
- Surveyed In
- Referenced Out

Previous Renewals/Surveys, etc BLM SURVEY IN 1954
HIAITZ SURVEY IN SEC 12 DATED 1972

Monument(s) & Accessories Found (Condition and Source)

Monument Detail

Sketch

STD. I.P. CO.
CAP MARKED

RLS
1137
T 20S R9W
N 1/4
511 | 512
1987

Monument Set (Procedures and Description)

AS PER SURVEY I SET A 5/8" x 36" ALUM ROD
WITH 3" ALUM CAP, WITH BURIED MAGNET
& 6' POST & SIGN ALONGSIDE

New Accessories

40" FIR BRS S 23° E 41.37' SCRIBED N 1/4 512 BT
10" ALDER BRS N 60° E 100 67' BARK SCRIBED
N 1/4 511 BT

Location & Comments

ON SOUTH
SLOPE

Compass Declination 20° E

Firm/Agency BRANCH
ENGINEERING

Address 212 Q ST
SPRINGFIELD, OR

Party Chief D. BRANCH

Notes

Witness L DILL

Surveyor's Seal

REGISTERED
PROFESSIONAL
LAND SURVEYOR

Donald L. Branch

OREGON
SEPTEMBER 21, 1977
DONALD L. BRANCH
1137