

M107-57

OREGON CORNER RESTORATION FORM

Section 8 Township 22S Range 12W

County Douglas Date 6-15-87

CORNER DESIGNATION

S.E. Corner
Section 8

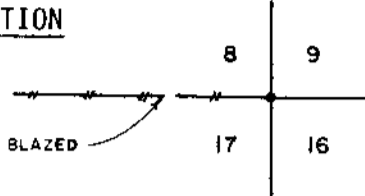

- Condition Report Only
- Not Found
- Renewed
- Unrecorded
- Surveyed In
- Referenced Out

Previous Renewals/Surveys, etc. Original G.L.O. surveys by Harvey Gordon in 1857 and by William Thiel in 1889. Survey M94-34 by Richard Hintz in 1983 & survey M98-34 by Ron Stuntzner in 1985. Douglas County Renewal C.S. 62/1 by Larry Monrean dated 10-18-82
 Monument(s) & Accessories Found: (Condition and Source)

- Found 1982 Douglas County Brass Cap set firmly in the ground.
- 36" Spruce Stump, N07E, 47.5' (Scribe Vis.), 1857 BT. Rec. N07E, 47.5'
 - 14" Cedar, N31W, 14.7' (Scribe Vis.), 1982 CSBT. Rec. N31W, 14.5'
 - 14" Cedar, S73W, 22.4' (Scribe Vis.), 1982 CSBT. Rec. S73W, 22.3'
 - 15" Cedar, S36E, 18.7' (Scribe Vis.), 1982 CSBT. Rec. S35 1/2 E, 18.8'
 - 19" Spruce, N85E, 22.7' (Scribe Vis.), 1982 CSBT. Rec. N85E, 22.6'

Monument Detail

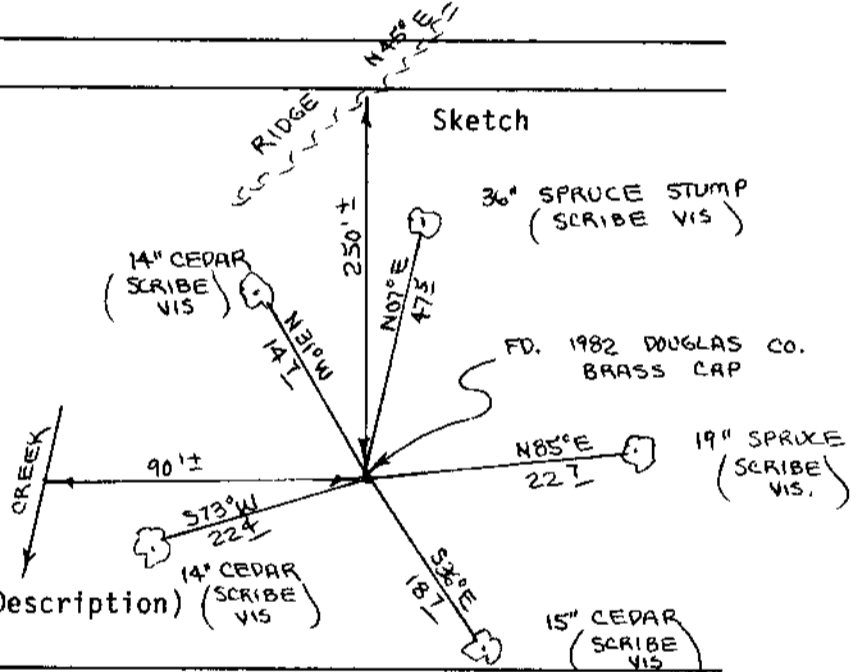

Monument Set (Procedures and Description)

New Accessories

None

Location & Comments

Corner lies on S.W. slope about 250 feet South of ridge. Ridge bears N45E and S45W. Corner also lies about 90 feet East of small Creek.

Compass Declination 20 1/2
 Firm/Agency Roberts Surveying Inc.
 Address 29 West 29th St. Eugene, Oregon 97405
 Party Chief Ted Baker
 Notes _____
 Witness Jim Metzler

Surveyor's Seal

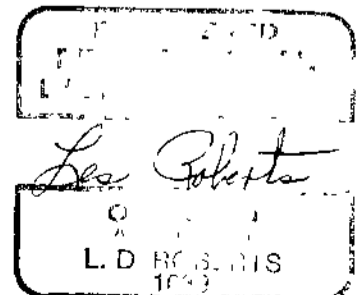

M107-57

OREGON CORNER RESTORATION FORM

Section 8 Township 22S Range 12W

County Douglas Date 07-02-87

CORNER DESIGNATION

East 1/16 Corner
South Line Sec. 8

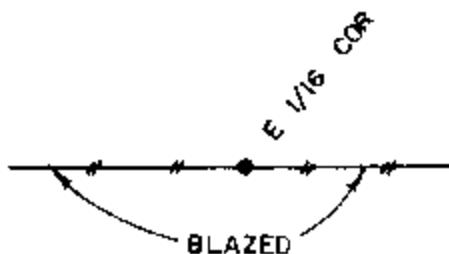

- Condition Report Only
- Not Found
- Renewed
- Unrecorded
- Surveyed In
- Referenced Out

Previous Renewals/Surveys, etc. Original G.L.O. survey by Harvey Gordon in 1857.

Monument(s) & Accessories Found: (Condition and Source)

No Monument Found

Monument Detail

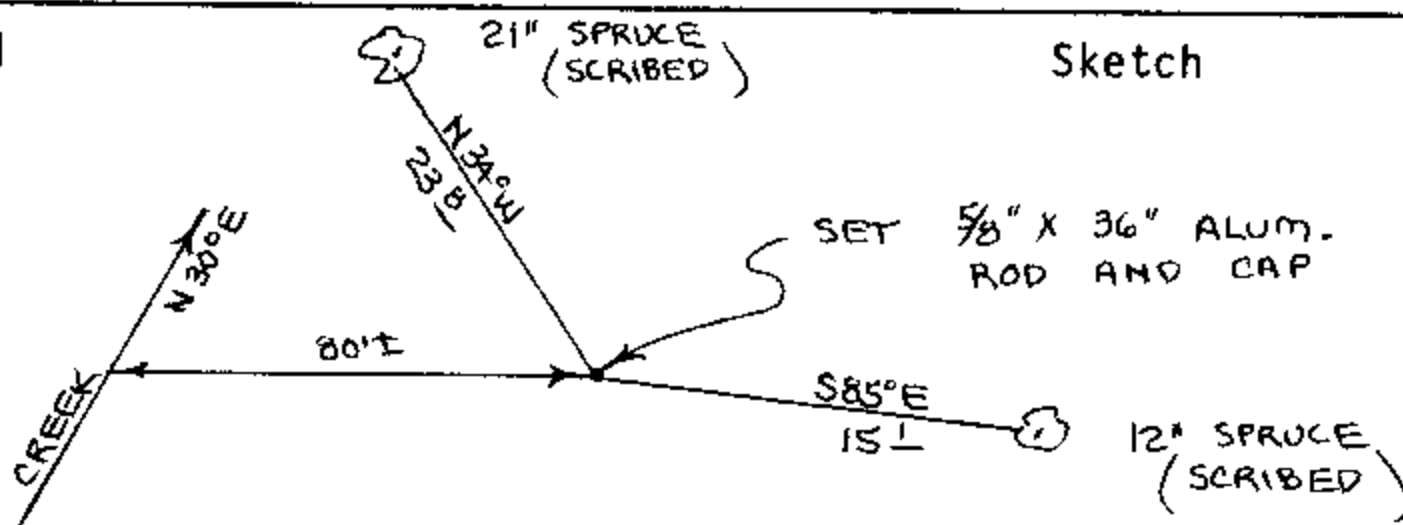
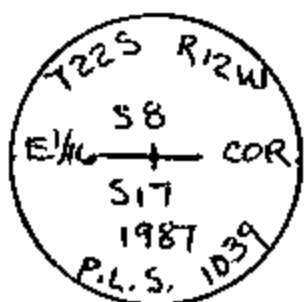

Monument Set (Procedures and Description)

Set 5/8" aluminum rod with 3 1/4" aluminum cap. Buried purple magnetic marker under 36" aluminum rod. Set 60" aluminum post, with land survey monument sign attached to, beside aluminum rod.

New Accessories

12" Spruce, S85E, 15.1' (Scribed/Painted Red)

21" Spruce, N34W, 23.8' (Scribed/Painted Red)

Location & Comments

Corner lies on North

slope about 80 feet

East of small creek.

Creek bears N30E.

Compass Declination 20 1/2

Firm/Agency Roberts

Surveying Inc.

Address 29 West 29th St.

Eugene, Oregon 97405

Party Chief Ted Baker

Notes

Witness Jim Metzler

Surveyor's Seal

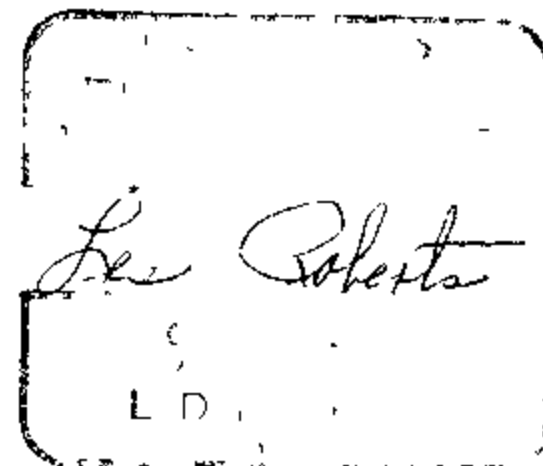

U.S. No 63/46-8b

M107-57

OREGON CORNER RESTORATION FORM

Section 8 Township 22S Range 12W

County Douglas Date 6-16-87

CORNER DESIGNATION

South $\frac{1}{4}$ Corner
Section 8

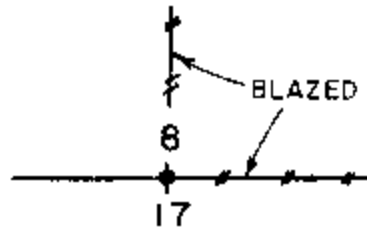

- Condition Report Only
- Not Found
- Renewed
- Unrecorded
- Surveyed In
- Referenced Out

Previous Renewals/Surveys, etc. Original G.L.O. survey by Harvey Gordon in 1857 and Douglas County Renewal C.S. 61/30 by Larry Monrean dated April 12, 1982.

Monument(s) & Accessories Found: (Condition and Source)

Found 1982 Douglas County Brass Cap set firmly in the ground.
15" Fir, S53W, 19.8' (Scar Vis.), 1982 BT. Rec. S53W, 19.6'
16" Spruce, S23E, 27.5' (Scribe Vis.), 1982 BT. Rec. S23E, 27.5'
22" Spruce, N68E, 32.2' (Scar Vis.), 1982 BT. Rec. N67E, 32.4'
30" Spruce, N16E, 17.5' (Scar Vis.), 1982 BT. Rec. N16E, 17.5'

Monument Detail

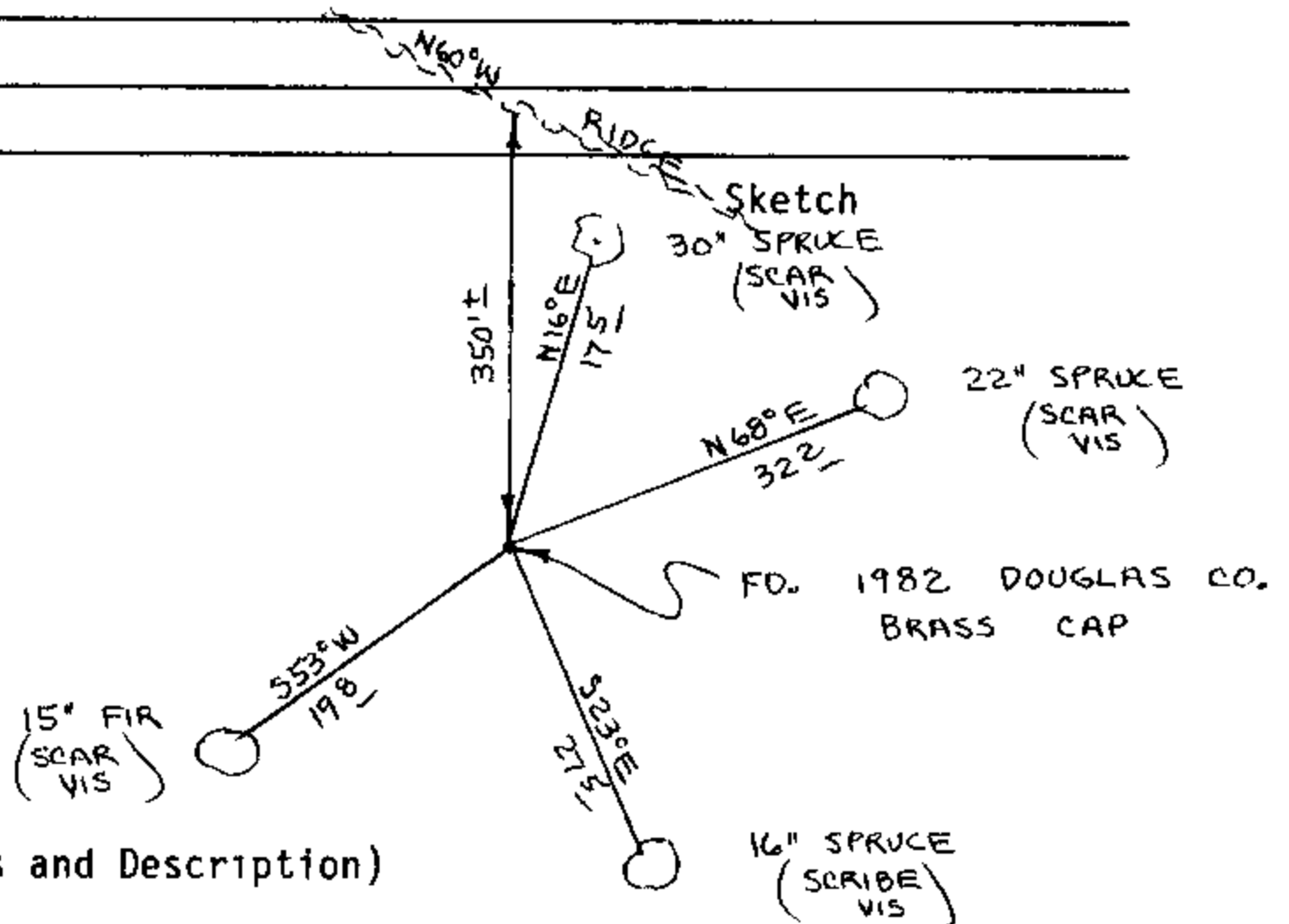

Monument Set (Procedures and Description)

New Accessories

Set 60" aluminum post, with land survey monument sign attached to, beside brass cap. Painted all B.T.'s red.

Location & Comments

Corner lies on S.W. slope about 350 feet South of ridge. Ridge bears N60W and S60E
Compass Declination $20\frac{1}{2}$
Firm/Agency Roberts Surveying Inc.
Address 29 West 29th St. Eugene, Oregon 97405
Party Chief Ted Baker
Notes _____
Witness Jim Metzler

Surveyor's Seal

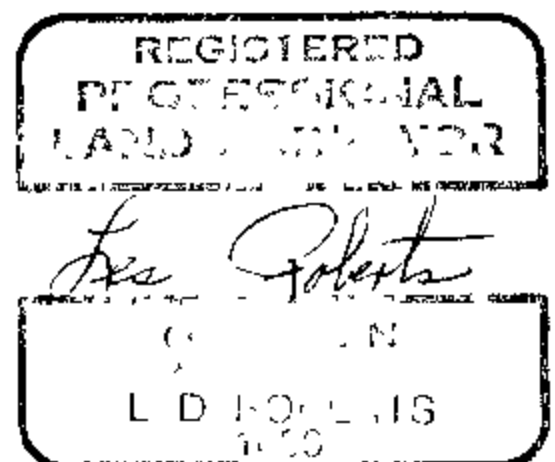

M107-57

OREGON CORNER RESTORATION FORM

Section 8 Township 22S Range 12W

County Douglas Date 07-02-87

CORNER DESIGNATION

P.O.T. on North-South E Sec. 8

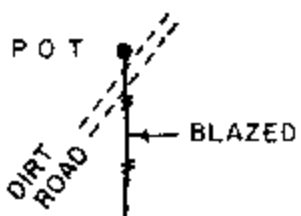

- Condition Report Only
- Not Found
- Renewed
- Unrecorded
- Surveyed In
- Referenced Out

Previous Renewals/Surveys, etc. None

Monument(s) & Accessories Found: (Condition and Source)

None

Monument Detail

Sketch

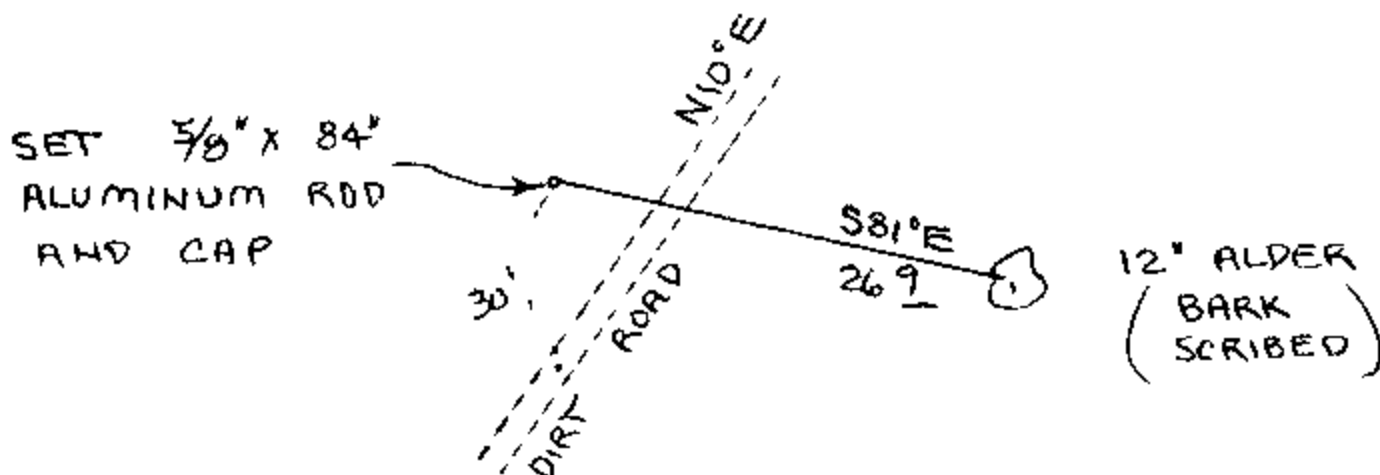

Monument Set (Procedures and Description)

Set 5/8" x 84" Aluminum rod with 3 1/4" aluminum cap. Buried purple magnetic marker under aluminum cap. Set 60" aluminum post, with land survey monument sign attached to, beside aluminum rod.

New Accessories

12" Alder, S81E, 26.9' (Bark Scribed/Painted Red)

Location & Comments

Corner lies on flat ground about 30 feet North of dirt road. Road bears S10W & N10E

Compass Declination 20 1/2
Firm/Agency Roberts Surveying Inc.
Address 29 West 29th St. Eugene, Oregon 97405
Party Chief Ted Baker
Notes _____
Witness Jim Metzler

Surveyor's Seal

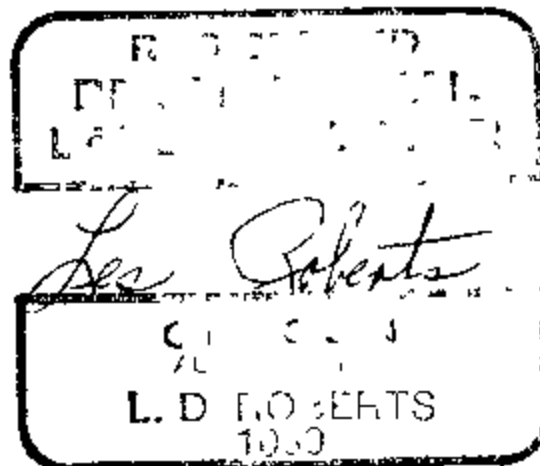

M 107-57

OREGON CORNER RESTORATION FORM

Section 8 Township 22S Range 12W

County Douglas Date 07-01-87

CORNER DESIGNATION

North $\frac{1}{4}$ Corner
Section 8



- Condition Report Only
- Not Found
- Renewed
- Unrecorded
- Surveyed In
- Referenced Out

Previous Renewals/Surveys, etc. Original G.L.O. Survey by Harvey

Gordon in 1857 and Richard Hintz Survey C.S. M94-34. Also

Douglas County Renewal C.S. 58/140 dated May 1983

Monument(s) & Accessories Found: (Condition and Source)

Found 1 1/2" iron pipe and brass cap set in C.S. M94-34.

20" Spruce, N51E, 11.9' (Scribe Vis.), 1983 BT. Rec. N51 1/2 E, 11.8'

22" Fir, S20E, 24.2' (Scribe Vis.), 1983 BT. Rec. S21E, 24.1'

Monument Detail

Sketch

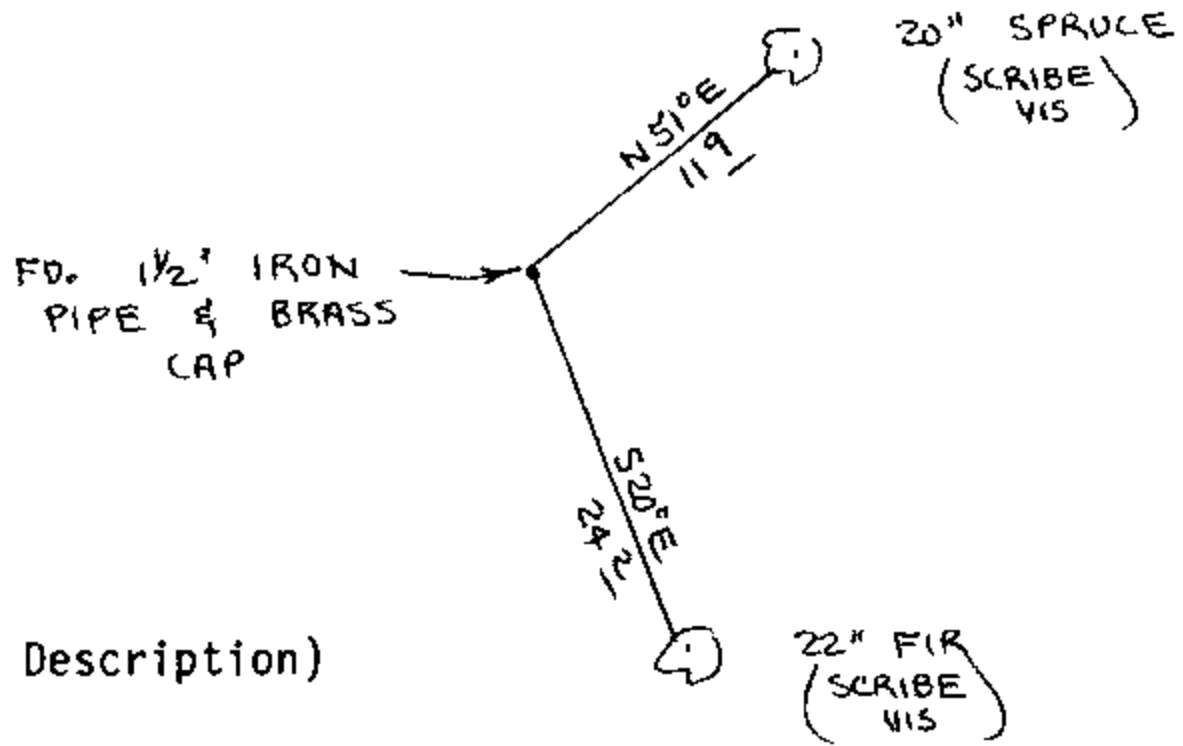

Monument Set (Procedures and Description)

New Accessories

Set 60" aluminum post, with land survey monument sign attached to, beside brass cap. Painted all B.T.'s red.

Location & Comments

Surveyor's Seal

Compass Declination 20 1/2

Firm/Agency Roberts Surveying Inc.

Address 29 West 29th St. Eugene, Oregon 97405

Party Chief Ted Baker

Notes _____

Witness Jim Metzler

