

M 107-56

OREGON CORNER RESTORATION FORM

Section 5 Township 22S Range 12W

County Douglas Date 1-19-89

CORNER DESIGNATION

North $\frac{1}{4}$ Corner
Section 5

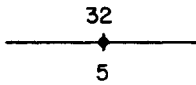

- Condition Report Only
- Not Found
- Renewed
- Unrecorded
- Surveyed In
- Referenced Out

Previous Renewals/Surveys, etc. Original Survey by Harvey Gordon in 1857 and Survey M51-65 by Robert Thompson dated 12-14-73 also Douglas County Renewal M102-71 dated 10-86.

Monument(s) & Accessories Found: (Condition and Source)

Found 1 1/4" iron pipe set in C.S. M51-65.

- 26" Spruce Snag, N38W, 22.1' (Scribe Vis.), 1857 BT. Rec. N36W, 21.1'
- 17" Alder Snag, S71W, 51.4' (Scribe Vis.), 1973 BT. Rec. S71 1/2 W, 51.4'
- 16" Spruce, East, 33.6' (Scribe Vis.), 1986 BT. Rec. S88E, 33.6'
- 19" Spruce, N24E, 24.0' (Scribe Vis.), 1986 BT. Rec. N26E, 24.0'

Monument Detail

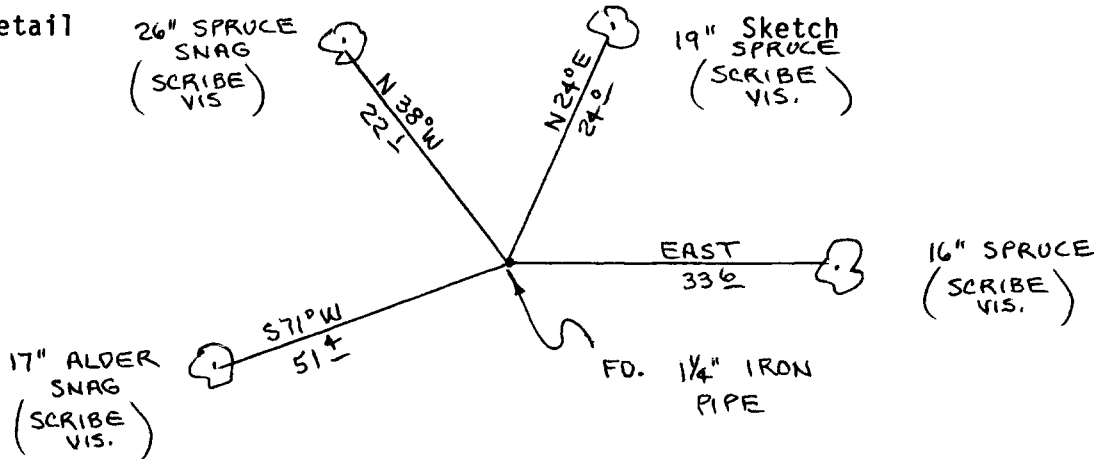

Monument Set (Procedures and Description)

New Accessories

Set 60" aluminum post, with land survey monument sign attached to, beside 1 1/4" iron pipe. Painted all B.T.'s red.

Location & Comments

Corner lies in swampy creek bottom. Creek runs North.

Compass Declination 20 1/2
 Firm/Agency Roberts Surveying Inc.
 Address 29 West 29th Street, Eugene, Ore.
 Party Chief Ted Baker
 Notes _____
 Witness Norman Hamar

Surveyor's Seal



C.S. File No. 63/46-7a

M107-56

OREGON CORNER RESTORATION FORM

Section 5 Township 22S Range 12W

County Douglas Date 01-20-89

CORNER DESIGNATION

West $\frac{1}{4}$ Corner
Section 5

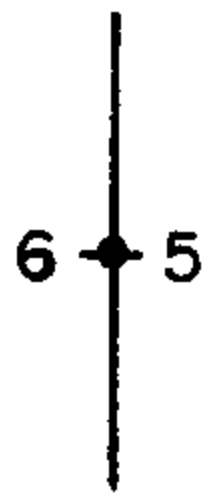

- Condition Report Only
- Not Found
- Renewed
- Unrecorded
- Surveyed In
- Referenced Out

Previous Renewals/Surveys, etc. Original survey by Harvey Gordon in
in 1857. C.S. M51-65 by Robert Thompson dated 12-14-73 and C.S.
M95-9 by Richard Hintz dated 09-30-83

Monument(s) & Accessories Found: (Condition and Source)

Found 1 1/4" iron pipe set in C.S. M51-65

19" Hemlock Stump, S45E, 20.5' (Scribe Vis.), 1973 BT. Rec. S48E, 16.6'

29" Hemlock Stump, S63W, 16.3' (Scribe Vis.), 1973 BT. Rec. S62°45'W,
20.4'

Monument Detail

Sketch

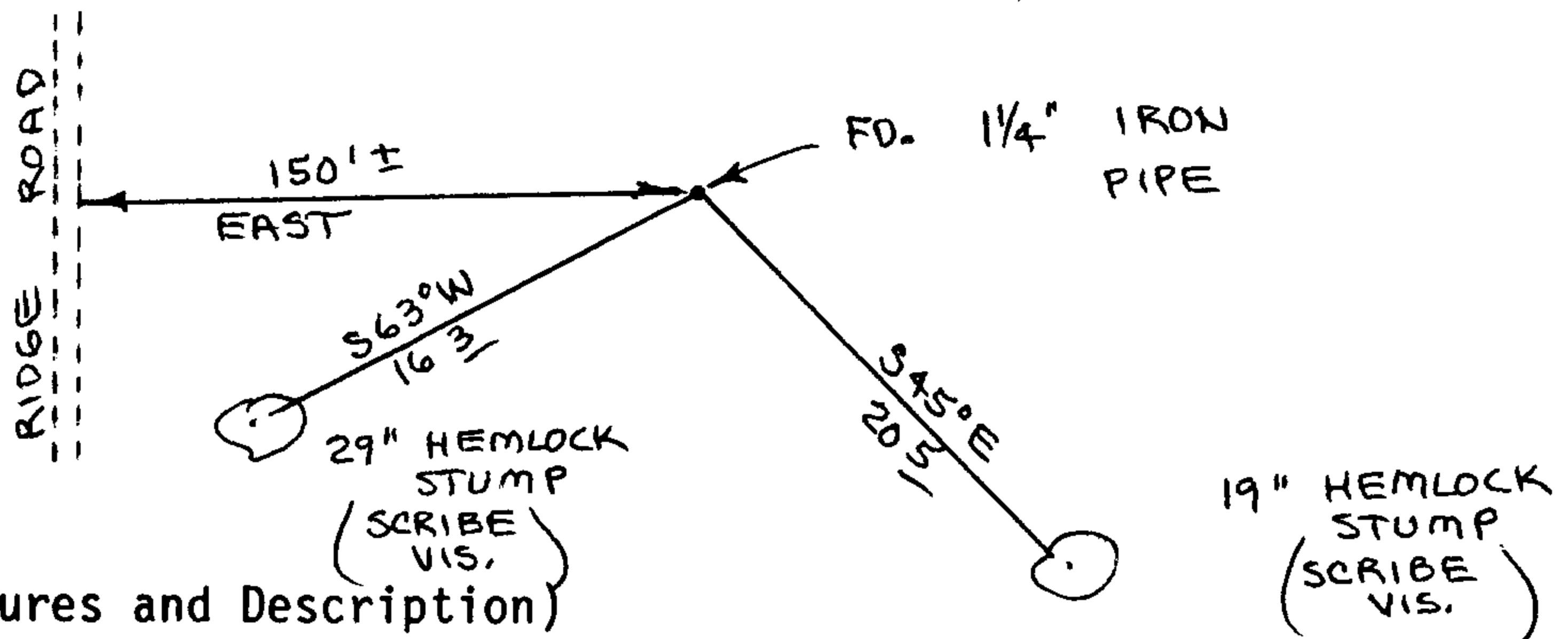

Monument Set (Procedures and Description)

Set 60" aluminum post, with land survey monument sign attached
to, beside 1 1/4" iron pipe. Painted all B.T.'s red.

New Accessories

Location & Comments

Corner lies on a East
slope about 150' East
of road

Compass Declination 20 1/2
Firm/Agency Roberts
Surveying Inc.
Address 29 West 29th St.
Eugene, Oregon 97405
Party Chief Ted Baker
Notes _____
Witness Norman Hamar

Surveyor's Seal

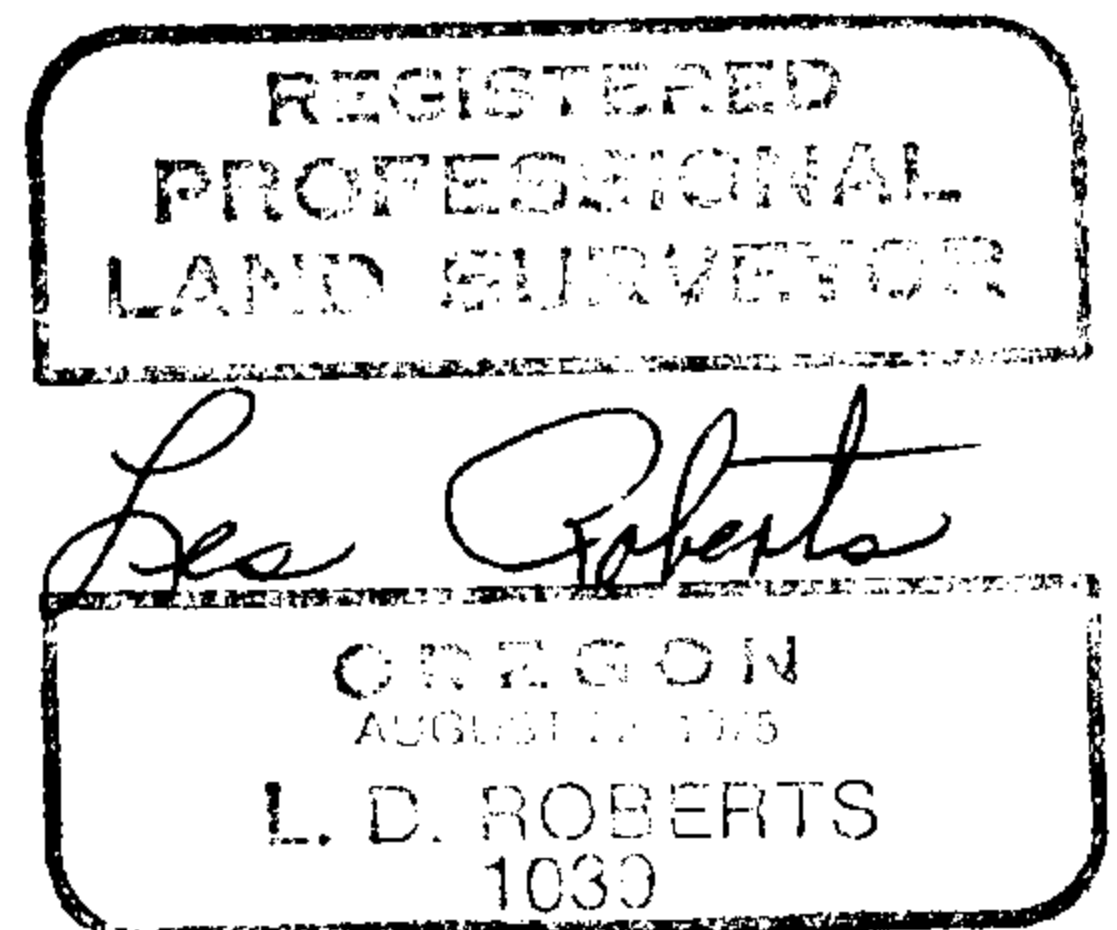

C.S. File No. 63/AC-76

M107-56

OREGON CORNER RESTORATION FORM

Section 5 Township 22S Range 12W

County Douglas Date 01-24-89

CORNER DESIGNATION

South 1/16 Corner
East Line Sec. 5



- Condition Report Only
- Not Found
- Renewed
- Unrecorded
- Surveyed In
- Referenced Out

Previous Renewals/Surveys, etc. Original survey by Harvey Gordon in 1857. C.S. M103-59 by Richard Hintz in 1987.

Monument(s) & Accessories Found: (Condition and Source)

Found 1987 International Paper aluminum rod and cap set in C.S. M103-59.

12" Hemlock, N85W, 6.2' (Scribe Vis.), 1987 BT. Rec. N85W, 6.1'

14" Hemlock, S55E, 12.1' (Scribe Vis.), 1987 BT. Rec. S55E, 12.1'

Monument Detail

Sketch

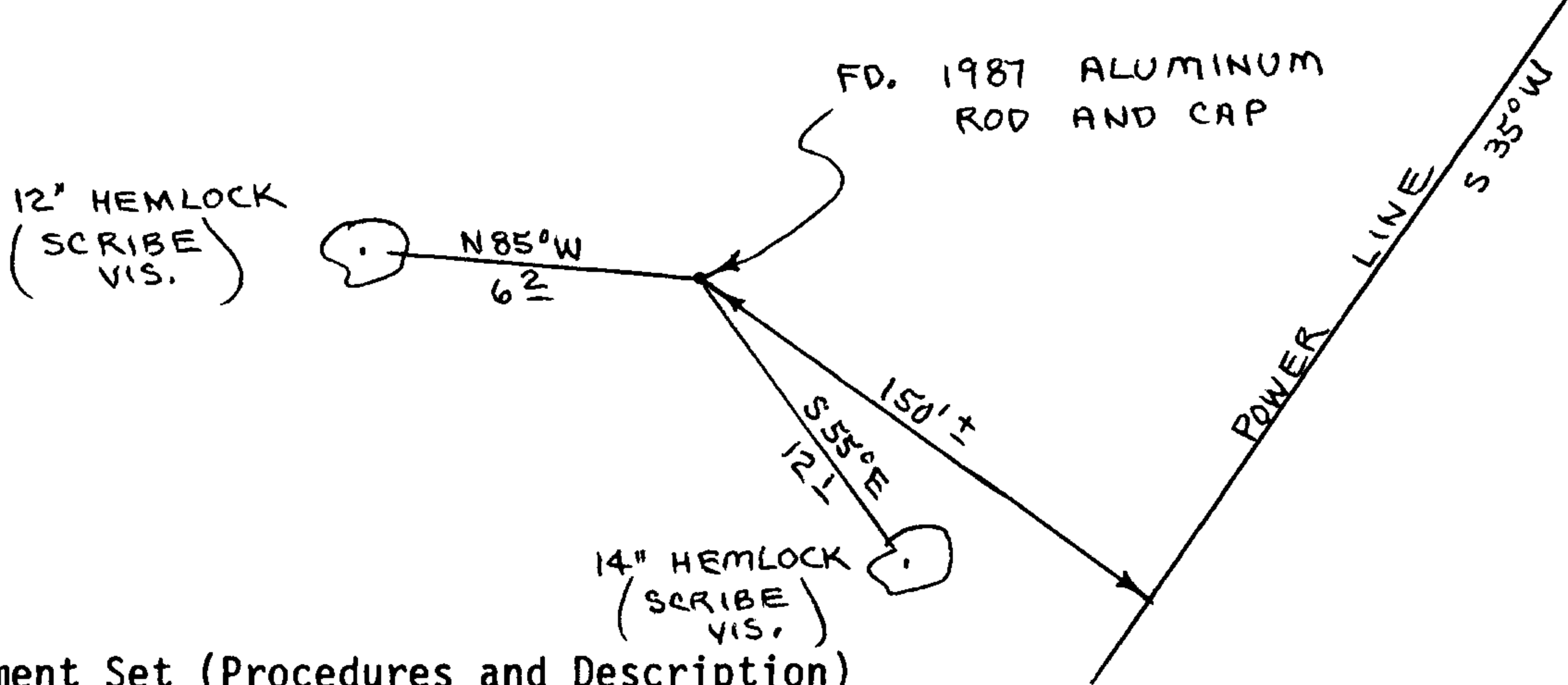

Monument Set (Procedures and Description)

New Accessories

Location & Comments

Corner lies on West Compass Declination 20½
slope about 150' N.W. Firm/Agency Roberts
of power line. Surveying Inc.
Address 29 West 29th St.
Eugene, Oregon 97405
Party Chief Ted Baker
Notes
Witness Norman Hamar

Surveyor's Seal

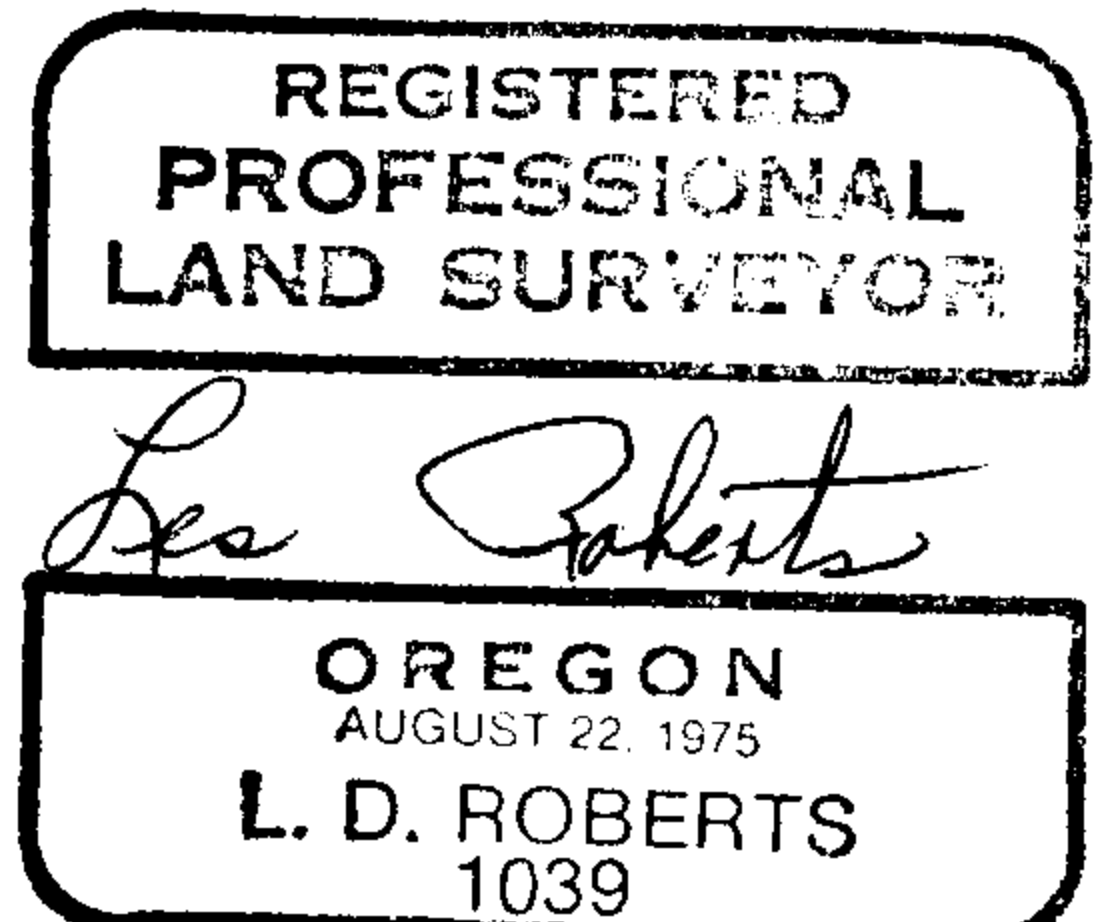

C.S. File No. 63/467

M107-56

OREGON CORNER RESTORATION FORM

Section 5 Township 22S Range 12W

County Douglas Date 01-20-89

CORNER DESIGNATION

East $\frac{1}{4}$ Corner
Section 5

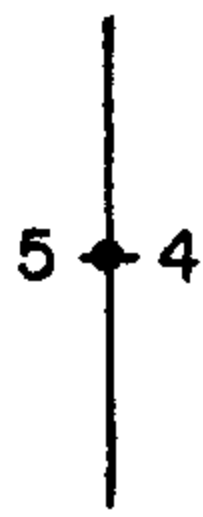

- Condition Report Only
- Not Found
- Renewed
- Unrecorded
- Surveyed In
- Referenced Out

Previous Renewals/Surveys, etc. Original survey by Harvey Gordon in 1857. C.S. M51-65 by Robert Thompson files 12-14-73 and C.S. M94-34 by Richard Hintz dated May 1983.

Monument(s) & Accessories Found: (Condition and Source)

Found 1 1/4" iron pipe set in C.S. M51-65.

48" Fir Stump, S41E, 18.1' (Scar Vis.), 1957 BT. Rec. S40E, 16.5'

20" Double Hem., S43W, 12.5' (Scribe Vis.), 1973 BT. Rec. S44W, 12.5'

28" Hemlock, S82E, 17.4' (Scar Vis.), 1973 BT. Rec. S81 1/2 E, 17.6'

Monument Detail



Sketch

Monument Set (Procedures and Description)

New Accessories

set 60" aluminum post, with land survey monument sign attached to, beside 1 1/4" iron pipe, Painted all B.T.'s red.

Location & Comments

Corner lies on South slope about 50' South of road

Compass Declination 20 1/2

Firm/Agency Roberts Surveying Inc.

Address 29 West 29th St. Eugene, Oregon 97405

Party Chief Ted Baker

Notes _____

Witness Norman Hamar

Surveyor's Seal

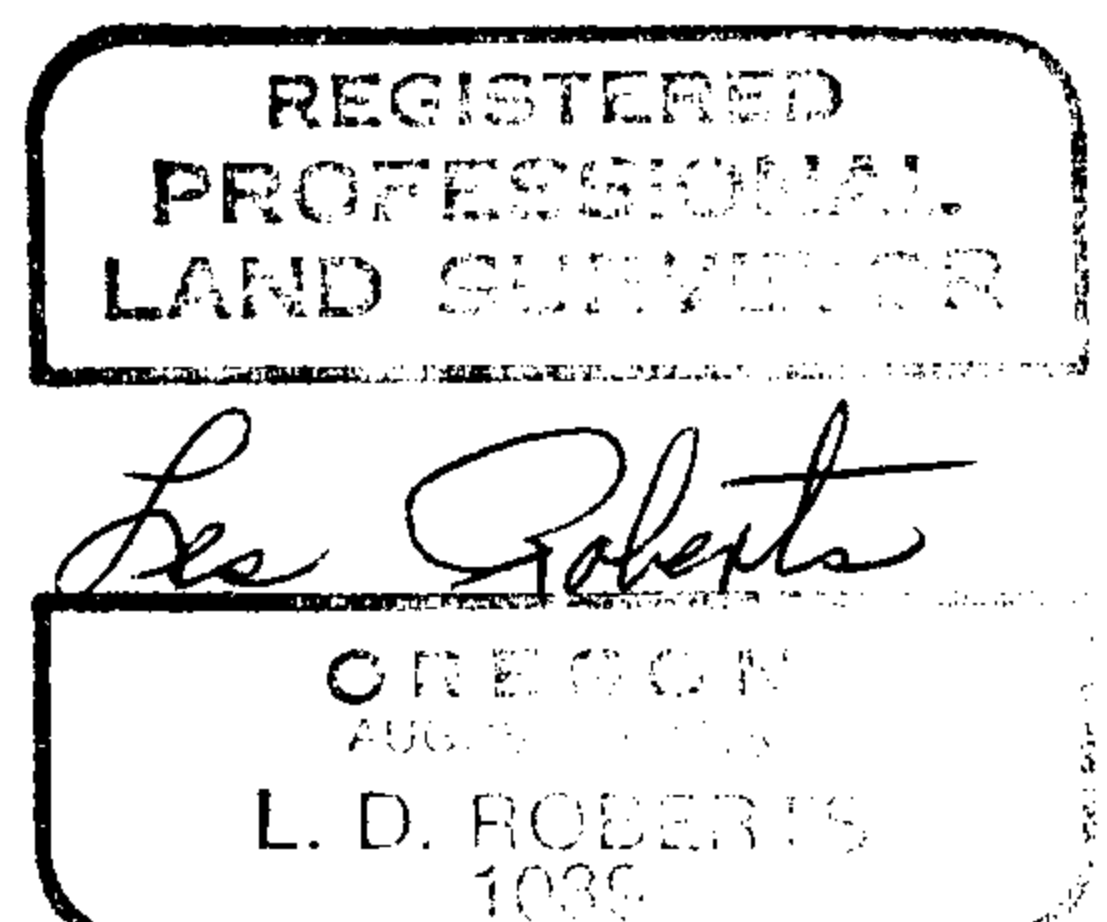

C.S. File No. 63/46-7d

M107-56

OREGON CORNER RESTORATION FORM

Section 5 Township 22S Range 12W

County Douglas Date 01-25-89

CORNER DESIGNATION

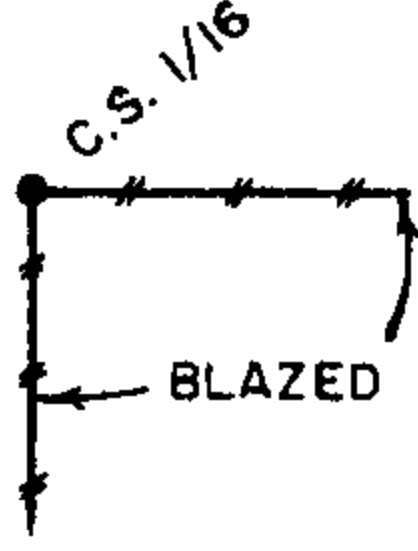

- Condition Report Only
- Not Found
- Renewed
- Unrecorded
- Surveyed In
- Referenced Out

Previous Renewals/Surveys, etc. None

Monument(s) & Accessories Found: (Condition and Source)

None

Monument Detail

Sketch

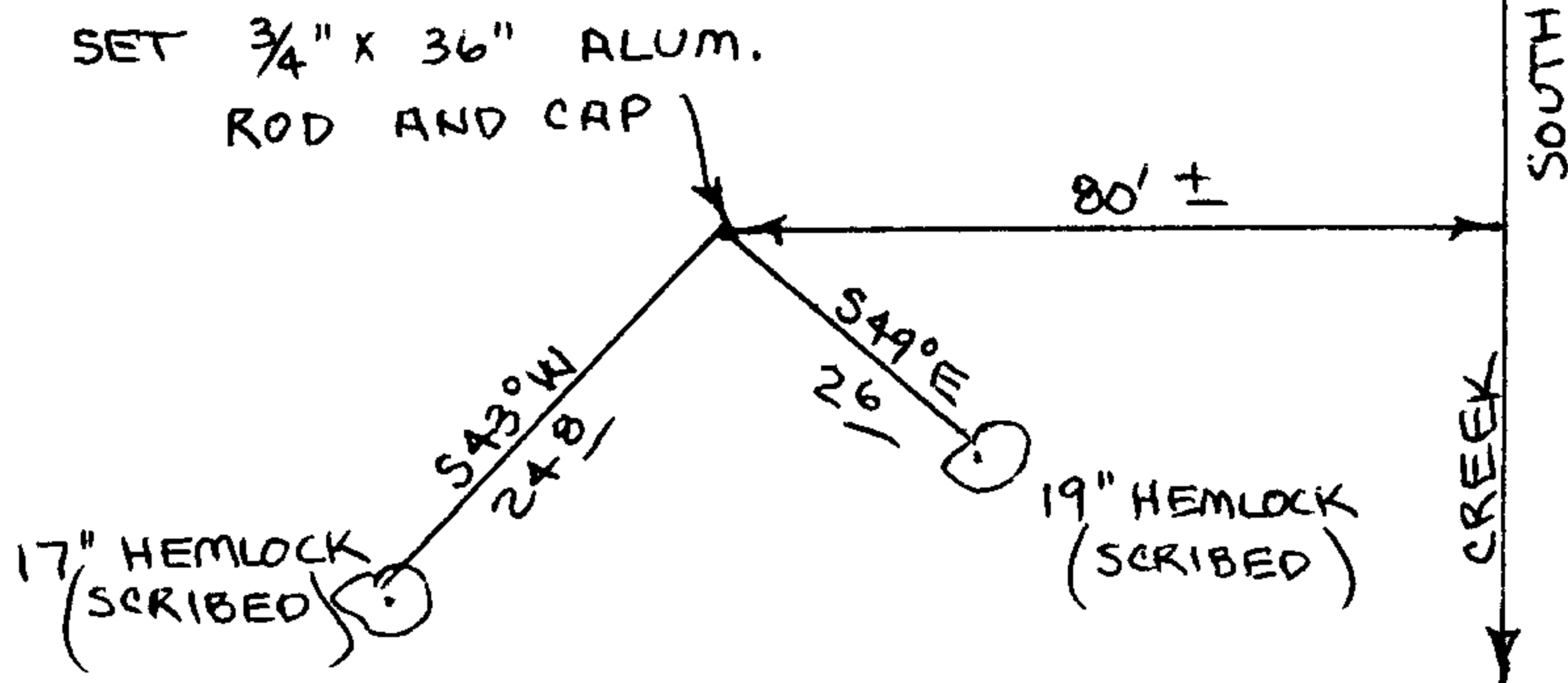

Monument Set (Procedures and Description)

Set 3/4" x 36" aluminum rod with 3/4" aluminum cap. Buried purple magnetic marker under 36" aluminum rod.

17" Hemlock, S43W, 24.8' (Scribed/Painted Red)

19" Hemlock, S49E, 2.6' (Scribed/Painted Red)

See filed survey for survey procedures.

New Accessories

Location & Comments

Corner lies on East

slope about 80 feet

West of Creek. Creek

bears South.

Compass Declination 20 1/2

Firm/Agency Roberts

Surveying Inc.

Address 29 West 29th St.

Eugene, Oregon 97405

Party Chief Ted Baker

Notes _____

Witness Norman Hamar

Surveyor's Seal

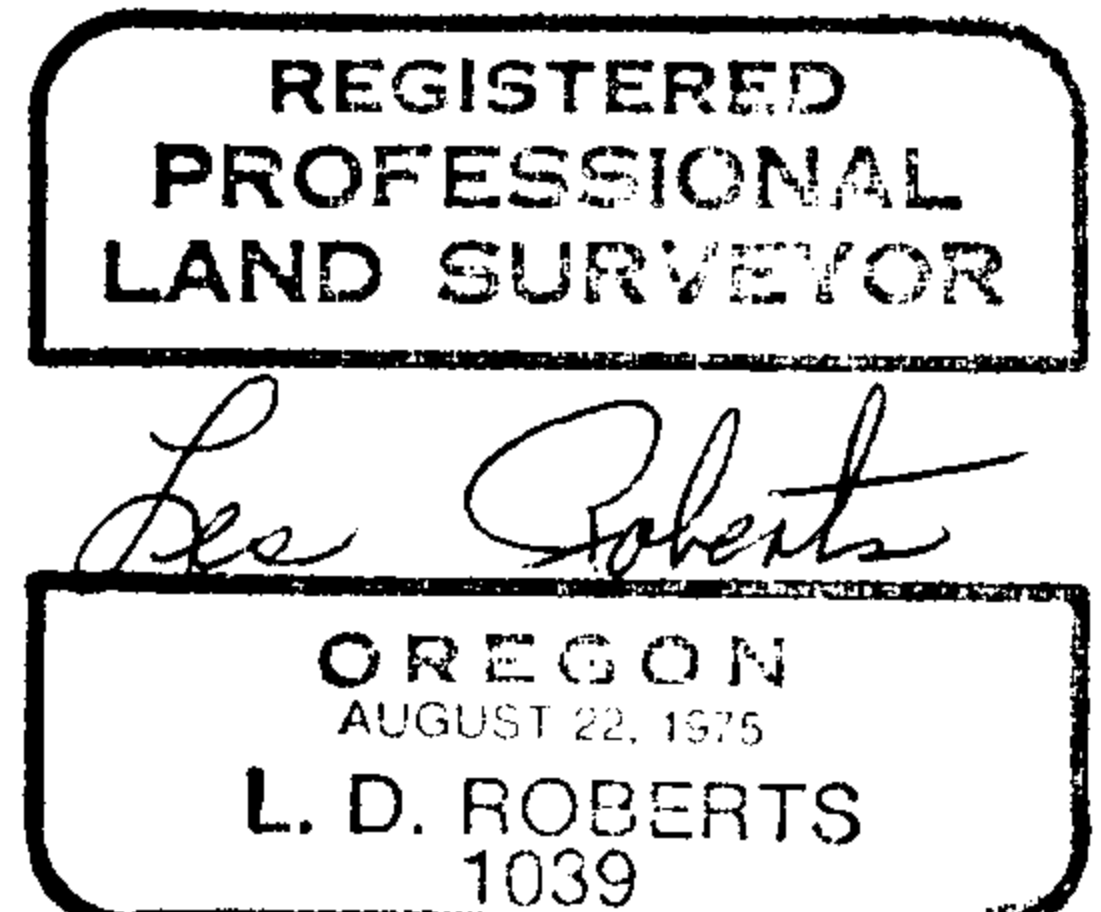

C.S. File No. 63/46-7E

M 107-56

OREGON CORNER RESTORATION FORM

Section 5 Township 22S Range 12W

County Douglas Date 01-25-89

CORNER DESIGNATION

State Highway
R/W Corner

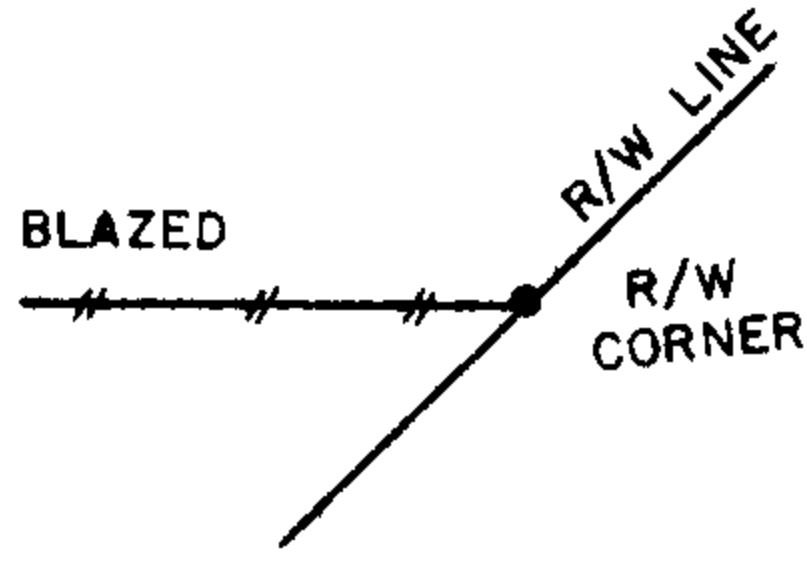

- Condition Report Only
- Not Found
- Renewed
- Unrecorded
- Surveyed In
- Referenced Out

Previous Renewals/Surveys, etc. None

Monument(s) & Accessories Found: (Condition and Source)

None

Monument Detail

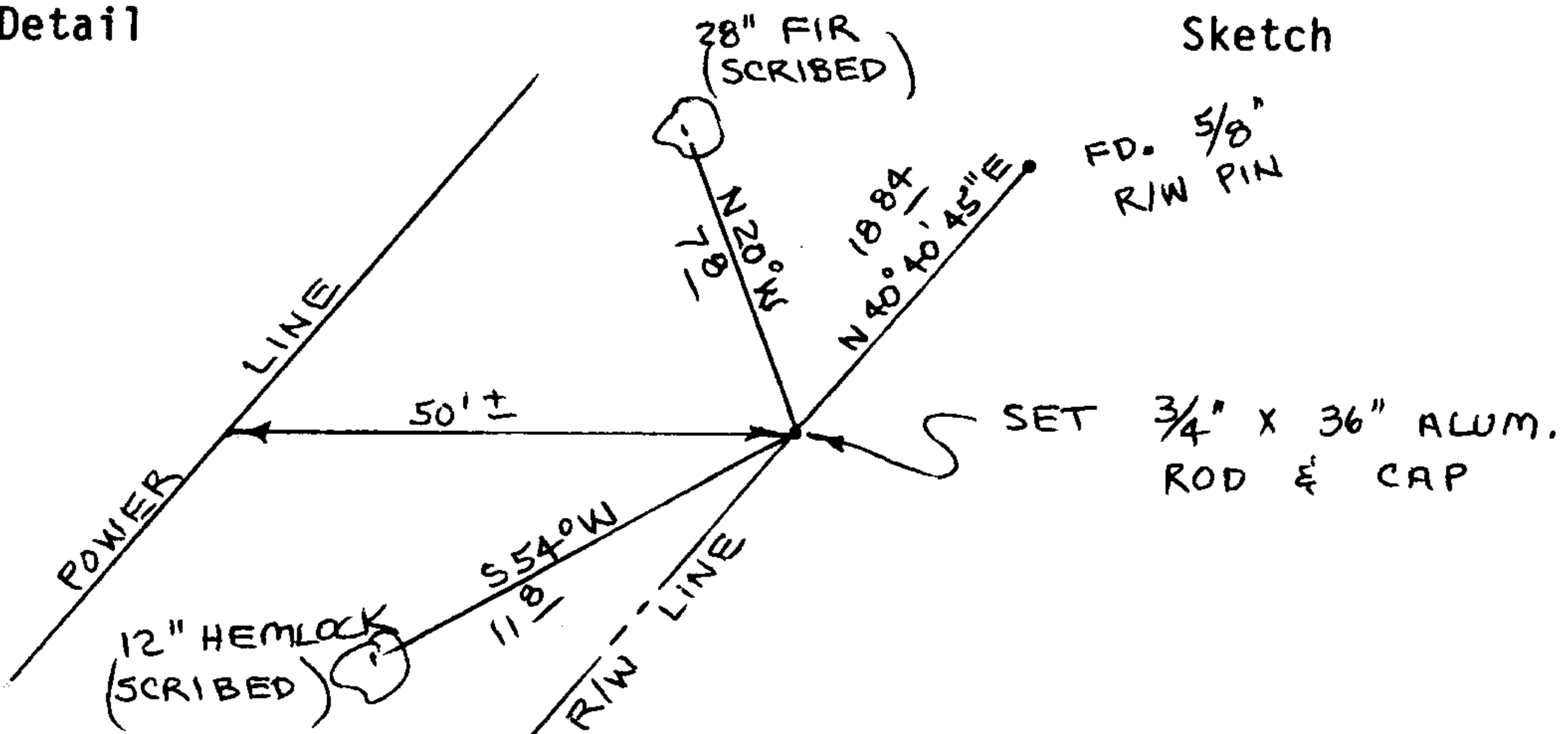

Monument Set (Procedures and Description)

Set 3/4" aluminum rod with 3/4" aluminum cap. Buried purple magnetic marker under 36" aluminum rod.

See files survey for survey procedures.

New Accessories

12" Hemlock, S54W, 11.8' (Scribed/Painted Red)

28" Fir, N20W, 7.8' (Scribed/Painted Red)

Location & Comments

Corner lies on SE slope Compass Declination 20 1/2

about 50' East of power Firm/Agency Roberts

line Surveying Inc.

Address 29 West 29th St.

Eugene, Oregon 97405

Party Chief Ted Baker

Notes _____

Witness Norman Hamar

Surveyor's Seal

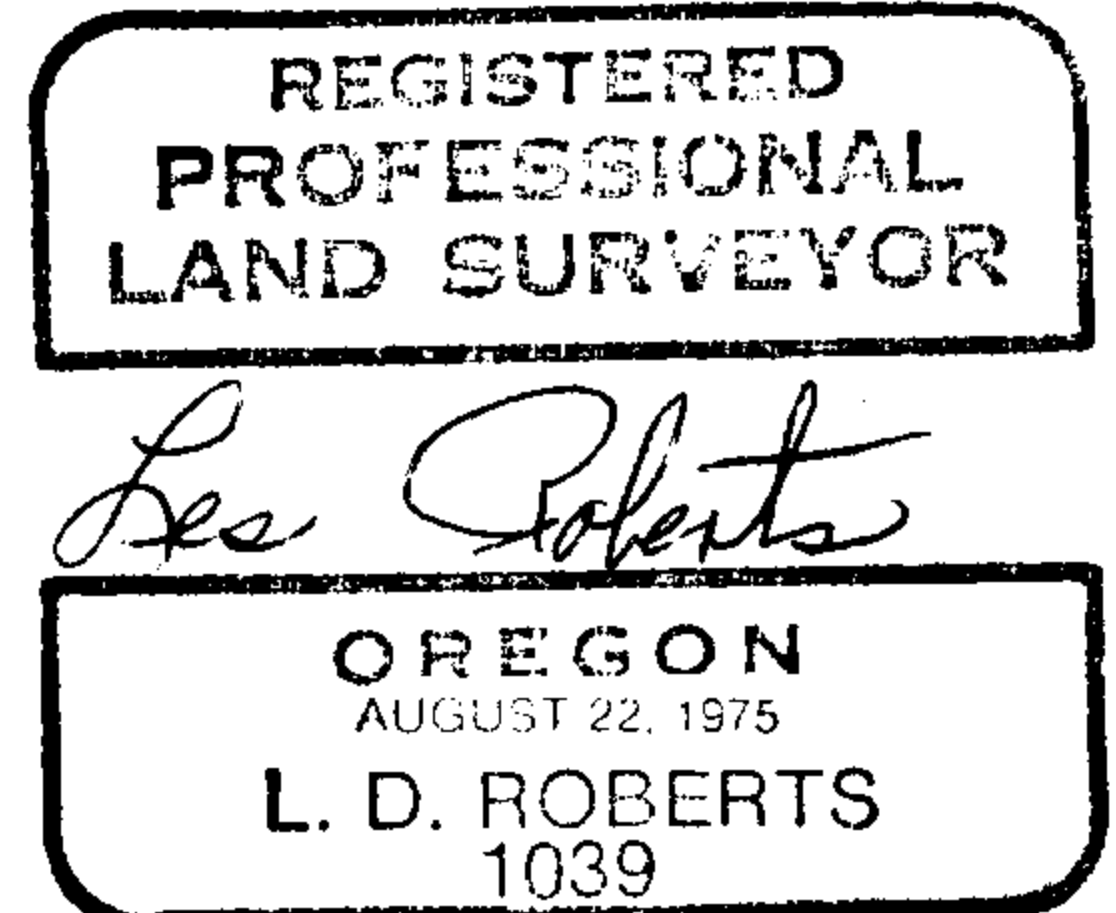

C.S. File No. 63/46-7F

M107-56

OREGON CORNER RESTORATION FORM

Section 5 Township 22S Range 12W

County Douglas Date 01-23-89

CORNER DESIGNATION

South $\frac{1}{4}$ Corner
Section 5

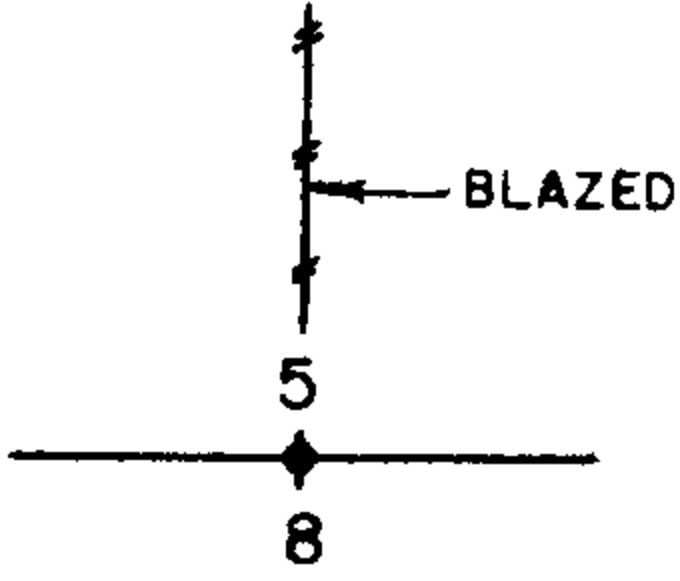

- Condition Report Only
- Not Found
- Renewed
- Unrecorded
- Surveyed In
- Referenced Out

Previous Renewals/Surveys, etc. Original G.L.O. Survey by Harvey Gordon in 1957 and C.S. M94-34 by Richard Hintz dated May 1983.
Also Douglas County Renewal C.S. 58/140 dated May 1983.

Monument(s) & Accessories Found: (Condition and Source)

Found 1 1/4" iron pipe and brass cap set in C.S. M94-34.

20" Spruce, N51E, 11.9' (Scribe Vis.), 1983 BT. Rec. N51 1/2"E, 11.8'

22" Fir, S20E, 24.2' (Scribe Vis.), 1983 BT. Rec. S21E, 24.1'

Monument Detail

Sketch

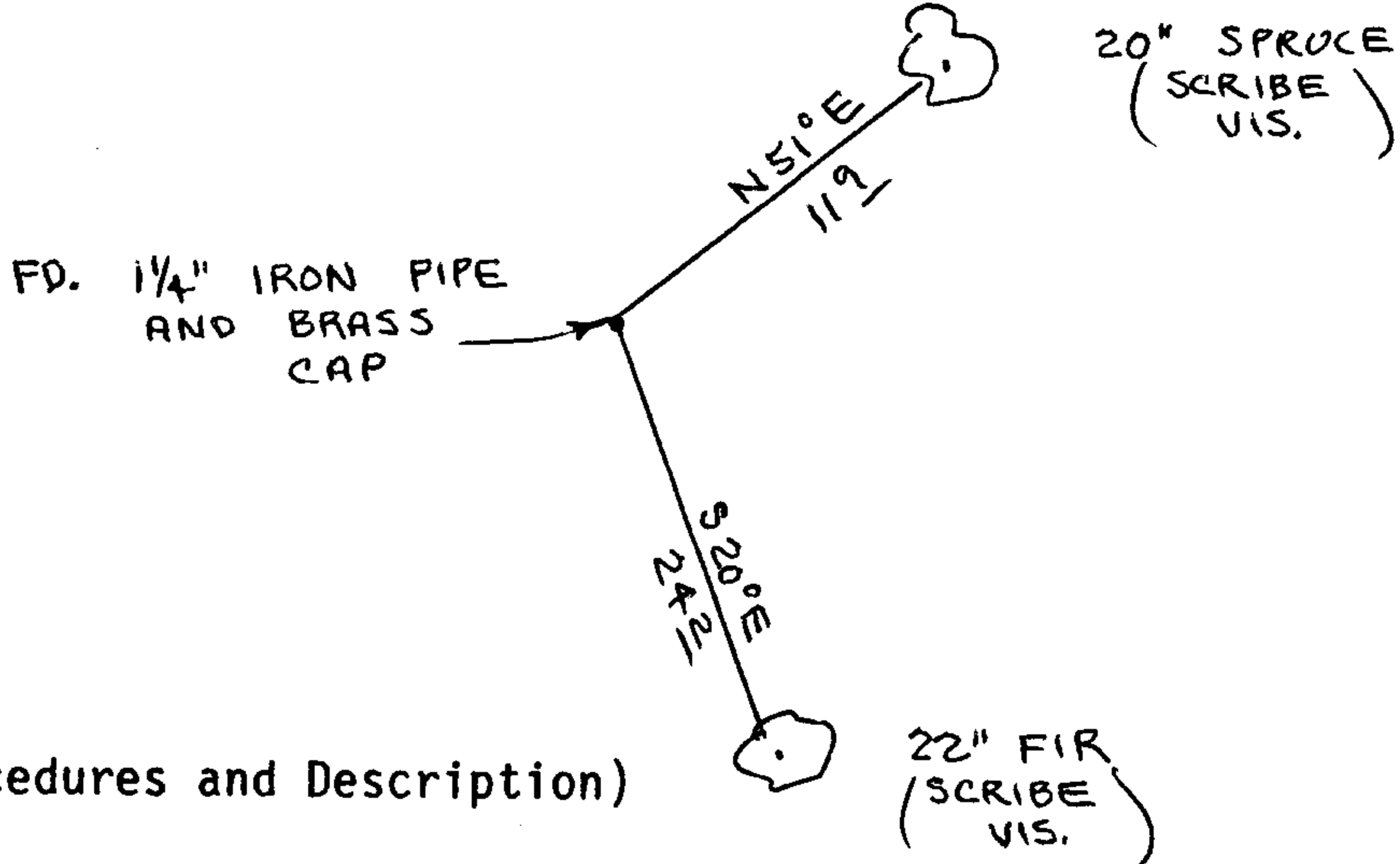

Monument Set (Procedures and Description)

New Accessories

Location & Comments

Surveyor's Seal

Compass Declination 20 1/2
 Firm/Agency Roberts Surveying Inc.
 Address 29 West 29th St.
Eugene, Oregon 97405
 Party Chief Ted Baker
 Notes _____
 Witness Norman Hamar

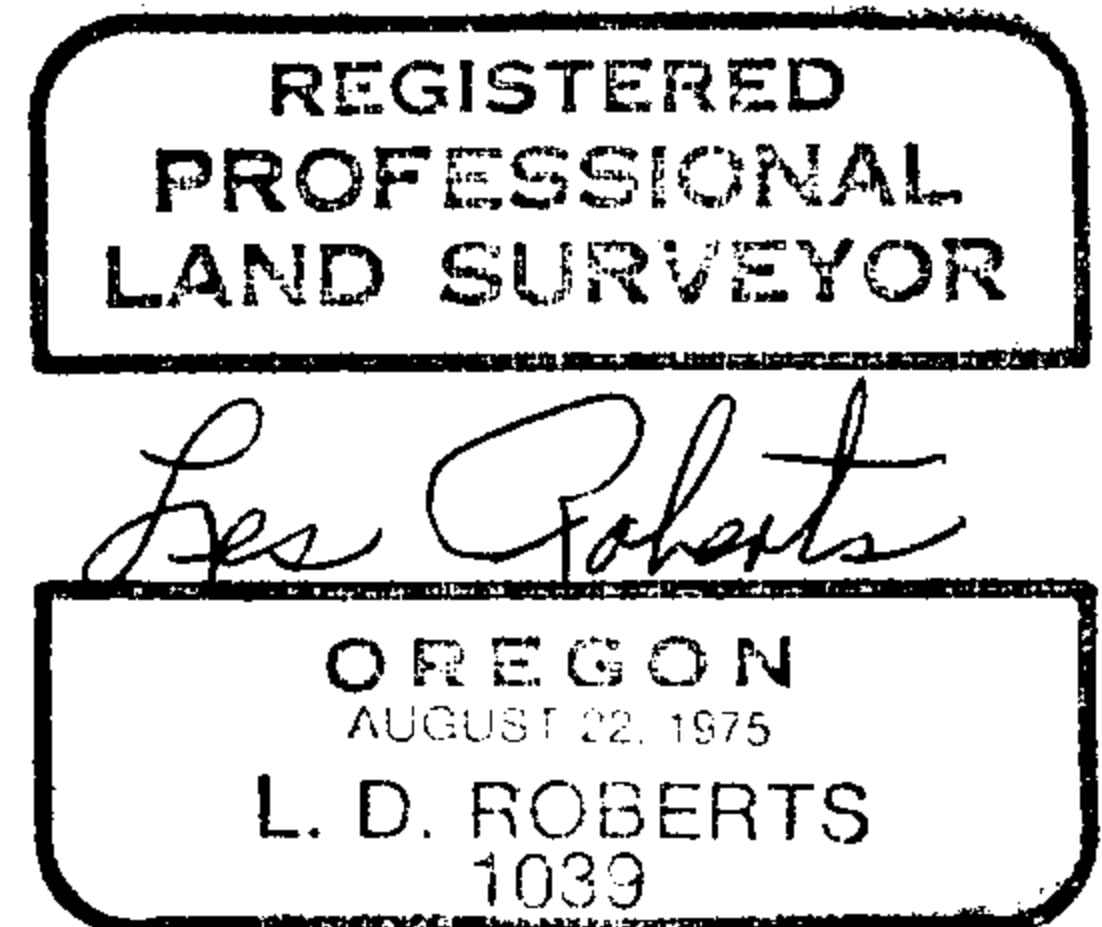

C.S. File No. 63/46-76