

M103-37

FILED

FEB 13 1987 TF

OREGON CORNER RESTORATION FORM

Section 10 Township 25S Range 8W

County Douglas Date 11-21-86

COUNTY SURVEYOR  
DOUGLAS COUNTY, ORE.

Corner Designation

North 1/16 Corner  
Section 10

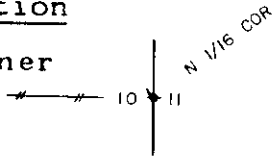

- Condition Report Only
- Not Found
- Renewed
- Unrecorded
- Surveyed In
- Referenced Out

Previous Renewals/Surveys, etc. Original Survey by S.C. Flint in 1881. Resurvey by Morris Wygant in 1911. B.L.M. Cadastral survey James Jelley in 1979.

Monument(s) & Accessories Found: (Condition and Source)

Found 1979 B.L.M. Brass Cap set firmly in the ground.

10" Fir, N17E, 43.3' (Scar Vis.), 1979 BT. Record N17E, 43.6'

20" Fir, S35W, 21.3' (Scar Vis.), 1979 BT. Record S34 1/2 W, 21.1'

Monument Detail

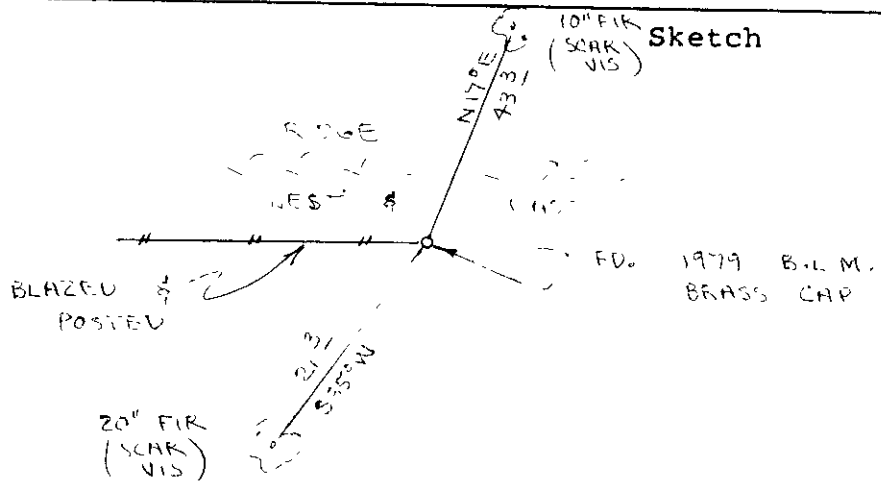

Monument Set (Procedures and Description)

\_\_\_\_\_  
\_\_\_\_\_  
\_\_\_\_\_

New Accessories

Set fence post, with survey attention sign wired to, beside brass cap. Painted B.T.'s red.

Location & Comments

Corner lies on top of flat ridge. Ridge bears East-West. Compass Declination 20 1/2  
Firm/Agency Roberts Surveying Inc.  
Address 29 West 29th St. Eugene, Oregon 97405  
Party Chief Les Roberts  
Notes Ted Baker  
Witness Jim Metzler

Surveyor's Seal

REGISTERED  
PROFESSIONAL  
LAND SURVEYOR

OREGON  
AUG 21 1975  
L. D. ROBERTS  
1039

M103-37

FILED

*TF*

FEB 13 1987

OREGON CORNER RESTORATION FORM

Section 10 Township 25S Range 8W

County Douglas Date 12-11-86

COUNTY SURVEYOR  
DOUGLAS COUNTY, ORE. *TF*

Corner Designation

South  $\frac{1}{4}$  Corner  
Section 10

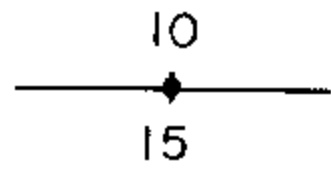

- Condition Report Only
- Not Found
- Renewed
- Unrecorded
- Surveyed In
- Referenced Out

Previous Renewals/Surveys, etc. Original survey by S.C. Flint in 1881. Resurvey by Morris Wygant in 1911. B.L.M. Cadastral resurvey in 1979.

Monument(s) & Accessories Found: (Condition and Source)

Found 1979 B.L.M. Brass Cap set firmly in the ground.

11" Fir, S20W, 28.0' (Scar Vis.), 1979 BT. Record S19W, 28.4'

13" Fir, N59W, 11.8' (Scar Vis.), 1979 BT. Record N59W, 11.9'

Monument Detail

Sketch

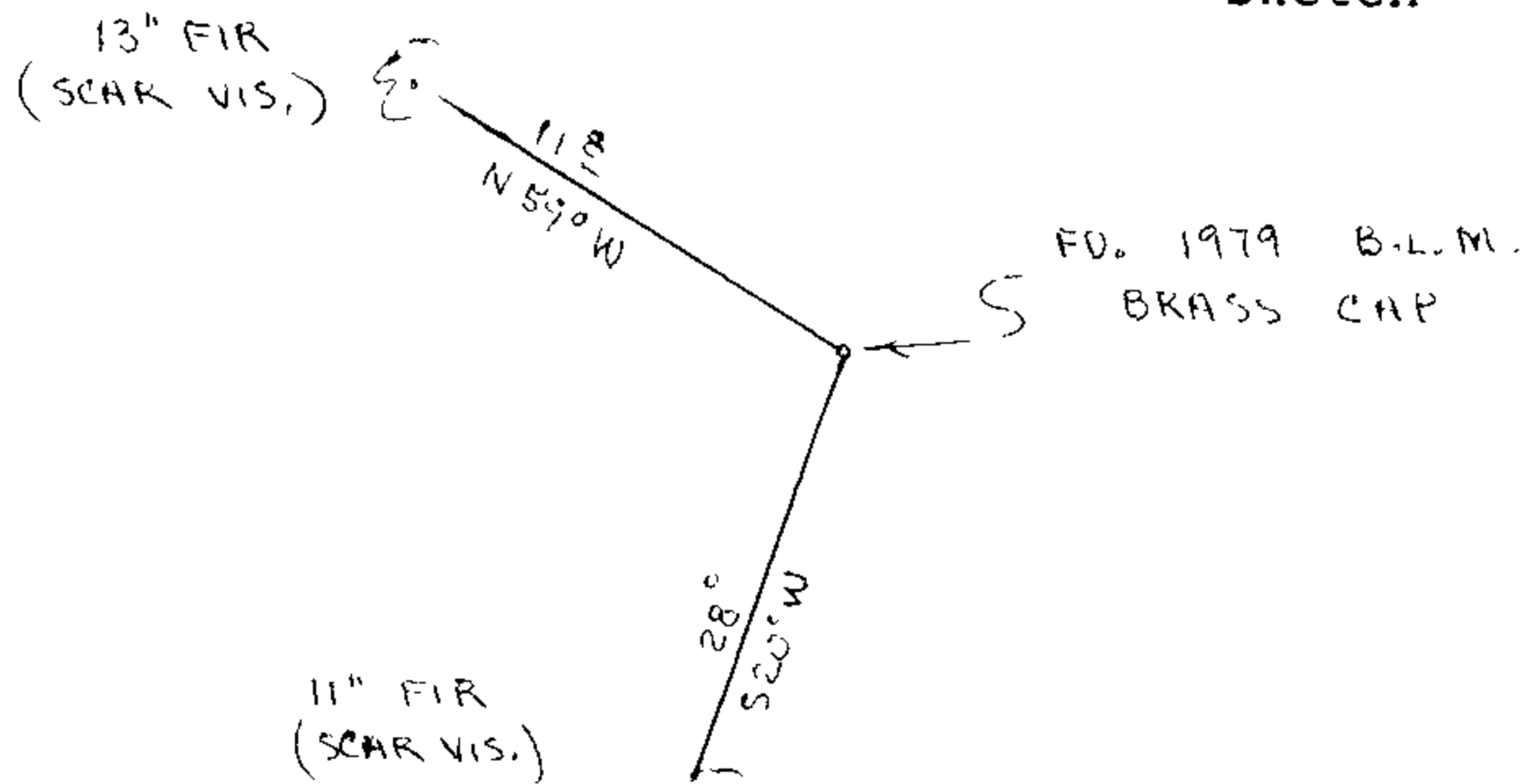

Monument Set (Procedures and Description)

New Accessories

Set fence post, with survey attention sign wired to, beside brass cap. Painted B.T.'s Red.

Location & Comments

Compass Declination 20 $\frac{1}{2}$   
 Firm/Agency Roberts  
Surveying Inc.  
 Address 29 West 29th St.  
Eugene, Oregon 97405  
 Party Chief Ted Baker  
 Notes Ted Baker  
 Witness Jim Metzler

Surveyor's Seal

REGISTERED  
PROFESSIONAL  
LAND SURVEYOR

*L.D. Roberts*  
OREGON  
AUGUST  
L. D. ROBERTS  
1039

M103-37

FILED *jh*

FEB 13 1987 *TF*

OREGON CORNER RESTORATION FORM

Section 10 Township 25S Range 8W

County Douglas Date 12-15-86

COUNTY SURVEYOR  
DOUGLAS COUNTY, ORE. *TF*

Corner Designation

South 1/16 Corner  
Section 10

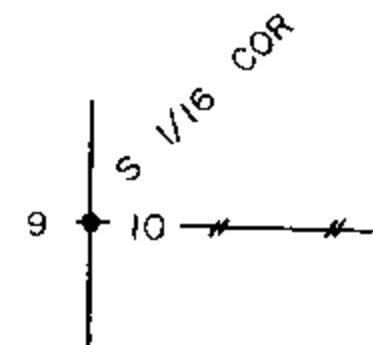

- Condition Report Only
- Not Found
- Renewed
- Unrecorded
- Surveyed In
- Referenced Out

Previous Renewals/Surveys, etc. Original Survey by Morris Wygant in 1911. Resurvey by James Jelley in 1979.

Monument(s) & Accessories Found: (Condition and Source)  
Found 1979 B.L.M. Brass Cap set firmly in ground.

7" Fir, N35W, 11.0' (Scribe Vis.), 1979 BT. Record N34W, 11.2'

12" Fir, S78E, 11.0' (Scar Vis.), 1979 BT. Record S79 1/2 E, 13.2'

Monument Detail

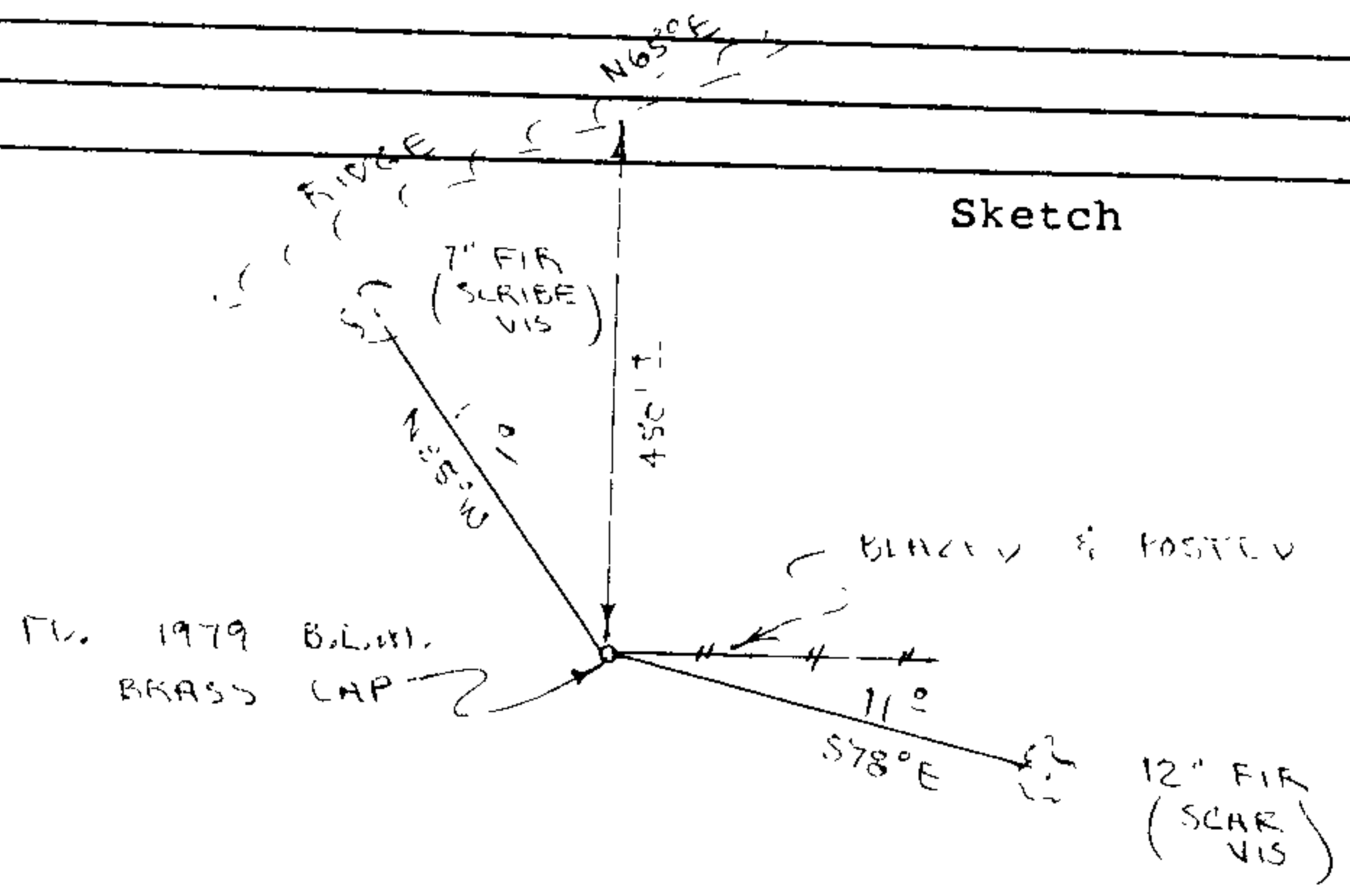

Sketch

Monument Set (Procedures and Description)

New Accessories

Set fence post, with survey attention sign wired to, beside brass cap. Painted B.T.'s Red.

Location & Comments

Corner lies about 450' South of ridge top. Ridge bears N65E and S65W

Compass Declination 20 1/2

Firm/Agency Roberts Surveying Inc.

Address 29 West 29th St. Eugene, Oregon 97405

Party Chief Ted Baker

Notes Ted Baker

Witness Jim Metzler

Surveyor's Seal

REGISTERED  
PROFESSIONAL  
LAND SURVEYOR

*L.D. Roberts*  
OREGON  
L. D. ROBERTS  
1039

C.S. File No. 63/46-20

M103-37

FILED

FEB 13 1987 TF

OREGON CORNER RESTORATION FORM

Section 10 Township 25S Range 8W

COUNTY SURVEYOR  
DOUGLAS COUNTY, ORE. TF

County Douglas Date 11-21-86

Corner Designation

East  $\frac{1}{4}$  Corner  
Section 10

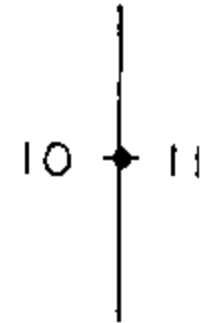

- Condition Report Only
- Not Found
- Renewed
- Unrecorded
- Surveyed In
- Referenced Out

Previous Renewals/Surveys, etc. Original Survey by S.C. Flint in 1881. Resurvey by Morris Wygant in 1911. B.L.M. Cadastral resurvey in 1979. Douglas County renewal #37 in 1967.

Monument(s) & Accessories Found: (Condition and Source)

Found 1979 B.L.M. Brass Cap set firmly in the ground.  
1967 Douglas County Brass Cap bears S 42° 57' 15" E, 18.2'.  
36" Fir Snag, S47E, 100.00' (no marks), 1911 BT. Rec. S47E, 101.0'  
11" Fir, S69W, 9.7' (Scar Vis.), 1979 BT. Rec. S693/4W, 9.6'  
14" Fir, N83E, 4.3' (Scar Vis.), 1979 BT. Rec. N83 $\frac{1}{4}$ E, 4.0'

Monument Detail

Sketch

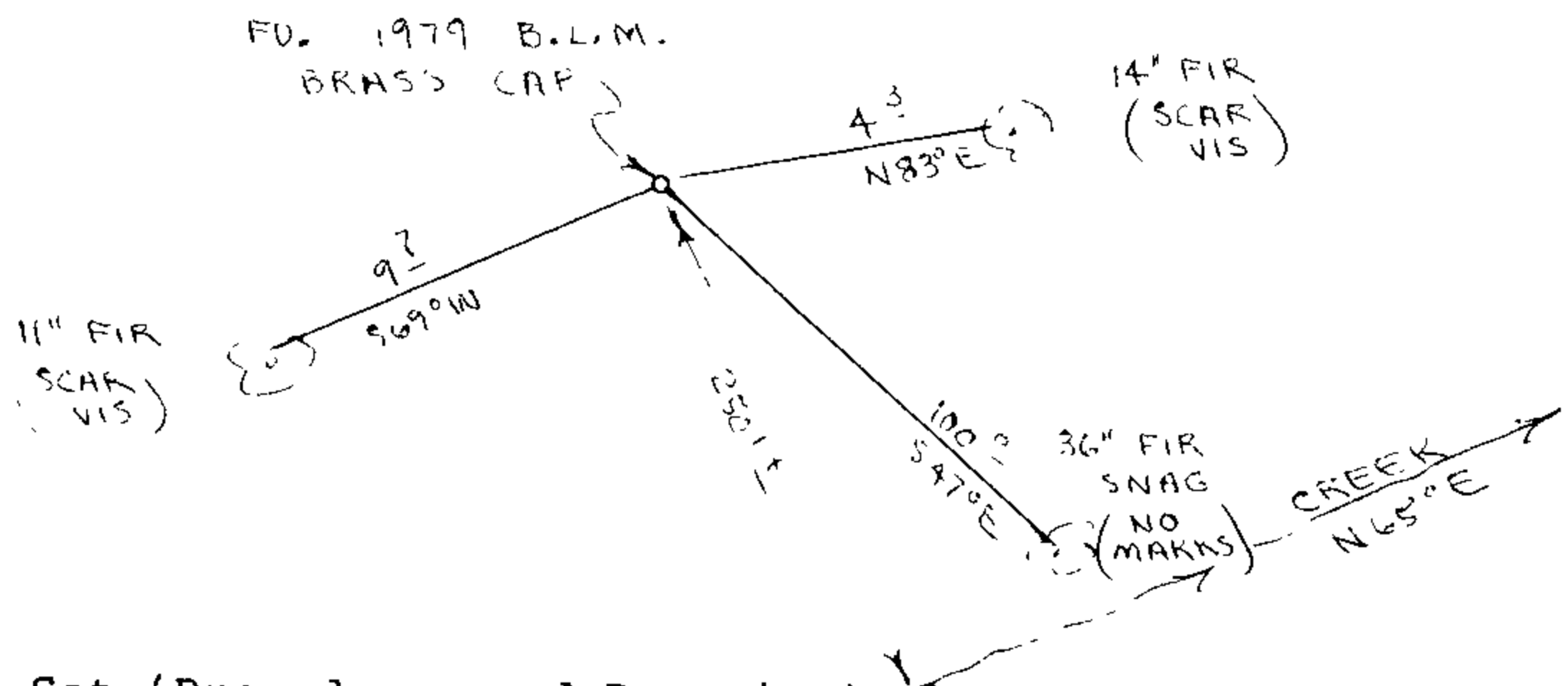

Monument Set (Procedures and Description)

Set metal fence post, with survey attention sign wired to, beside brass cap. Painted B.T.'s Red.

New Accessories

Location & Comments

Corner lies on S.E. slope about 250' above creek. Creek runs N65E  
Compass Declination 20 $\frac{1}{2}$   
Firm/Agency Roberts Surveying Inc.  
Address 29 West 29th St. Eugene, Oregon 97405  
Party Chief Les Roberts  
Notes Ted Baker  
Witness Jim Metzler

Surveyor's Seal

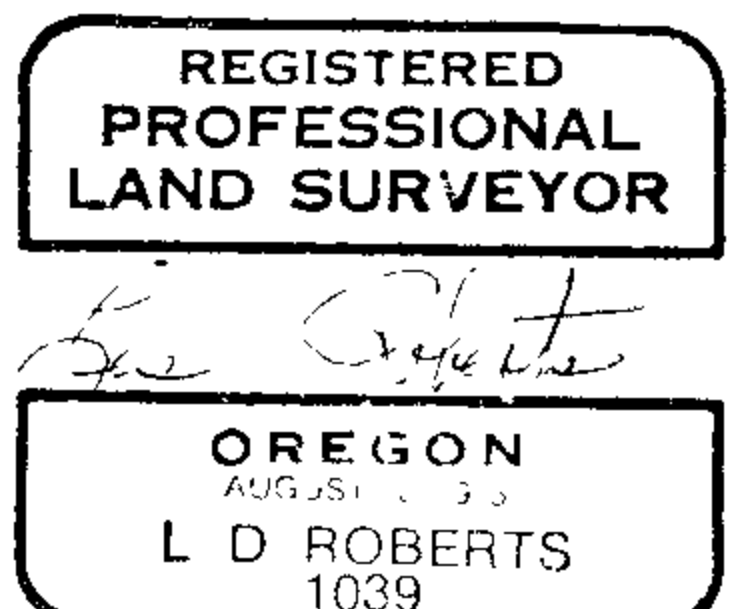

M 103-37

FILED

*[Signature]*

FEB 13 1987 TF

OREGON CORNER RESTORATION FORM

Section 10 Township 25S Range 8W

County Douglas Date 12-16-86

COUNTY SURVEYOR  
DOUGLAS COUNTY, ORE. TF

Corner Designation

West  $\frac{1}{4}$  Corner  
Section 10

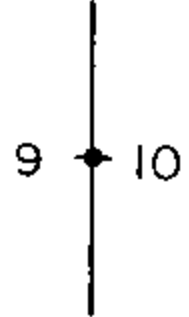

- Condition Report Only
- Not Found
- Renewed
- Unrecorded
- Surveyed In
- Referenced Out

Previous Renewals/Surveys, etc. Original Survey by Morris Wygant in 1911. Douglas County renewal #39 in 1967. B.L.M. Cadastral resurvey in 1979.

Monument(s) & Accessories Found: (Condition and Source)

Found 1967 Douglas County Brass Cap set firmly in ground.

- 48" Downed Fir, N53W, 24.5' (Scar Vis.), 1911 BT. Rec. N53W, 24.4'
- 48" Fir, N47E, 21.2' (Scar Vis.), 1911 BT. Rec. N45E, 23.1'
- 11" Fir, N70E, 22.5' (Scar Vis.), 1967 BT. Rec. N71E, 23.5'
- 7" Fir, S09W, 7.6' (Scar Vis.), 1967 BT. Rec. S09W, 7.7'

Monument Detail

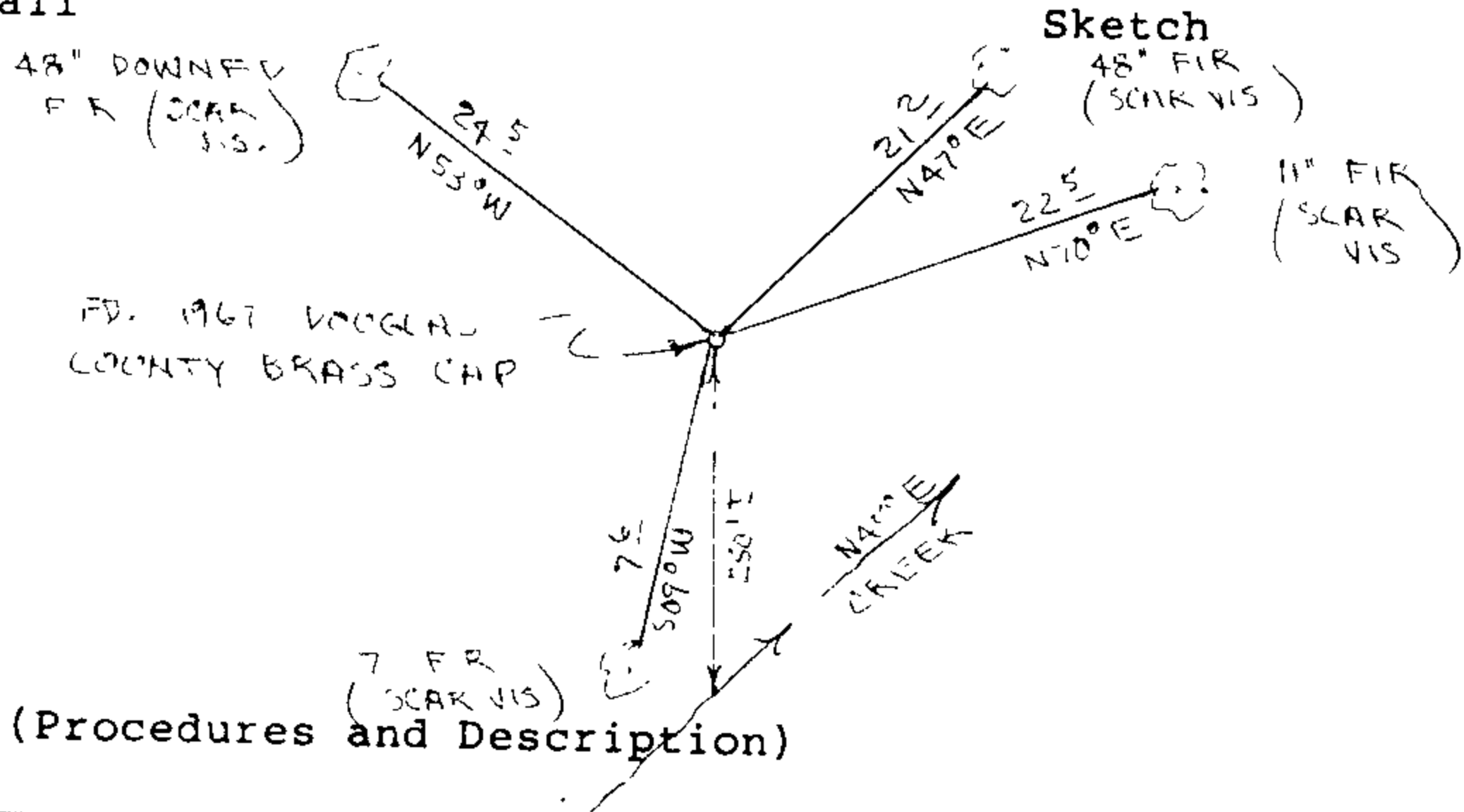

Monument Set (Procedures and Description)

\_\_\_\_\_  
\_\_\_\_\_  
\_\_\_\_\_

New Accessories

Set fence post, with survey attention sign wired to, beside brass cap. Painted B.T.'s red.

Location & Comments

Corner lies on steep East slope about 250' North of small creek. Creek bears N45E

Compass Declination  $20\frac{1}{2}$

Firm/Agency Roberts Surveying Inc.

Address 29 West 29th St. Eugene, Oregon 97405

Party Chief Ted Baker

Notes Ted Baker

Witness Jim Metzler

Surveyor's Seal

REGISTERED PROFESSIONAL LAND SURVEYOR

*[Signature]*

OREGON  
AUG. 12, 1975  
L D ROBERTS  
1039

M103-37

FILED *✓*

OREGON CORNER RESTORATION FORM

FEB 13 1987 *TF*

Section 10 Township 25S Range 8W

COUNTY SURVEYOR  
DOUGLAS COUNTY, ORE *TF*

County Douglas Date 12-04-86

Corner Designation

North  $\frac{1}{4}$  Corner  
Section 10

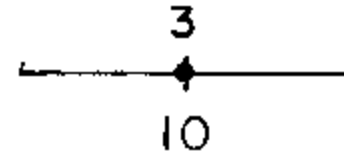

- Condition Report Only
- Not Found
- Renewed
- Unrecorded
- Surveyed In
- Referenced Out

Previous Renewals/Surveys, etc. Original Survey by Morris Wygant in 1911. Douglas County renewal #38 in 1967. B.L.M. Cadastral resurvey in 1979.

Monument(s) & Accessories Found: (Condition and Source)

Found 1967 Douglas County Brass Cap set firmly in the ground.

8" Fir Stub, N33W, 6.5' (Scribe Vis.), 1967 BT. Rec. N33W, 6.7'  
20" Fir, S25E, 6.5' (Scar Vis.), 1967 BT. Rec. S27E, 6.1'  
7" Fir, N49W, 14.6' (Scar Vis.), 1979 BT. Rec. N48 $\frac{1}{2}$ W, 15.2'

Monument Detail

Sketch

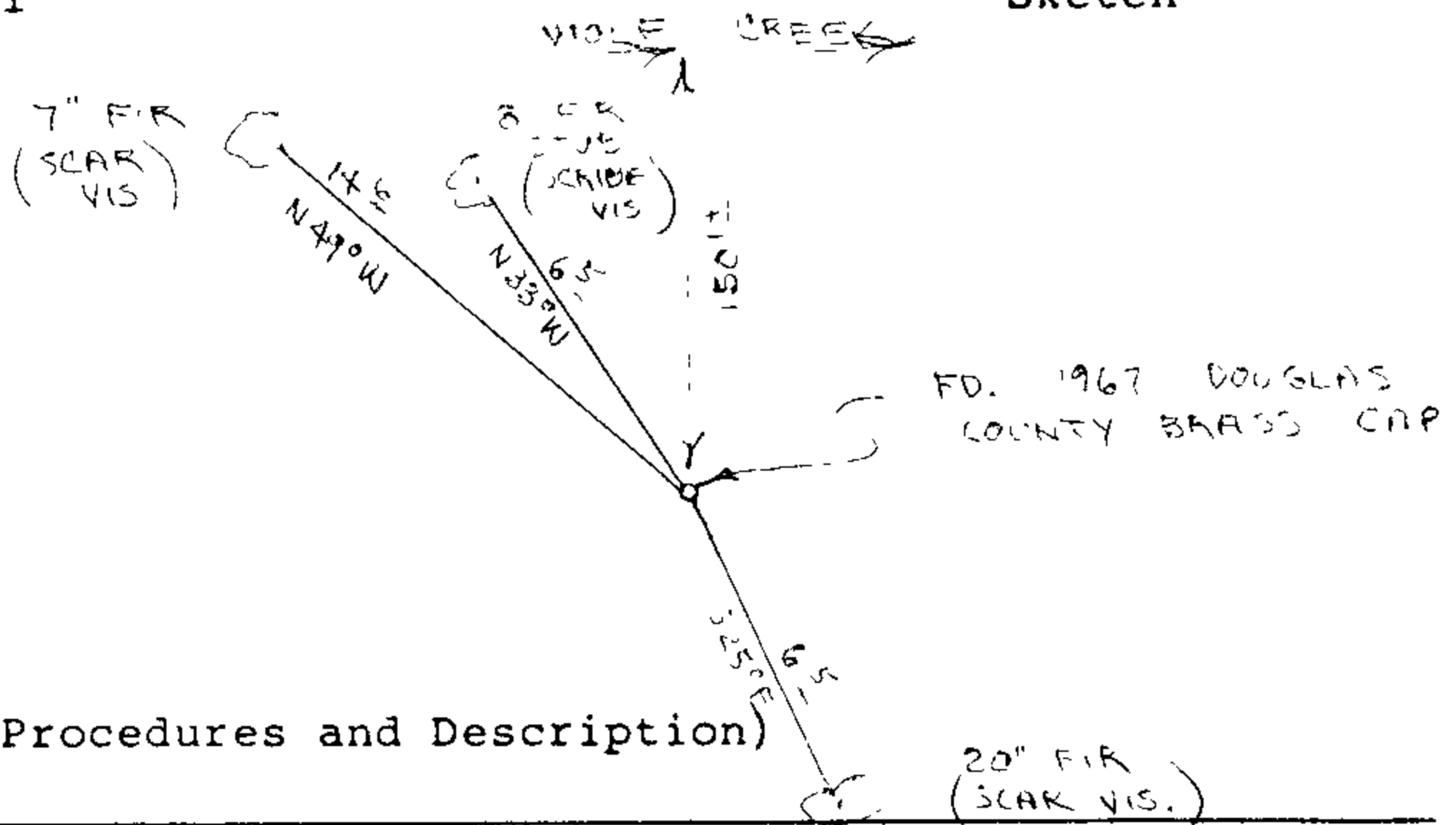

Monument Set (Procedures and Description)

New Accessories

Set fence post, with survey attention sign wired to, beside brass cap. Painted B.T.'s red.

Location & Comments

Surveyor's Seal

Corner lies on steep North slope about 150' South of Little Wolf Creek  
Compass Declination 20 $\frac{1}{2}$   
Firm/Agency Roberts Surveying Inc.  
Address 29 West 29th St. Eugene, Oregon 97405  
Party Chief Ted Baker  
Notes Ted Baker  
Witness Jim Metzler

REGISTERED  
PROFESSIONAL  
LAND SURVEYOR

*L.D. Roberts*  
 OREGON  
 AUGUST 27 1955  
 L D ROBERTS  
 1039

C.S. File No. 63/16-2F

M103-37

FILED *SL*

OREGON CORNER RESTORATION FORM

FEB 13 1987 TF

Section 10 Township 25S Range 8W

County Douglas Date 12-19-86

COUNTY SURVEYOR  
DOUGLAS COUNTY, ORE TF

Corner Designation  
C.N. 1/16 Corner  
Section 10



- Condition Report Only
- Not Found
- Renewed
- Unrecorded
- Surveyed In
- Referenced Out

Previous Renewals/Surveys, etc. None

Monument(s) & Accessories Found: (Condition and Source)  
None

Monument Detail

Sketch

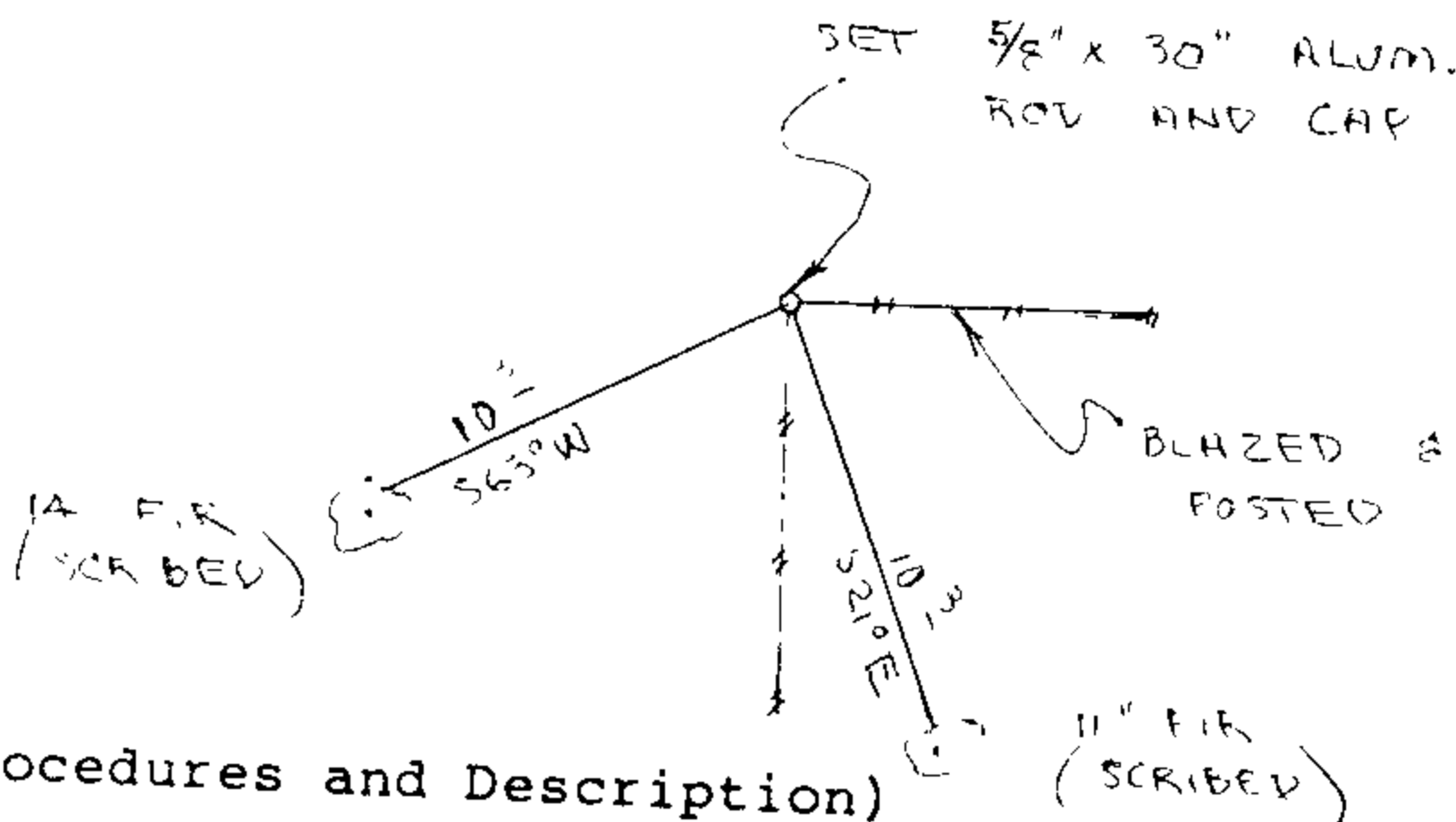

Monument Set (Procedures and Description)

Set 5/8" x 30" Aluminum rod and cap. Buried purple magnetic marker under 30" rod. See filed survey for procedures.

New Accessories

- 11" Fir, S21E, 10.3' (Scribed/Washer/Painted Red)
- 14" Fir, S63W, 10.3' (Scribed/Washer/Painted Red)
- Set fence post, with land survey monument sign wired to, beside aluminum cap.

Location & Comments

Corner lies on N.E. slope about 120' West of small draw. Draw bears N20E

Compass Declination 20 1/2

Firm/Agency Roberts Surveying Inc.

Address 29 West 29th St. Eugene, Oregon 97405

Party Chief Ted Baker

Notes Ted Baker

Witness Jim Metzler

Surveyor's Seal



C.S. File No. 63/46-29

M103-37

FILED

FEB 13 1987 TF

OREGON CORNER RESTORATION FORM

Section 10 Township 25S Range 8W

County Douglas Date 12-22-86

COUNTY SURVEYOR  
DOUGLAS COUNTY, ORE. TF

Corner Designation

Center  $\frac{1}{4}$  Corner  
Section 10

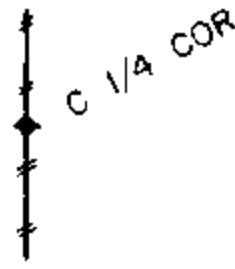

- Condition Report Only
- Not Found
- Renewed
- Unrecorded
- Surveyed In
- Referenced Out

Previous Renewals/Surveys, etc. None

Monument(s) & Accessories Found: (Condition and Source)

None

Monument Detail

Sketch

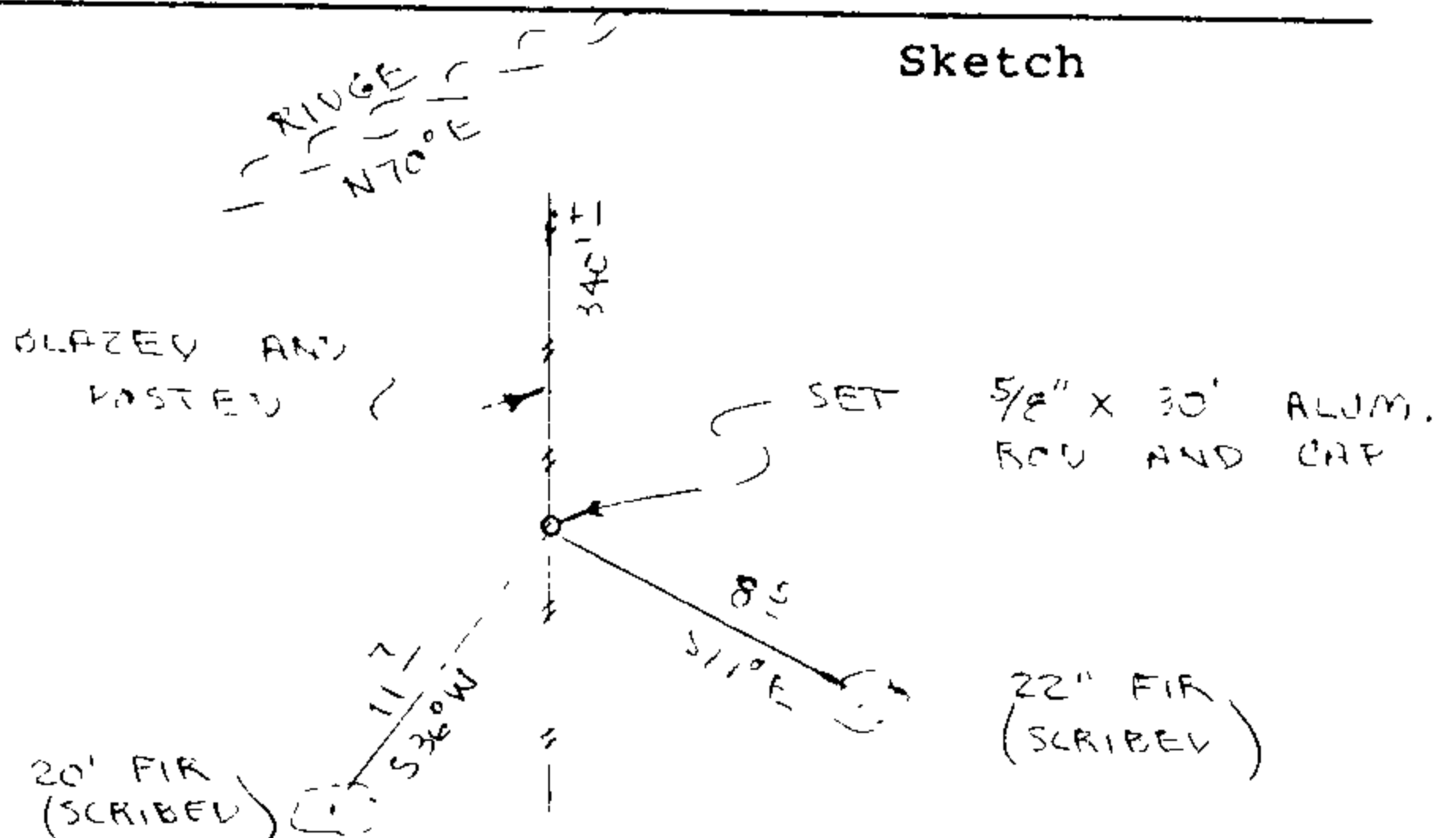

Monument Set (Procedures and Description)

Set 5/8" x 30" Aluminum rod and cap. Buried purple magnetic marker under 30" rod. See filed survey for procedures.

New Accessories

20" Fir, S36W, 11.7' (Scribed/Washer/Painted Red)

22" Fir, S77E, 8.5' (Scribed/Washer/Painted Red)

Set fence post, with land survey monument sign wired to, beside aluminum cap.

Location & Comments

Corner lies on South Compass Declination 20 $\frac{1}{2}$   
slope about 340' Firm/Agency Roberts

South of ridge. Ridge Surveying Inc.

bears S70W & N70E. Address 29 West 29th St.  
Eugene, Oregon 97405

Party Chief Ted Baker

Notes Ted Baker

Witness Jim Metzler

Surveyor's Seal



*L. D. Roberts*

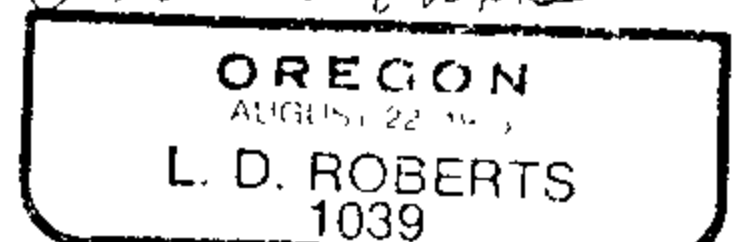

C.S. File No. 63/46-h

M103-37

FILED

FEB 13 1987

OREGON CORNER RESTORATION FORM

Section 10 Township 25S Range 8W

County Douglas Date 12-22-86

COUNTY SURVEYOR  
DOUGLAS COUNTY, ORE.

Corner Designation

C.S. 1/16 Corner  
Section 10

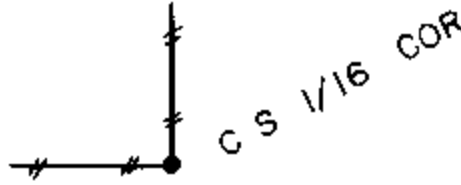

- Condition Report Only
- Not Found
- Renewed
- Unrecorded
- Surveyed In
- Referenced Out

Previous Renewals/Surveys, etc. None

Monument(s) & Accessories Found: (Condition and Source)  
None

Monument Detail

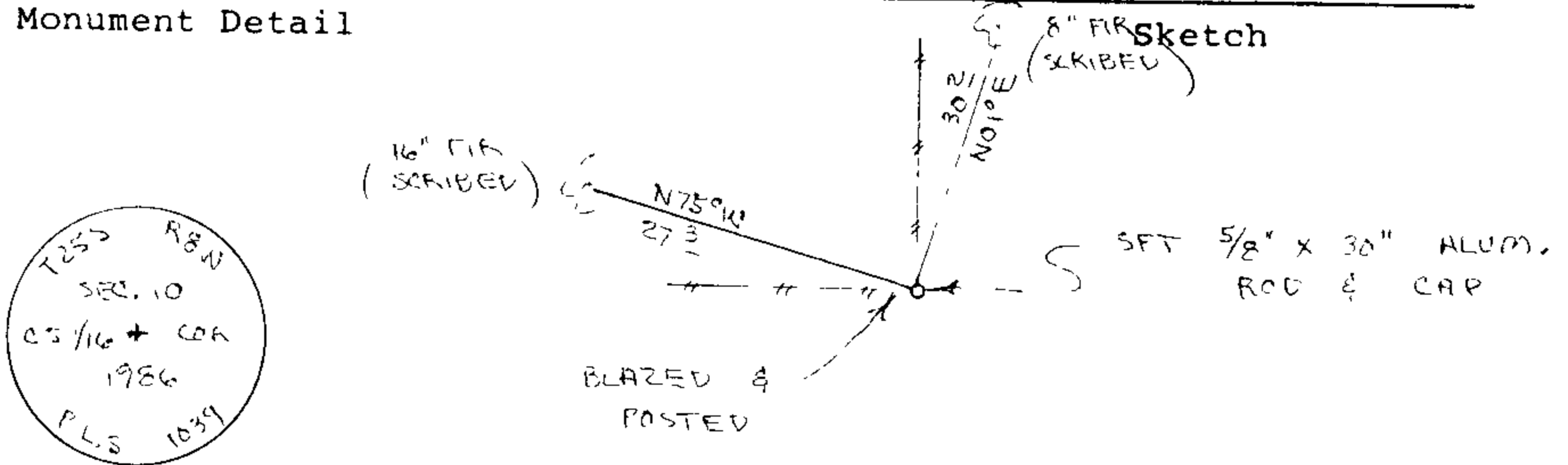

Monument Set (Procedures and Description)

Set 5/8" x 30" Aluminum rod and cap. Buried purple magnetic marker under 30" rod. See filed survey for procedures.

New Accessories

- 8" Fir, N01E, 30.2' (Scribed/Washer/Painted Red)
- 16" Fir, N75W, 27.3' (Scribed/Washer/Painted Red)
- Set aluminum fence post, with land survey monument sign wired to, beside aluminum cap.

Location & Comments

Corner lies on flat ground about 500' South of ridge. Ridge bears S60E & N60W

Compass Declination 20 1/2

Firm/Agency Roberts Surveying Inc.

Address 29 West 29th St. Eugene, Oregon 97405

Party Chief Ted Baker

Notes Ted Baker

Witness Jim Metzler

Surveyor's Seal



C.S. File No. 63/46-2i