

FILED

OREGON CORNER RESTORATION FORM

JUL 24 1986

Section 2 Township 30S Range 1W

County Douglas Date 7-16-86

COUNTY SURVEYOR  
DOUGLAS COUNTY, ORE.

Corner Designation

S.E. Section Corner

- Condition Report Only
- Not Found
- Renewed
- Unrecorded
- Surveyed In
- Referenced Out

Previous Renewals/Surveys, etc. \_\_\_\_\_

Monument(s) & Accessories Found: (Condition and Source)

- 14" D.FIR Bears S01°E - 23<sup>8</sup> FT Healed Face (1967)
- 7" Cedar Bears S36°W - 22<sup>5</sup> FT (Rec. 22<sup>9</sup>) Scribing Visible (1967)
- 8" Cedar Bears N03°E - 11<sup>6</sup> FT Scribing Visible (1967)
- 10" D.FIR Bears N44<sup>1</sup>/<sub>2</sub>°E - 22<sup>1</sup> FT Scribing Partially Visible (1967)

SLASH BURN KILLED B.T.'S - But still SOLID

Monument Detail

2 1/2" ALUM CAP ON a 1" I.P.  
extends 12" Above grd.

Sketch

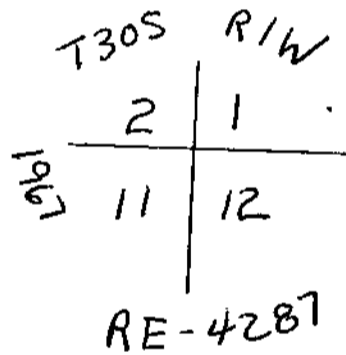

Monument Set (Procedures and Description)

New Accessories

Location & Comments

Compass Declination 19°E

Firm/Agency CHAMPION  
INTERNATIONAL

Address P.O. Box 1328  
Roseburg OR.

Party Chief Dean TURNER

Notes Lynn Sibley

Witness \_\_\_\_\_

Surveyor's Seal

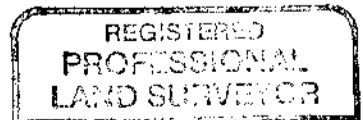

Ronald G. Geisler

