

FILED

OREGON CORNER RESTORATION FORM

MAR 17 1986

Section 11 Township 27S Range 3W

COUNTY SURVEYOR  
DOUGLAS COUNTY, ORE.

County Douglas Date 2-6-86

Corner Designation

WE  $\frac{1}{64}$

- Condition Report Only
- Not Found
- Renewed
- Unrecorded
- Surveyed In
- Referenced Out

Previous Renewals/Surveys, etc. SET BY SHRUM IN 1964

Monument(s) & Accessories Found: (Condition and Source)

11" madrone bears N75°E - 30<sup>2</sup> FT (Rec. 31<sup>4</sup>) scribbles partially visible (1964)

Monument Detail

2 1/2" ALUM CAP ON a 1"  
I.P. extends 10" above grd.

Sketch

T27S R3W

$\frac{2}{11}$   
 WE  $\frac{1}{64}$   
 RE 4287

Monument Set (Procedures and Description)

New Accessories

4" Sugar Pine bears S19°E - 7° FT. - Scribbled "X-B.T." (1986)

Location & Comments

Surveyor's Seal

Compass Declination 19°E

Firm/Agency CHAMPION

International

Address P.O. Box

1328 ROSEBURG, OR.

Party Chief Lynn Sibley

Notes Dean Turner

Witness \_\_\_\_\_

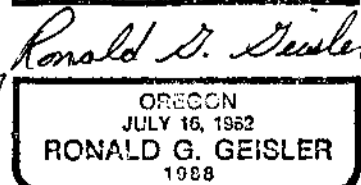
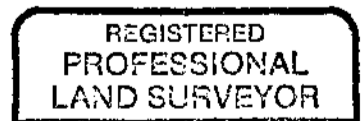

C.S. File No. 63/24-14