

FILED

NOV 28 1986

OREGON CORNER RESTORATION FORM

Section 17+20 Township 29 S Range 8 W

County Douglas Date 9/25/86

COUNTY SURVEYOR
DOUGLAS COUNTY, ORE.

Corner Designation

EAST $\frac{1}{16}$ between
sections 17 & 20

- Condition Report Only
- Not Found
- Renewed
- Unrecorded
- Surveyed In
- Referenced Out

Previous Renewals/Surveys, etc. Previous recorded survey,
Ren Irving 1928, Renewal # 2/A. However it is obvious
monument has been re-set since that time.

Monument(s) & Accessories Found: (Condition and Source)

Found A $1\frac{1}{2}$ " Aluminum cap on $\frac{5}{8}$ " IRON ROD MARKED
E $\frac{1}{16}$ $\frac{517}{920}$ Douglas County Surveyors ALSO Found The Following

Bearing Trees

A 24" Fir Tagged N 61° E 31' FT

A 17" Fir Tagged S 70° E 47' FT

The Bearing trees as described in Ren # 21A were not
RE-LOCATED Both The Above trees were Tagged AND Found
in good condition

Monument Detail

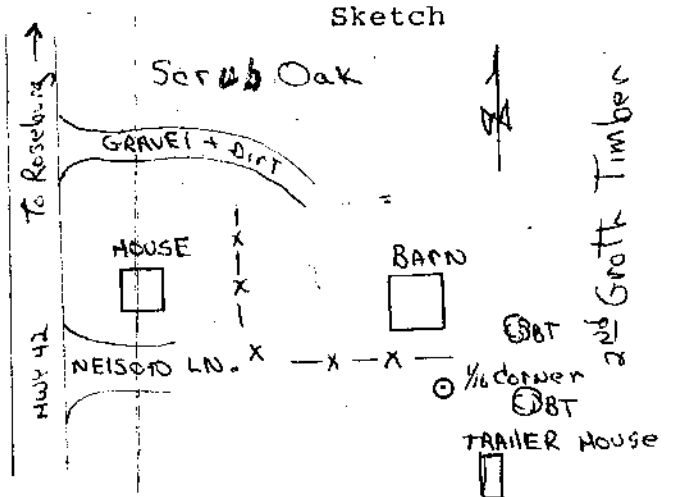

Monument Set (Procedures and Description)

New Accessories

Location & Comments

MONUMENT 2" Above Compass Declination _____
 Ground line 7° ± SE. Firm/Agency O.D.O.T.
 of E. W. FENCE AND
30± FT North of a Address 1523 S.E. Cobb
Trailer house located Roseburg Ore
at end of Nelson Party Chief L LATHROP
LANE Notes R SMALL
 Witness C Judd

Surveyor's Seal

REGISTERED PROFESSIONAL LAND SURVEYOR

Roger E. Patitz

OREGON
JULY 22, 1968
ROGER E. PATITZ
DOB