

FILED

NOV 28 1986

OREGON CORNER RESTORATION FORM

Section 30E31 Township 29S Range 8W

County Douglas Date 9-26-86

COUNTY SURVEYOR
DOUGLAS COUNTY, ORE.

Corner Designation

T 29S, R 8W.
C | S 30
44 | S 31 CC

- Condition Report Only
- Not Found
- Renewed
- Unrecorded
- Surveyed In
- Referenced Out

Previous Renewals/Surveys, etc.

Monument(s) & Accessories Found: (Condition and Source)

Found 3-inch Brass Disk, marked as shown above.
Found 18-inch Fir, previously 9-inch Fir, bears
N 26° E, 18.3 Lks dist, mkd. T 29S, R 8W, S 31 CC BT

Monument Detail

Sketch

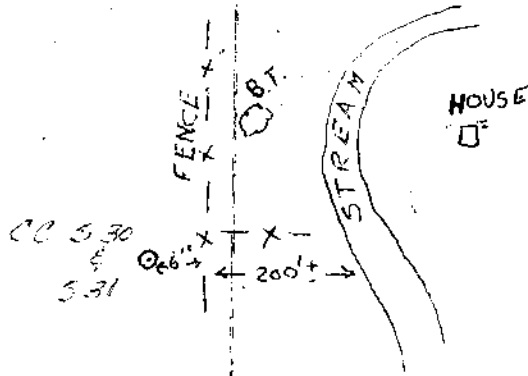

Monument Set (Procedures and Description)

New Accessories

Location & Comments

Surveyor's Seal

Compass Declination

Firm/Agency C.D.C.T.

Address 1523 SE Cobb

Roseburg, OR

Party Chief L. Lathrop

Notes R. Small

Witness R. Wilcox

REGISTERED
PROFESSIONAL
LAND SURVEYOR

Roger E. Patitz

OREGON
JULY 11, 1959
ROGER E. PATITZ
906