

FILED

JK

NOV 28 1986

OREGON CORNER RESTORATION FORM

Section 29 Township 29S Range 8W

County Douglas Date 9-2-86

COUNTY SURVEYOR
DOUGLAS COUNTY, ORE.

Corner Designation

SE DLC #42 Corner

Condition Report Only

- Not Found
- Renewed
- Unrecorded
- Surveyed In
- Referenced Out

Previous Renewals/Surveys, etc. Survey in Vol. 3, Pg. 57
states that a stone is set at the corner. No
other record indicates anything else.

Monument(s) & Accessories Found: (Condition and Source)

Found 1" iron rod, 4" above ground
No Bearing Trees Found

This monument does not appear to be the
SE corner of DLC #42 as this corner is designated
as a stone and there is no record of a pin
or rod being set at the corner location

Monument Detail

Sketch

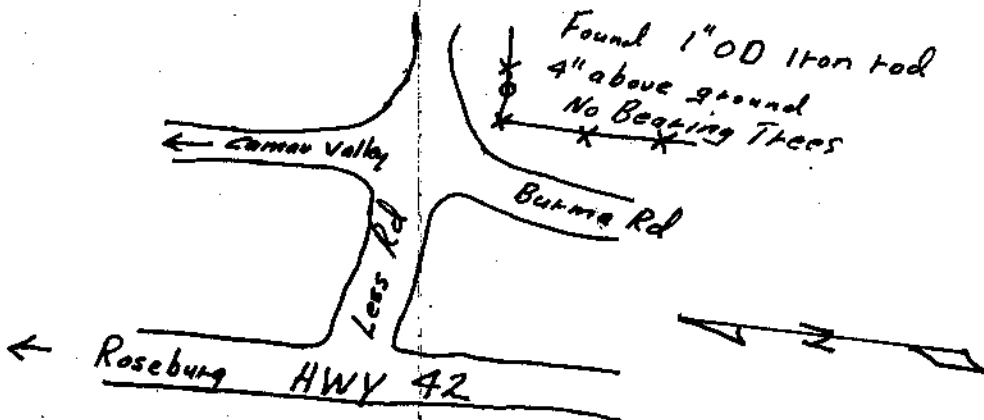

Monument Set (Procedures and Description)

New Accessories

Location & Comments

Originally thought
to be SE Cor. DLC
42. Evidence found
does not substantiate
this possibility.

Compass Declination _____
Firm/Agency ODOT
Address 1523 SE Cobb
Roseburg, OR
Party Chief L. Hathrop
Notes R. Small
Witness E. Wilcox

Surveyor's Seal

REGISTERED
PROFESSIONAL
LAND SURVEYOR

Roger E. Patitz

OREGON
JULY 31, 1969
ROGER E. PATITZ
908