

FILED

SEP 12 1986

OREGON CORNER RESTORATION FORM

Section 20 Township 29S Range R8W

County Douglas Date 9/4/86

COUNTY SURVEYOR
DOUGLAS COUNTY, ORE.

Corner Designation

Center of Section 20

- Condition Report Only
- Not Found
- Renewed
- Unrecorded
- Surveyed In
- Referenced Out

Previous Renewals/Surveys, etc. Ben B. Irving County Surveyor
JAN. 4, 1928

Monument(s) & Accessories Found: (Condition and Source)

Fd 3/4 O.D. PIPE INSIDE 1 1/4" I. pipe at corner good condition
No Bearing trees found

Monument Detail

Found 3/4" O.D. I. PIPE
INSIDE 1 1/4" I. pipe at the corner

Sketch

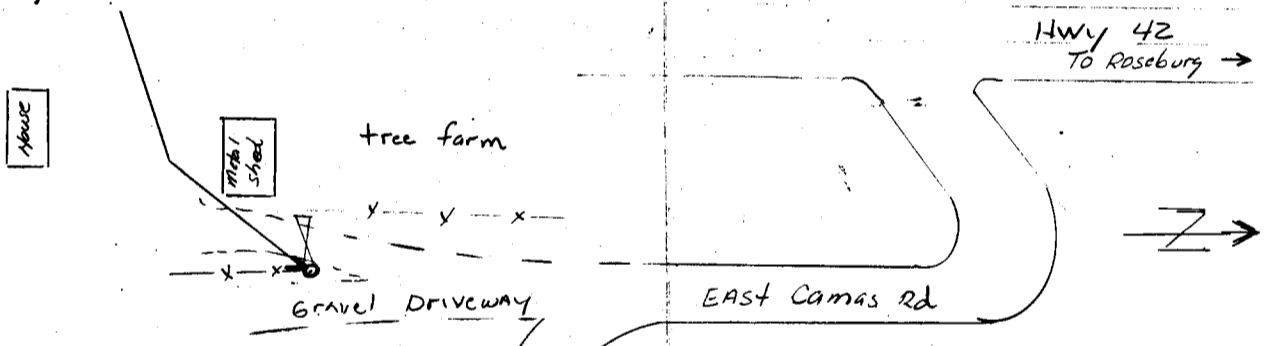

Monument Set (Procedures and Description)

New Accessories

Location & Comments

Corner lies at end
of a fence dividing
two properties. Also
at EAST END of a
wire gate

Compass Declination _____
Firm/Agency O.D.O.T.
Address 1525 SE COBB
Roseburg Oregon
Party Chief L. Lathrop
Notes R. Small
Witness C. Judd

Surveyor's Seal

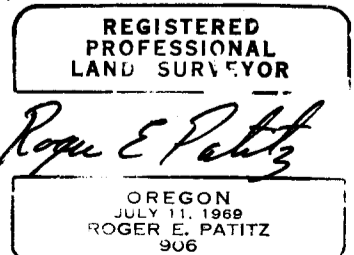

C.S. File No. 63/9-25