

FILED

Handwritten initials

SEP 12 1986

OREGON CORNER RESTORATION FORM

Section 2/11 Township 29S Range 8W

County DOUGLAS Date 7/15/86

COUNTY SURVEYOR
DOUGLAS COUNTY, ORE.

Corner Designation

1/4 Sect 2+11

- Condition Report Only
- Not Found
- Renewed
- Unrecorded
- Surveyed In
- Referenced Out

Previous Renewals/Surveys, etc. RENEWAL # 154 BY H.L. NORTHCRAFT
MARCH 1971, SEE RENEWAL # 50.

Monument(s) & Accessories Found: (Condition and Source)

FOUND 3" BRASS CAP AT 1/4 SECTION CORNER MARKED: U.S.
DEPT. OF THE INT. BUR. LAND MAN. 1980, 1/4 S2/S11
T 29S RBW, ON IRON PIPE 6" ABOVE GROUND. ALSO
FOUND 14" BLACK OAK, OPENED, "1/4" VISIBLE, REVERSE "B" ON
LOWER BLAZE.
12" (NOW 16" BLACK OAK WITH HELLED BLAZE, N28 1/2° E 31.2' FT

Monument Detail

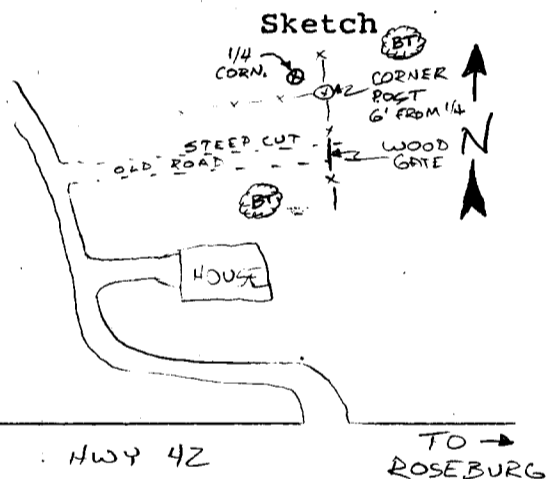

Monument Set (Procedures and Description)

New Accessories

Location & Comments

Compass Declination _____
 Firm/Agency O.D.O.T.
 Address 1523 SE COBB
ROSEBURG, OR 97470
 Party Chief L. LATHROP
 Notes R. WILCOX
 Witness R. LADKE

Surveyor's Seal

