

FILED

JH

SEP 12 1986

OREGON CORNER RESTORATION FORM

Section 5 1/2 Township 29 S Range 8 W

County DOUGLAS Date 7/16/86

COUNTY SURVEYOR
DOUGLAS COUNTY, ORE.

Corner Designation

E 1/16 SECTIONS 11 & 2

- Condition Report Only
- Not Found
- Renewed
- Unrecorded
- Surveyed In
- Referenced Out

Previous Renewals/Surveys, etc.

Monument(s) & Accessories Found: (Condition and Source)

FOUND 3/4" IRON ROD AT THE EAST 1/16 CORNER OF SECTIONS 11 AND 2 1 FOOT ABOVE GROUND.

ALSO FOUND ONE BEARING TREE - 36" CEDAR N 72 1/2 E 28.3 FT.

Monument Detail

Sketch

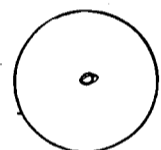

3/4" IRON ROD

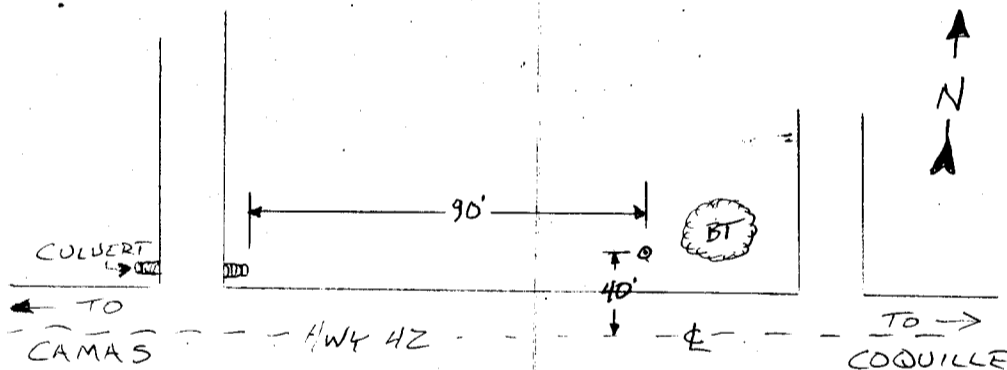

Monument Set (Procedures and Description)

New Accessories

Location & Comments

Surveyor's Seal

Compass Declination

Firm/Agency ODOT

Address 1523 SE. COBB

ROSEBURG, OR 97470

Party Chief L. LATHROP

Notes R. WILCOX

Witness R. LADKE

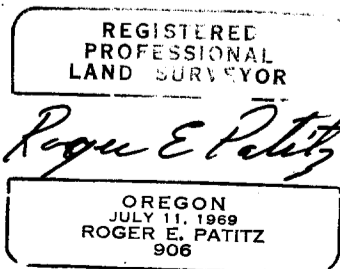

C.S. File No. 63/9-17