

FILED

SEP 12 1986

OREGON CORNER RESTORATION FORM

Section 9-16 Township 29 S Range 8 W COUNTY SURVEYOR
DOUGLAS COUNTY, ORE.

County DOUGLAS Date 7-1-86

Corner Designation

$\frac{1}{4}$ Corner For Secs 9 & 16

- Condition Report Only
- Not Found
- Renewed
- Unrecorded
- Surveyed In
- Referenced Out

Previous Renewals/Surveys, etc. RE-RENEWED SEE COPY # 176
R.B. Kimberlin MARCH 1, 1978 : COPY # 91 J.W. BYRON Oct. 31, 1958 :
COPY # 35 A. ROYER APRIL 1949

Monument(s) & Accessories Found: (Condition and Source)

FOUND (A) $\frac{1}{4}$ CORNER CORNER TO SEC 9+16 A 2 1/2" BRASS CAP
12 FT ABOVE GROUND MARKED COUNTY SURVEYORS OFFICE 1958
T 29 S, R 8 W $\frac{91 S}{55}$ ALSO FOUND FOLLOWING BEARING TREES
28 IN NOW 30 IN STUMP WITH MEAL SCRIBED S 34 1/2 E 21.6 FT WITH TAG
TAGED 7" X 6" HIGH SNAG 17" APPROX. S 76 W
30" STUMP N 48 E, 22.7 FT
ALSO FOUND "+80" ON 10 FT X 10 FT X 4 FT STONE N 25 E, 13.2 FT

Monument Detail

Sketch

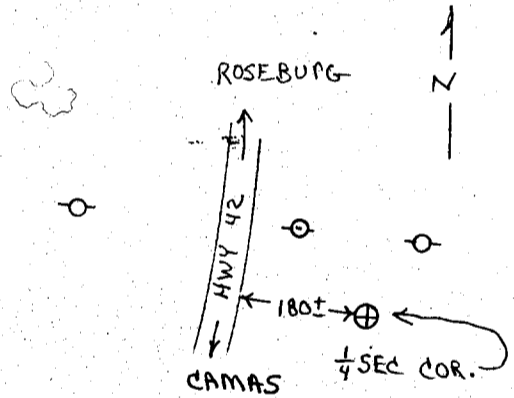
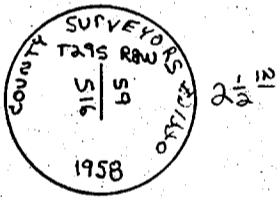

Monument Set (Procedures and Description)

New Accessories

Location & Comments

THIS $\frac{1}{4}$ CORNER IS
APPROX 180± FT
EAST OF HWY 42

Compass Declination _____
Firm/Agency O.O.O.T.

Address 1523 S.E. COBB

Party Chief L. LATHROP

Notes C. JUD

Witness R. Wilcox

Surveyor's Seal

