

FILED
RECEIVED *JK*

AUG 14 1985

OREGON CORNER RESTORATION FORM

Section 25, 30 Township 29S Range 5, 6W

County DOUGLAS Date AUG 7, 1985

COUNTY SURVEYOR
DOUGLAS COUNTY, ORE.

Corner Designation

R	25	30	R
G			S
W	36	31	W

T29S

- Condition Report Only
- Not Found
- Renewed
- Unrecorded
- Surveyed In
- Referenced Out

Previous Renewals/Surveys, etc.

COUNTY SURVEYOR 1977 #272 T29-6

#172 T29-5

Monument(s) & Accessories Found: (Condition and Source)

FOUND BRASS CAP SET BY COUNTY IN 1977 WITH A 1" IRON PIPE ALONG SIDE OF PIPE WITH BRASS CAP.

FOUND 38" W. FIR STUMP WHICH BEARS S60°W, 11.2 FT. SCRIBES VISIBLE - FOUND A 40" FIR STUMP BEARING S73 1/2° E 55.5 FT, SCRIBES VISIBLE -

FOUND A 34" FIR STUMP BEARING N67 1/2° W 42.2 FT, THIS STUMP WAS CUT TOO LOW FOR ANY SCRIBING TO REMAIN. ALL OTHER BEARING TREES WERE DESTROYED IN LOGGING. ALSO THE 30" FIR STUMP 64.2' EAST IS GONE.

Monument Detail

Sketch

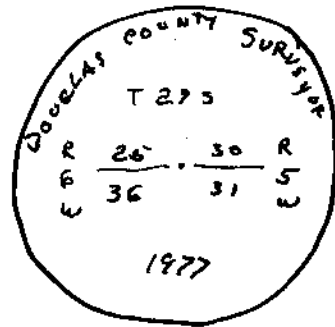

Monument Set (Procedures and Description)

New Accessories

A 19" W. FIR BEARS N67°E, 38.4 FT, MARKED T29S R5W S30 BT

A 6" FIR BEARS N52°W, 74.4 FT, MARKED T29S R5W S25 BT

Location & Comments

LOCATED OFF OF BOONER HILL, JUST BELOW RD NO. 29-5-19.1

Compass Declination 20°

Firm/Agency SUN STUDS INC.

Address PO. Bx 1127

ROSEBURG, OR

Party Chief BW HOLT

Notes

Witness GARY ANGLIET

Surveyor's Seal



Burton W. Holt

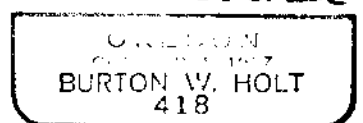

#220 T. 29-5 *

#257 T. 29-6 *

C.S. File No. 43/8-20