

CERTIFIED RECORD OF LAND CORNER MONUMENTATION

History of original corner establishment:

CORNER WAS SET IN 1978 BY LS 866.

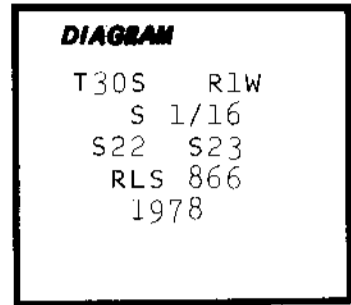

FILED
RECEIVED *JL*
APR 5 1985

COUNTY SURVEYOR
DOUGLAS COUNTY, ORE

Description of corner evidence found:

FOUND A 2 1/2" BRASS CAP ON A 2" IRON PIPE FROM WHICH;
A 16" FIR SNAG BEARS N71°W 16.5', SCRIBE VISIBLE.
A 18" FIR BEARS S33 1/2°E 15.9', SCRIBE VISIBLE.

Description of monument and accessories established to perpetuate the original location of this corner:

I SCRIBED; A 6" FIR WHICH BEARS N01°W 17.7' MARKED
S 1/16 S22 BT.

LOYD R. MOFFIT
FRIAR-MOFFIT & ASSOC.
717 W. 10TH ST.
MEDFORD, OR 97501

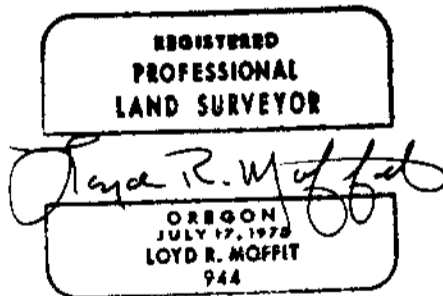

Office of..... Surveyor..... County of..... Douglas.....
State of..... Oregon....., I hereby certify that the within instrument was filed in this office
for record on the..... 5..... day of..... April..... 19..... 85
Fritz Ingram..... by..... *Virginia A. Langston*.....
(COUNTY OFFICIAL)..... (DEPUTY)