

CERTIFIED RECORD OF LAND CORNER MONUMENTATION

History of original corner establishment:

CORNER WAS ESTABLISHED BY L.S. 866 IN 1978

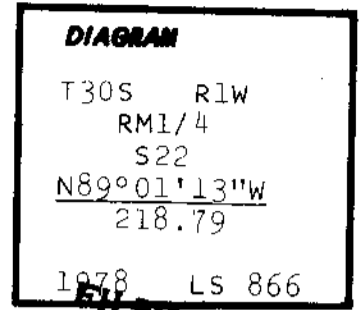

**FILED**  
**RECEIVED** *JL*

APR 5 1985

**COUNTY SURVEYOR**  
**DOUGLAS COUNTY, ORE.**

Description of corner evidence found:

FOUND A 2 1/2" BRASS CAP ON A 2" IRON PIPE S89°01'13"E  
218.79 FEET FROM TRUE 1/4 CORNER BETWEEN SECTIONS 21 AND 22,  
T.30S., R.1W., W.M.

Description of monument and accessories | established to perpetuate the original location of this corner:

I SCRIBED; AN 8" FIR MARKED "X" BT, BEARS N89°W 46.3 FEET  
FROM REFERENCE MONUMENT.

A 6" FIR MARKED "X" BT, BEARS N42°W 65.7 FEET  
FROM REFERENCE MONUMENT.

LOYD R. MOFFIT  
FRIAR-MOFFIT & ASSOC.  
717 W. 10TH ST.  
MEDFORD, OR 97501

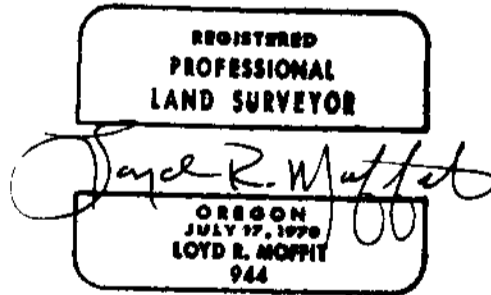

Office of..... Surveyor ..... County of..... Douglas .....  
Oregon  
State of..... Oregon ..... I hereby certify that the within instrument was filed in this office  
for record on the..... 5..... day of..... April....., 19..... 85  
Fritz Ingram ..... by *Virginia A. Layton* .....  
(COUNTY OFFICIAL) (DEPUTY)

22 X