

CERTIFIED RECORD OF LAND CORNER MONUMENTATION

History of original corner establishment:

CORNER WAS ESTABLISHED BY L.S. 866 IN 1978.

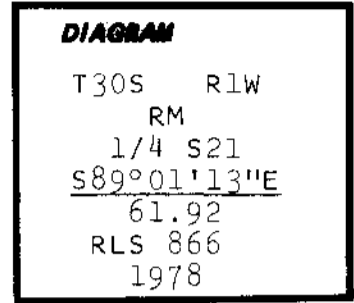

FILED
RECEIVED *JL*
 APR 5 1985
COUNTY SURVEYOR
DOUGLAS COUNTY, ORE.

Description of corner evidence found:

FOUND A 2 1/2" BRASS CAP ON A 2" IRON PIPE N89°01'13"W
61.92 FEET FROM TRUE 1/4 CORNER BETWEEN SECTIONS 21 AND 22,
T.30S., R.1W., W.M.

Description of monument and accessories I established to perpetuate the original location of this corner:

I SCRIBED; A 12" FIR MARKED "X" BT, BEARS S01°E 60.1 FEET
FROM REFERENCE MONUMENT.

A 12" CHINQUIPIN MARKED "X" BT, BEARS WEST 7.0
FEET FROM REFERENCE MONUMENT.

LOYD R. MOFFIT
 FRIAR-MOFFIT & ASSOC.
 717 W. 10TH ST.
 MEDFORD, OR 97501

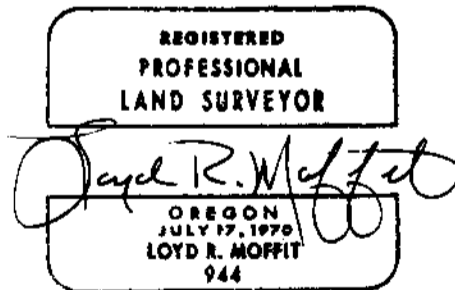

Office of.....Surveyor..... County of...Douglas.....
 State of.....Oregon....., I hereby certify that the within instrument was filed in this office
 for record on the...5... day of...April....., 19...85
 .Fritz..Ingram..... by ...*Virginia A. Langston*.....
 (COUNTY OFFICIAL) (DEPUTY)

#222 X