

CERTIFIED RECORD OF LAND CORNER MONUMENTATION

History of original corner establishment:

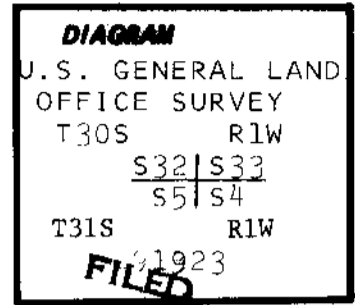

FILED
RECEIVED *JL*

APR 5 1985

COUNTY SURVEYOR
DOUGLAS COUNTY, ORE.

Description of corner evidence found:

FOUND A 2 1/2" BRASS CAP ON A 1 1/2" IRON PIPE FROM WHICH;

- A 32" FIR BEARS N42°E 10.8 FEET, SCAR VISIBLE.
- A 20" MADRONE BEARS S74°E 10.6 FEET, SCAR VISIBLE.
- A 17" PINE BEARS S01°E 16.9 FEET, SCRIBE VISIBLE.
- A FIR STUMP BEARS S88°W 9.7 FEET, SCAR VISIBLE.
- A 15" FIR BEARS N56°W 36.5 FEET, SCRIBE VISIBLE.

Description of monument and accessories established to perpetuate the original location of this corner:

I SCRIBED AN 8" FIR WHICH BEARS S43°W 35.6 FEET, MARKED T31S R1W S5 BT.

LOYD R. MOFFIT
FRIAR-MOFFIT & ASSOC.
717 W. 10TH ST.
MEDFORD, OR 97501



Office of..... Surveyor..... County of..... Douglas.....
 State of..... Oregon..... I hereby certify that the within instrument was filed in this office
 for record on the... 5... day of..... April....., 19... 85
 Fritz Ingram..... by *Virginia A. Sawyer*.....
 (COUNTY OFFICIAL) (DEPUTY)

Form R6-7100-57 (9/71)

★ GPO—798-276

* 229 T.30-1 X
* 203 T.31-1 X

C.S. File No. 63/8-6c