

CERTIFIED RECORD OF LAND CORNER MONUMENTATION

History of original corner establishment:

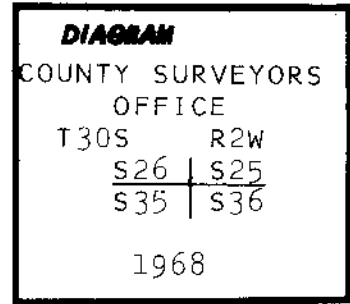

FILED  
 RECEIVED *if*  
 APR 5 1985  
 COUNTY SURVEYOR  
 DOUGLAS COUNTY, ORE.

Description of corner evidence found:

FOUND A 2 1/2" BRASS CAP ON A 1" PIPE EXPOSED 12" FROM WHICH;

- A 22" FIR STUMP BEARS N15°W 1.7 FEET.
- A 16" FIR BEARS N59°W 73.5 FEET, SCAR VISIBLE.
- A 12" PINE BEARS S74°E 33.4 FEET, SCAR VISIBLE.
- A 16" FIR BEARS S03°E 20.9 FEET, SCAR VISIBLE.
- A 38" FIR BEARS N50°E 9.0 FEET, NO SCAR.
- A 16" FIR BEARS S43°W 39.5 FEET, SCRIBE VISIBLE.

Description of monument and accessories I established to perpetuate the original location of this corner:

I SCRIBED A 4" FIR WHICH BEARS N30°W 18.0 FEET MARKED "X" BT.

LOYD R. MOFFIT  
 FRIAR-MOFFIT & ASSOC.  
 717 W. 10TH ST.  
 MEDFORD, OR 97501



Office of..... Surveyor..... County of..... Douglas.....  
 Oregon  
 State of....., I hereby certify that the within instrument was filed in this office  
 for record on the... 5... day of... April... 19... 85  
 Fritz Ingram..... by..... Virginia A. Sawyer.....  
 (COUNTY OFFICIAL) (DEPUTY)

# 256 4