

GOVERNMENT CORNER RESTORATION FORM

FILED

JR

Township 21S Range 5W Sec. 7 County DOUGLAS

JUN 29 1989

State OR Date 6/23/89 No. _____

COUNTY SURVEYOR
DOUGLAS COUNTY, ORE

Corner Designation

$\frac{1}{4} \frac{S7}{S18}$

- Condition Report Only
- Not Found
- Renewed
- Unrecorded
- Surveyed In
- Referenced Out

Previous Renewals NONE OF RECORD

MONUMENT DETAIL

Monument(s) Found: (Condition and Source)

A STONE FD BY DON PEEL MEASURING
6" BY 5" BY 12" LONG 1 FT BELOW GROUND.
WITH SMALLER PIECES OF BROKEN STONE.

1" I.D. ALUMINUM PIPE PROTRUDES
9" ABOVE GROUND NOT OF DCSD
RECORD. ALUMINUM PIPE SET
BY WILLIAM L. WILT IN 1964, MARKS
A Y4 COR. POSITION PROPORTIONED BY
GILBERT A GARDNER IN AN UNRECORDED
SURVEY DATED 1956. THIS CORNER IS
IN WEYERHAEUSER COMPANY SURVEY
FILE, IT IS NOTED AS NOT BEING AN
OFFICAL CORNER.

Accessories Found:

FROM STONE, TREE'S FD BY DON PEEL
14" DIA. ROTTED 12 FT HIGH HEMLOCK SNAG, PREVIOUSLY OPENED NO
SCRIBING OR BLAZES FD. BEARS S20°W 4.4 FT

40" DIA DOWN, WITH ROTTED OUT CENTER HEMLOCK NO BLAZES OR SCRIBING FD.
STANDING POSITION APPROX BEARS N10°E, 7.0 FT.

1" I.D. ALUMINUM PIPE NOT OF RECORD BEARS N73°W 63.8 FT

FROM 1" ALUM. PIPE

58" DIA D.FIR WITH A FULLY HEALED SINGLE BLAZE
BEARS N24°W, 57.7 FT CREL. FROM W. CO. RT TAG
IS (S24°E, 55.4 FT, FACE MEASUREMENT).

8" DIA D.FIR WITH FULLY HEALED DOUBLE BLAZE
BEARS S8°E, 29.2 FT CREL. FROM W. CO. RT TAG
N19°W, 29.2 FT)

ORIGINAL CORNER (COCT 25, 1884)
SET POST 4INS DIA. 4 FT LONG, WITH MKD. STONE 12 INS. IN GROUND FOR
Y4 SEC. COR. MKD. Y4 S ON N. FACE, FROM WHICH
A HEMLOCK, 6INS. DIA., BEARS S. 8°W, 51KS. DIS. MKD. Y4 S BT.

A HEMLOCK, 5IN. DIA., BEARS N. 36°W, 51KS DIS. MKD. Y4 S BT.

RENEWAL

Monument Set (Procedure and Description)

NONE

Monument Detail

N/A

New Accessories

NONE

Sketch of Monument, Accessories, and General Area

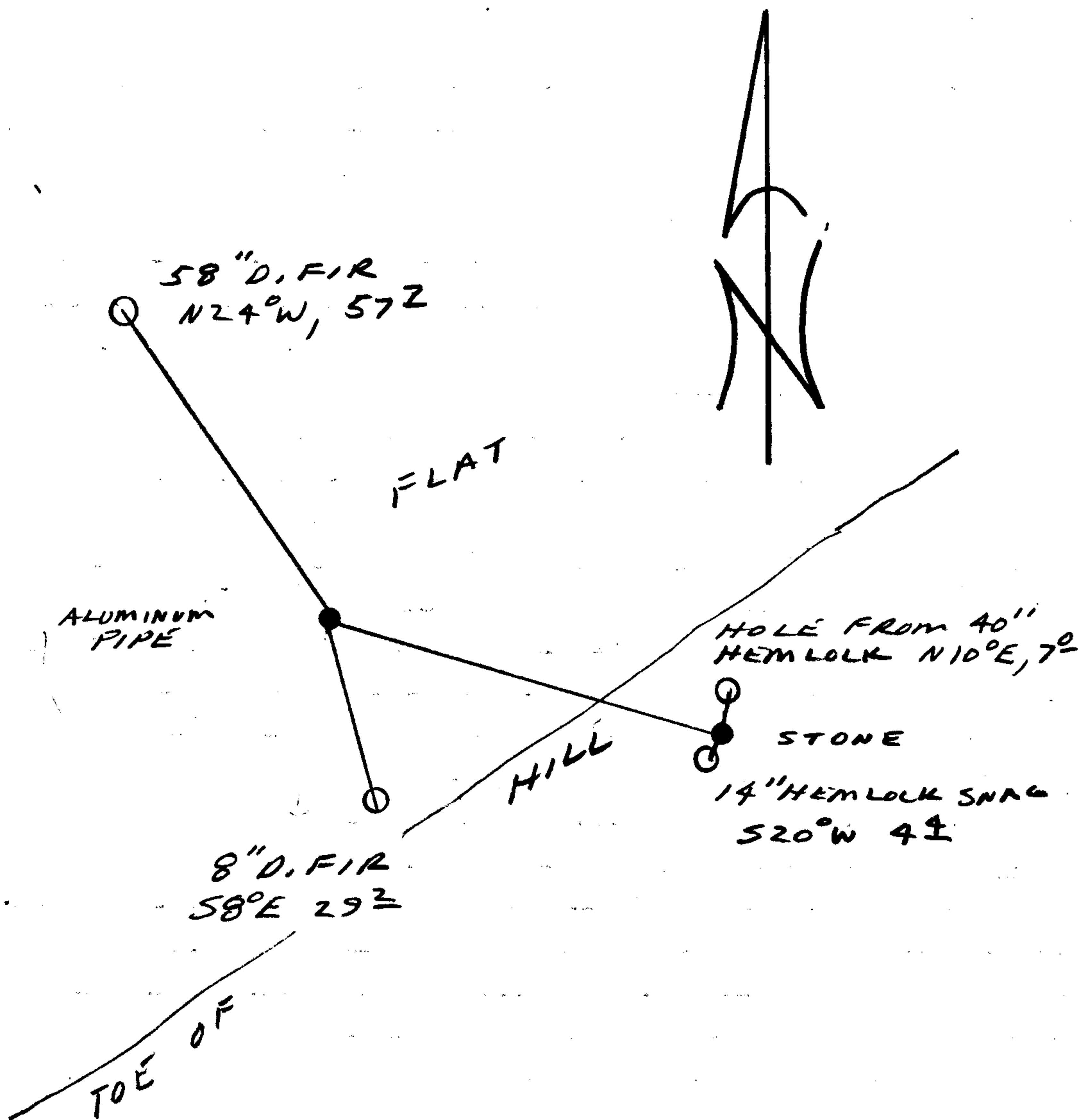

Location & Comments

ORIGINAL CALLS DO NOT FIT WELL WITH POSITIONS NOTED

Comp. Declin. 18°E
 Agency DLSO
 Party Chief RANDALL SMITH
 Notekeeper RANDALL SMITH
 Witnesses STEPHEN J. FLAUS

Address

Surveyor's Seal

REGISTERED
 PROFESSIONAL
 LAND SURVEYOR

Larry E. Monrean

OREGON
 JULY 13, 1979
 LARRY E. MONREAN
 #1830

PUBLIC LAND CORNERS

FILED

JH
JUN 29 1989

WEYERHAEUSER COMPANY

SPRINGFIELD BRANCH COUNTY SURVEYOR
DOUGLAS COUNTY, ORE.

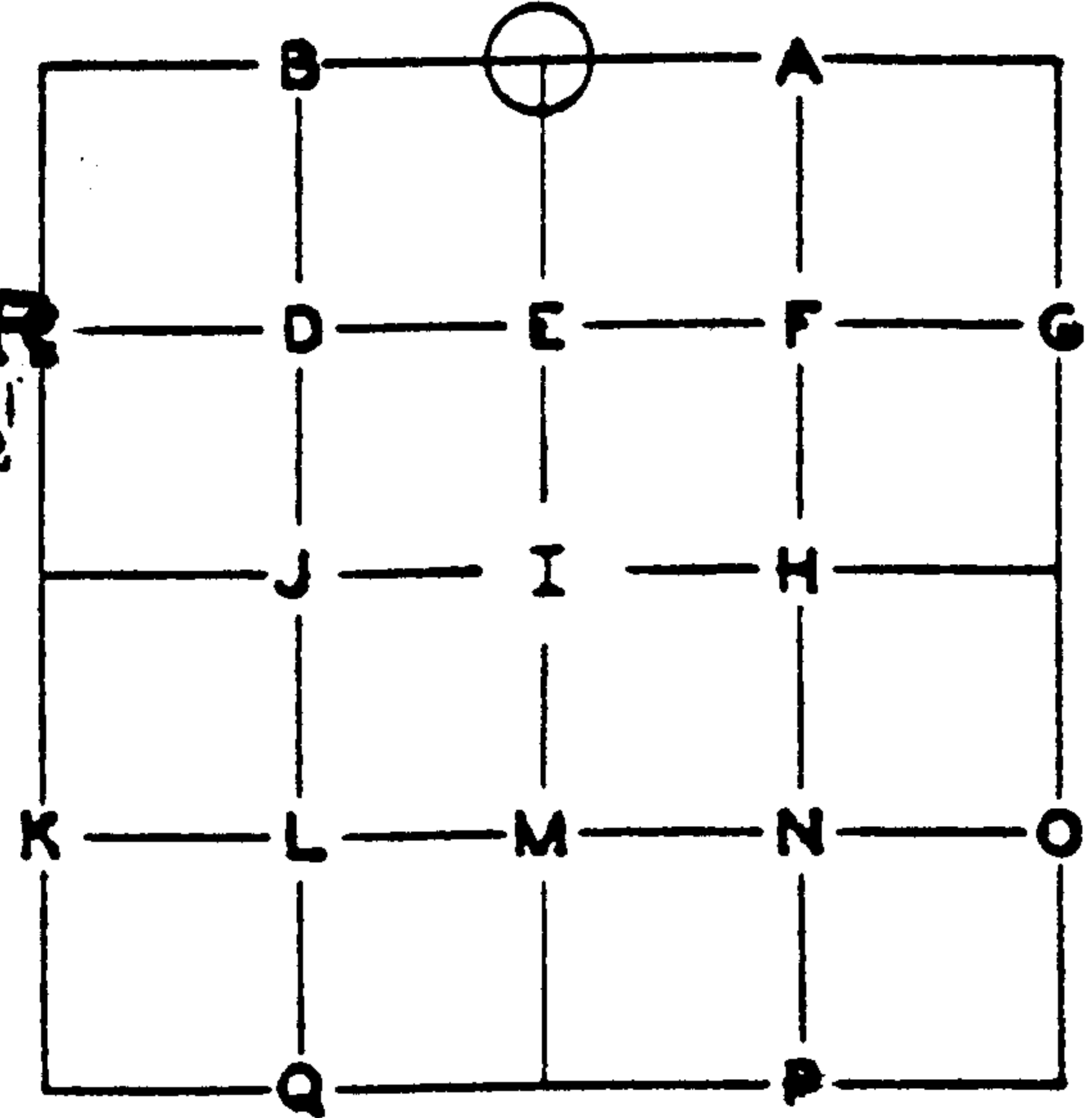

SPRINGFIELD
SURVEY FILE

TOWNSHIP 21 S RANGE 5 W
SECTION 18 CORNER N 1/4
COUNTY Douglas OREGON

GLO SURVEY RECORD

DATE: 1856
CORNER Stake & Stone

PRESENT CONDITION - (DESCRIBE FULLY -
USE PAGE 2 IF NEEDED FOR EXPLANATION.)

(None found)

ACCESSORIES:

	BEARING-	LINKS-	FEET-	
6" Hemlock	S 8° W	5	3.3	No Trace
5" Hemlock	N 36° W	5	3.3	No Trace

Gilbert A.
Gardner
(unrecorded)

SURVEY RECORD
DATE: Approx. 1956

PRESENT CONDITION: _____

4" x 4" Fir stake, scribed "1/4 S"

Good Condition

Found this date

36" Scribed Fir N 24° W 56.1'

Good Condition-Scribing Exposed

5" Scribed Fir S 8° E 29.4'

Good Condition - Face healed but
opened to expose scribing

CORNER SET: Set 1" Aluminum Pipe

MAG. DECL.: 20°

BEARING AND DISTANCE TO ABOVE IDENTIFIED SURVEY ACCESSORIES:

BEARING-	FEET-	SURVEY -

c.s. 62/63-19

SECTION 18 TOWNSHIP 21 S RANGE 5 W

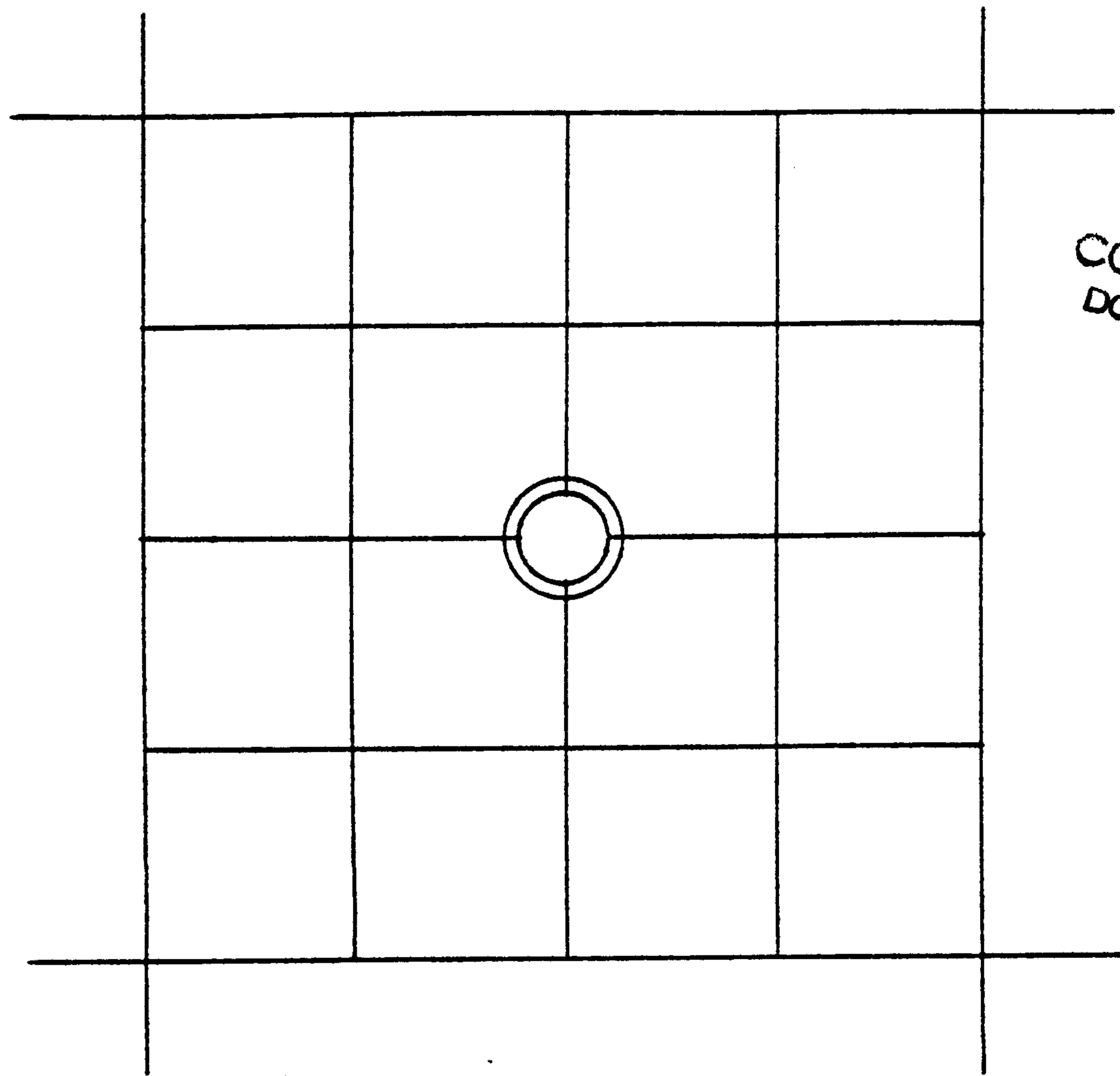

FILED

JR

JUN 29 1989

COUNTY SURVEYOR
DOUGLAS COUNTY, ORE



LINE MARKED BY NOTCH CUT IN BLAZE.

○...KNOWN CORNER.

⊙...REFERENCED CORNER
BY WEYERHAEUSER
METHOD.

This is not an official corner, and this report is for Weyerhaeuser Company file only. Robert Barta set the afore said scribed post and marked the said BT's under supervision of Gilbert A. Gerdner about 1956. At that time Gardner determined that corner was lost and intended to set $\frac{1}{4}$ corner by single proportion based on staff compass and chain survey. However, after checking notes after setting and referencing the post, it was found that there was an error of $\frac{1}{4}$ or 5 feet in the proportioning. Therefore this point is only approximate within $\frac{1}{4}$ or 5 feet in departure and within limits of staff compass line for latitude. The correction of the above error was not made at the corner point according to Robert Barta.

CS 62/63-19

ACCESSORIES ADDED THIS DATE:

MAGNETIC DECLINATION 20°

	BEARING	FEET	ORIG. B.T.	"W" NAIL	PLATE	BRASS DISC
40" Fir (Gardner scribing)	N 24° W	55.4	—	X	X	—
7" Fir (Gardner scribing)	S 8° E	29.2	—	X	X	—

FILED
JUN 29 1969

IDENTIFIED ON PHOTO:

INFORMATION ON LOCATION OF CORNER AS NOW SET:

COUNTY SURVEYOR
DOUGLAS COUNTY, ORE

GROUND COVER: Alder and clumps of Hemlock reprod, 20-25 years old.

(USING FORM LINES SKETCH TOPOG AT CORNER ON PAGE 2 PLAT)

SLOPE FACES (GIVE BEARING IN DEGREES) _____ ON MINUS (-) 2 %

FROM CORNER -

NORTH: 0%; West is logged Fir, Alder remaining; East uncut, mostly Alder; old well blazed line (cutting line) bears due North.

SOUTH: +6% for 25' thence ascend 65%; Hemlock reprod. 20-25 yrs. old
Relogged 8-10 years ago both East and West.

EAST: +17% for 40' thence ascend 60%; to North Alder, to South Hemlock reprod
Old well blazed line and line of logging

WEST: +12% for 75', thence descend gradually; Alder, Fir relogged about 8 yrs ago old, well blazed cutting line.

WORK DONE FOR W. CO.

FIELD NOTES IN BOOK: _____

BY: William L. Wilt DATE: 3/6/64
ENGINEER - SURVEYOR

UNDER THE SUPERVISION OF:

ASSISTED BY: _____

COPIES SENT TO: _____ (Not to be distributed)

SEAL
CS 62/63-19 PAGE 3