

GOVERNMENT CORNER RESTORATION FORM

FILED

Township 32S Range 5W Sec. 26 County DOUGLAS

State OR Date 4/20/89 No. _____ APR 27 1989

Corner Designation

1/4
S27 | S26

COUNTY SURVEYOR

DOUGLAS COUNTY, ORE.

Condition Report Only

Not Found

Renewed

Unrecorded

Surveyed In

Referenced Out

Previous Renewals #15 #191 GLO 1901 RESURVEY

MONUMENT DETAIL

Monument(s) Found: (Condition and Source)

A DCSO 2 1/2 IN. DIA. BRASS CAP
ON A 1 1/4 IN. O.D. IRON PIPE PROTRUDING
2 IN. ABOVE GROUND. (PER REN #191)

A 1 IN. I.D. IRON PIPE PROTRUDING
10" ABOVE GROUND (PER REN #15)
BEARS SOUTH 0.5 FT FROM
DCSO RC/IP.

COUNTY SURVEYORS OFFICE

T 32 S

1/4

S 27 | S 26

R 5 W

1975

Accessories Found:

BEARINGS AND DISTANCES TAKEN FROM DCSO RC/IP

5" NOW 29" DIA. P. PINE WITH A PARTIALLY HEALED SINGLE
BLAZE, NO SCRIBING VISIBLE. BEARS N 30° W, 60.1 FT
(AGREES WITH RECORD) ORIG. BT

14" NOW 30" D. FIR WITH A FULLY HEALED DOUBLE BLAZE
BEARS NORTH, 44.9 FT (AGREES WITH RECORD) PER
GLO 1901 RESURVEY

228 X

Monument Set (Procedure and Description)

Monument Detail

NONE

N/A

New Accessories

6" D. FIR DOUBLE BLAZED AND SCRIBED "Y4S26CS BT"
BEARS S36 1/2° E, 13.7 FT.

15" D. FIR DOUBLE BLAZED AND SCRIBED "Y4S27CS BT"
BEARS S19 1/2° W, 19.0 FT.

Sketch of Monument, Accessories, and General Area

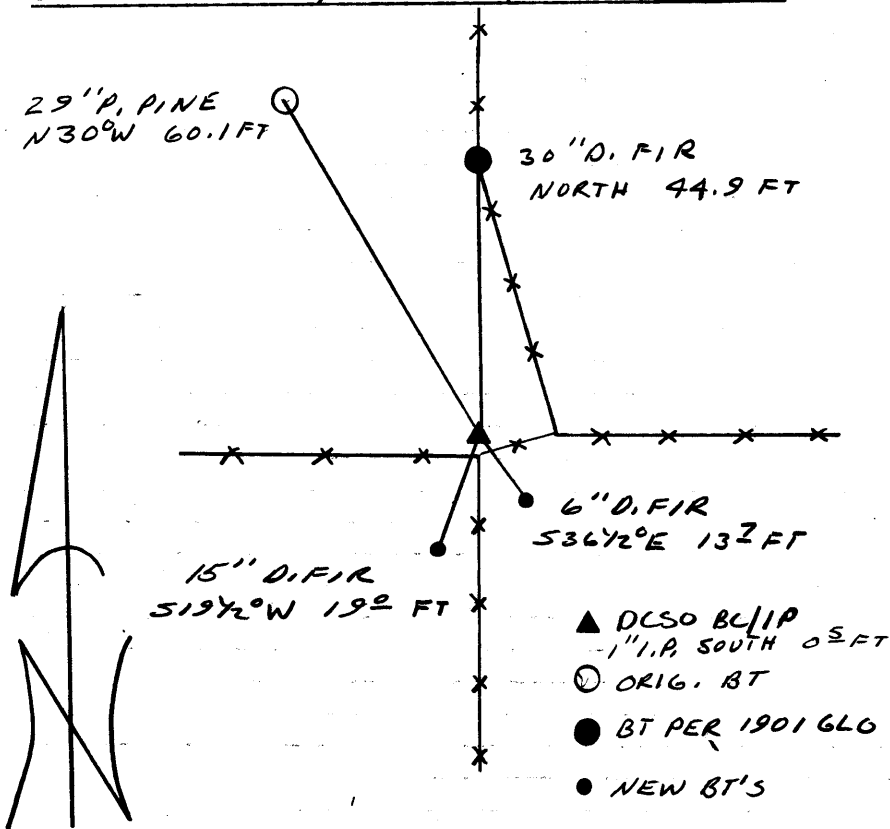

Location & Comments

Comp. Declin. 18° E
Agency DCSO
Party Chief RANDALL W. SMITH
Notekeeper Randall W. Smith
Witnesses STEPHEN J. FLAUSE

Address

Surveyor's Seal

REGISTERED
PROFESSIONAL
LAND SURVEYOR

Larry E. Monrean

OREGON
JULY 13, 1979
LARRY E. MONREAN
#1836