

GOVERNMENT CORNER RESTORATION FORM

FILED

zh

APR 11 1989

Township 25S Range 5W Sec. 13 County DOUGLAS

State OR Date 4/4/89 No. _____

COUNTY SURVEYOR
DOUGLAS COUNTY, ORE.

Corner Designation

$\frac{1}{4}$ S 13 | S 18

- Condition Report Only
- Not Found
- Renewed
- Unrecorded
- Surveyed In
- Referenced Out

Previous Renewals (#47 T. 25-4) (#43 T. 25-5)

MONUMENT DETAIL

Monument(s) Found: (Condition and Source)

A 2 1/2" DIA. DCSO BRASS CAP ON
1 1/2" O.D. BY 36" LONG IRON PIPE.
BC/IP IS BADLY BENT NORTH.

A 5/8" IRON ROD WITH AN ALUM.
CAP STAMPED "SHANER ENGINEERING."
PROTRUDING 7" ABOVE GROUND IS FOUND
0.3 FT WEST OF DCSO BC/IP PLUMB
POSITION.

COUNTY SURVEYOR'S OFFICE

R S S R
5 13 | 18 4
W W

T255
1958

Accessories Found:

MEASUREMENTS TAKEN FROM PLUMBED *POSITION OF DCSO BC/IP
NO EVIDENCE OF ORIGINAL RT'S FOUND

14" NOW 18" DIA. 2 FT HIGH D. FIR STUMP WITH A FULLY HEALED
LOWER BLAZE, BEARS N67°W, 54.3 FT (PER REN #47) AGREES
WITH RECORD.

15" NOW 20" DIA W. OAK WITH FULLY HEALED DOUBLE BLAZE,
BEARS N52 1/2°E, 33.7 FT (PER REN #47) AGREES WITH RECORD.

#149 T25-5 X

#144 T25-4 X

RENEWAL

Monument Set (Procedure and Description)

PLUMBED POSITION OF 1958 DCSO BC/IP AND SHANER 5/8" I.R. REFERENCED. A NEW 2 3/8" DIA BRASS CAP ON A 1 3/8" O.D BY 32" LONG IRON PIPE IS SET AT 1958 DCSO BC/IP PLUMBED POSITION, PROTRUDES 6" ABOVE GROUND. SHANER 5/8" I.R. WITH ALUM. CAP IS SET AT IT'S REFERENCED POSITION, PROTRUDES 4" ABOVE GROUND.

Monument Detail

DOUGLAS COUNTY SURVEYORS

T 255

R 1/4 R
5 513 | 518 4
W W

1989

OFFICE

New Accessories

15" D. FIR DOUBLE BLAZED AND SCRIBED " 1/4 S18 CS BT"
BEARS S53 1/2° E, 23.7 FT

Sketch of Monument, Accessories, and General Area

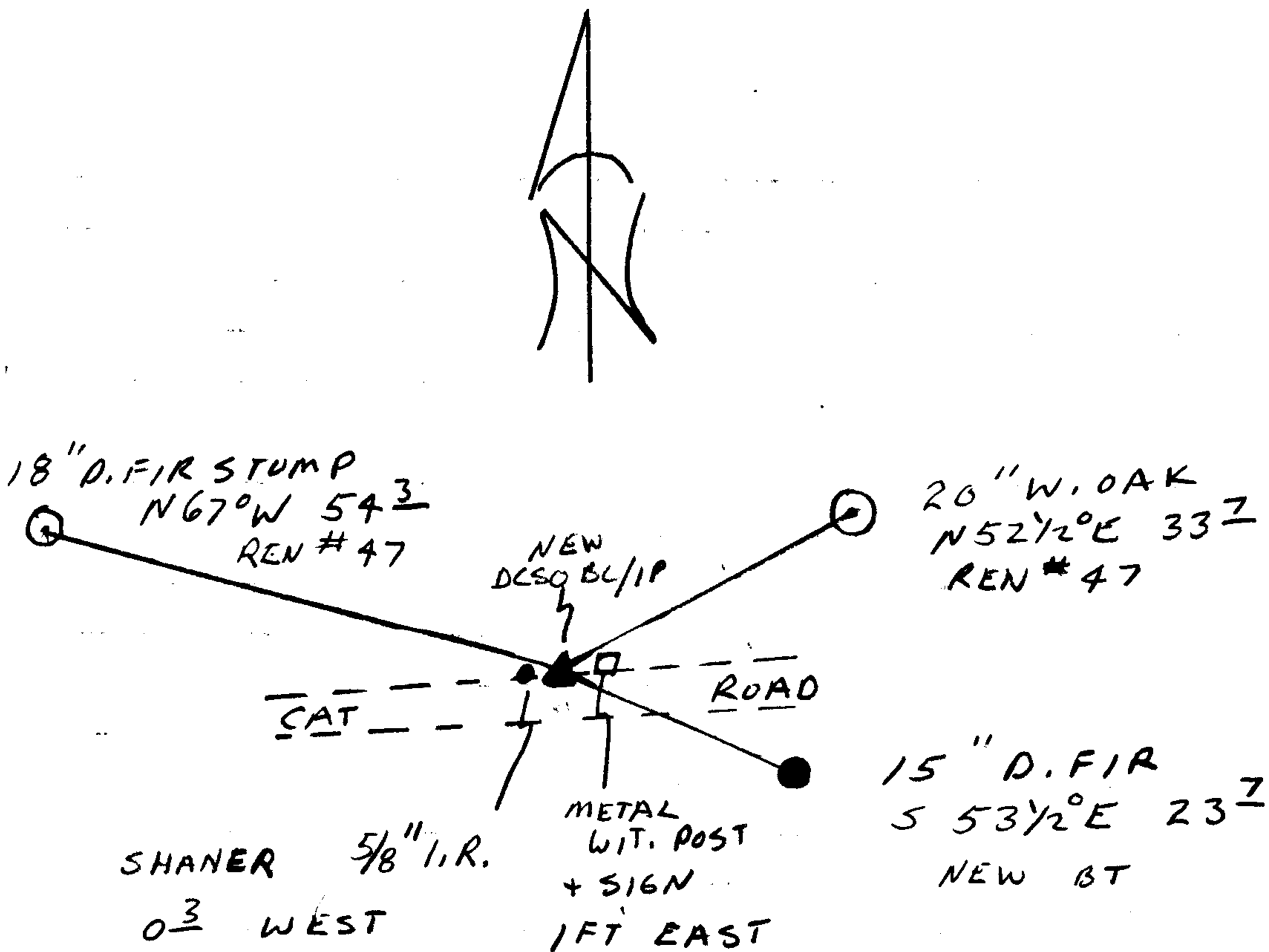

Location & Comments

Comp. Declin. 18 1/2° E
Agency DCSO
Party Chief RANDALL W SMITH
Notekeeper Randall W Smith
Witnesses STEPHEN J FLAISE

Address

Surveyor's Seal
REGISTERED
PROFESSIONAL
LAND SURVEYOR

Larry E. Monrean

OREGON
JULY 13, 1979
LARRY E. MONREAN
#1830

OREGON CORNER RESTORATION FORM

Section 13 Township 25S Range 5W

County Douglas Date Sept. 22, '88

Corner Designation

T25S
1/4S 13 • 18
R5W R4W

- Condition Report Only
- Not Found
- Renewed
- Unrecorded
- Surveyed In
- Referenced Out

Previous Renewals/Surveys, etc. _____

See Corner Renewal File No. 43.

Monument(s) & Accessories Found: (Condition and Source)

Found C.S. Brass Cap w/ Iron Pipe Badly Bent.
(Needs Replacement), Set 5/8" I. Rod w/ Alum. Cap
over pipe.

Monument Detail

Sketch

Monument Set (Procedures and Description)

EXIST. ~~NEW~~ Accessories :

18" Doug. Fir Stump (BT) w/ Face bears N67°W, 54.3 ft.

18" W. Oak BT, w/ Face, bears N52 1/2°E, 33.7 ft.

Location & Comments

Found 200 Ft.
N 80° E ± of 90° Bend
in Access Road.

Compass Declination _____

Firm/Agency _____

Address _____

Party Chief _____

Notes _____

Witness _____

Surveyor's Seal

REGISTERED
PROFESSIONAL
LAND SURVEYOR

B. Shaner

OREGON
OCT. 4, 1987
BRUCE A SHANER
430

C.S. 62/63-2