

GOVERNMENT CORNER RESTORATION FORM

Township 30S Range 5W Sec. 30 County DOUGLAS

State OR Date 1/6/89 No. _____

Corner Designation

ONLY | ^{1/4}
S30

- Condition Report Only
- Not Found
- Renewed
- Unrecorded
- Surveyed In
- Referenced Out

Previous Renewals #194, #220 (T30-6) #241, 269 ^(T.30-5)

MONUMENT DETAIL

Monument(s) Found: (Condition and Source)

1/4 IN O.D IRON PIPE, PROTRUDING
2 IN. ABOVE GROUND, TOP IS LEANING
0.4 FT WESTERLY, OF A PLUMB POSITION.
BRASS CAP WAS MOWED OFF IT IS
FOUND LOOSE ON TOP OF GROUND
ALONG SIDE IRON PIPE (PER REN #194)

DOUGLAS CO. SURVEYOR

T 30 S
 | S30 1/4
 R 6 W | R 5 W
 RESET
 1976

Accessories Found:

MEASUREMENTS TAKEN TO PLUMB POSITION OF IRON PIPE.

26" NOW 31" DIA. W. OAK WITH A FULLY HEALED SINGLE BLAZE BEARS S45°E, 70.1 FT (REC. ~~N43°N~~, 71.0 FT DIST. IS A SLOPE MEASUREMENT). PER REN #194. S EJK

9" NOW 13" DIA. DOUBLE TRUNKED MADRONE, WITH A FULLY HEALED SINGLE BLAZE FOUND ON EAST TRUNK, BEARS S172°E, 92.7 FT (REC. S16°E, 93.2 FT DIST. IS A SLOPE MEASUREMENT). PER REN #194

A 1969 DCSO 1 1/4" I.P. (1/4 COR SEC 25 T30S R6W ONLY) BEARS NORTH 99.4 FT (AGRESS WITH RECORD). CA NEW DCSO BE/IP IS NOW AT POSITION OF FOUND 1 1/4" I.P.)

#311 T30-5 ✓
#270 T30-6 ✓

RENEWAL

Monument Set (Procedure and Description)

PREVIOUSLY DESCRIBED 1 1/4" O.D. IRON PIPE PER REN # 194 IS REFERENCED TO PLUMB POSITION AND REMOVED, IRON PIPE MEASURES 36 IN LONG. A NEW DCSO 2 3/8" DIA. BRASS CAP ON A 30 1/2" LONG 1 1/4" O.D. IRON PIPE IS SET AND PROTRUDES 1 FT ABOVE GROUND. BC/IP IS SET AT REFERENCED POSITION.

Monument Detail

DOUGLAS COUNTY SURVEYORS OFFICE

T 30 S
1/4
S 30
R 6 W
R 5 W
1989

New Accessories

A WHITE METAL WITNESS POST IS SET 1 FT NORTH OF BC/IP.
A 3/4" CRRW IRON ROD PROTRUDING 2 IN ABOVE GROUND BEARS S55°E, 58.0 FT
A 1" I.D. IRON PIPE PROTRUDING 6 IN ABOVE GROUND BEARS S45°W, 29.4 FT

Sketch of Monument, Accessories, and General Area

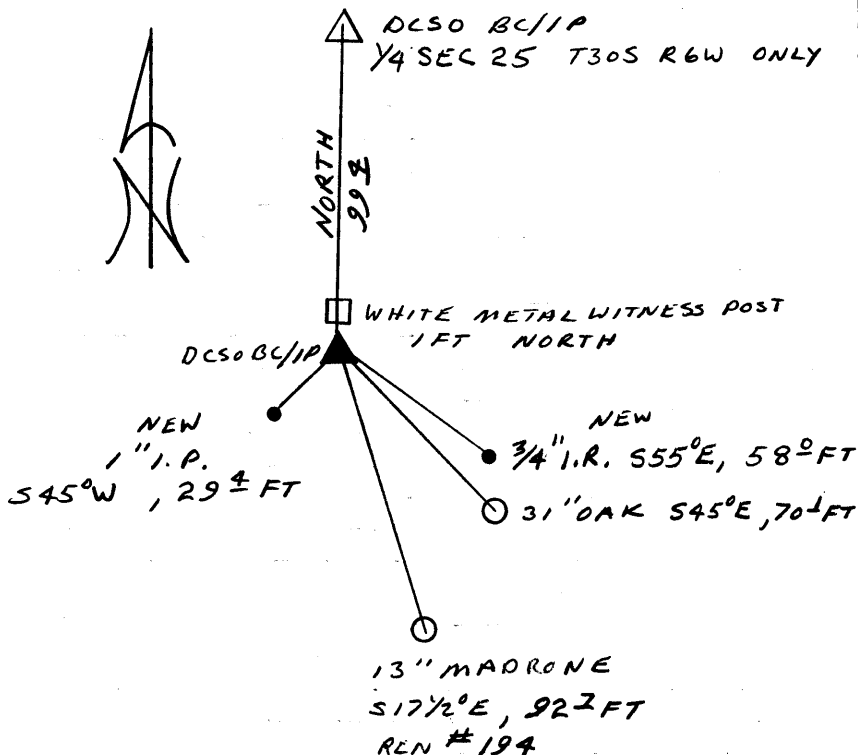

Location & Comments

CORNER LIES IN OPEN FIELD

Comp. Declin. 18 1/2° E
Agency DCSO
Party Chief RANDALL W SMITH
Notekeeper STEPHEN J FLAUS
Witnesses

Randall W Smith

Address

Surveyor's Seal

REGISTERED PROFESSIONAL LAND SURVEYOR

Larry E. Monrean

OREGON
JULY 13, 1979
LARRY E. MONREAN
#1830