

GOVERNMENT CORNER RESTORATION FORM

Township 28S Range 6W Sec. 17 County DOUGLAS

State OREGON Date 4/25/88 No. _____

Corner Designation

58 | 59

S17 | S16

- _____ Condition Report Only
- _____ Not Found
- Renewed
- _____ Unrecorded
- _____ Surveyed In
- _____ Referenced Out

Previous Renewals #117

Monument(s) Found: (Condition and Source)

A 1 1/2" O.D. IRON PIPE WITH A 2 1/2" DIA. DCSD BRASS CAP, PROTRUDING 18" ABOVE GROUND. TOP OF BC/1.P. IS LEANING 10" NORTH OF A PLUMB POSITION.

MONUMENT DETAIL

COUNTY SURVEYORS OFFICE
 T28S R6W
 58 | 59

 S17 | S16
 1962

Accessories Found:

MEASUREMENTS TAKEN TO PLUMB POSITION OF DCSD BC/1.P.

8" NOW 11" DIA. W. OAK WITH A FULLY HEALED DOUBLE BLAZE, BEARS S39°W, 27.7 FT (AGREES WITH RECORD) ORIG. BT

10" NOW 24" DIA. W. OAK WITH A PARTIALLY HEALED BLAZE, NO SCRIBING VISIBLE, BEARS WEST 37.4 FT (RECORD N87°W, 36.3 FT) ORIG. BT

5" NOW 9" DIA. W. OAK WITH A FULLY HEALED DOUBLE BLAZE BEARS S44°E, 18.5 FT (RECORD S42°E, NO DISTANCE SHOWN IN RENEWAL RECORDS, BT TAG SHOWS DISTANCE AS 18.5 WHICH WE AGREE WITH) PER REN #117

#180 X

C.S. File No. 62/52-80
C.S. File No. _____

RENEWAL

Monument Set (Procedure and Description)

PLUMB POSITION OF DCSO BC/1/P. IS REFERENCED, AND MONUMENT REMOVED. DCSO BC/1/P. IS A 36 INCH LONG SPLIT END IRON PIPE WHICH IS RESET AT REFERENCED PLUMB POSITION, AND NOW PROTRUDES 8 IN ABOVE GROUND.

Monument Detail

COUNTY SURVEYORS OFFICE

T28S R6W

S8 | S9
S17 | S16

1962

New Accessories

5" MADRONE BARK SCRIBED "T28S R6W S9 CS BT"
BEARS N42°E, 40.1 FT.

Sketch of Monument, Accessories, and General Area

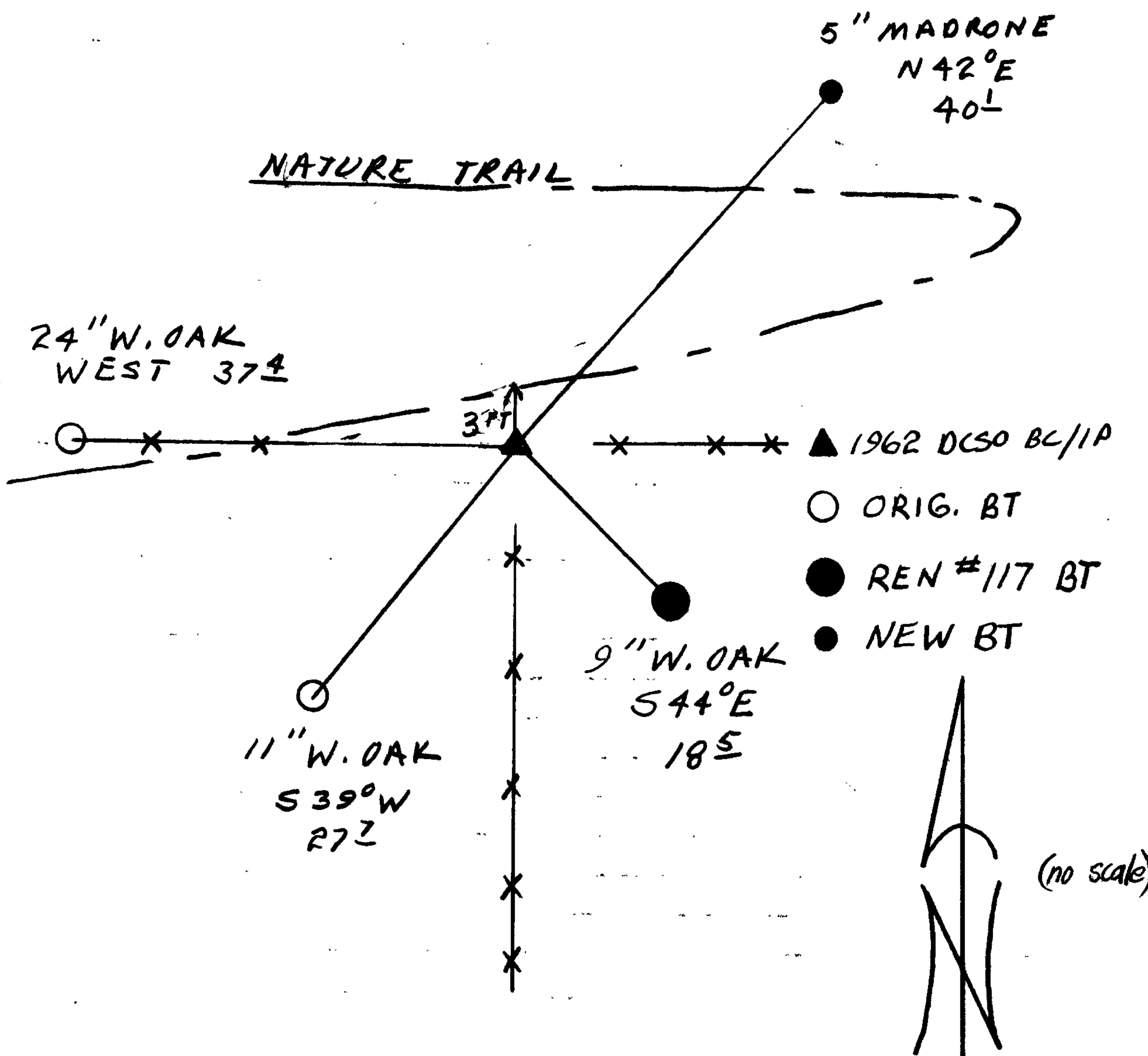

Location & Comments

CORNER IS LOCATED SOUTH EAST OF WILD LIFE SAFARI PICKNIC AREA, 3 FT SOUTH OF A TRAIL WHERE REMANANTS OF OLD WOVEN WIRE FENCES WERE SEEN RUNNING EAST, WEST, AND SOUTH.

Comp. Declin. 18°E
Agency DCSO
Party Chief RANDALL W SMITH
Notekeeper Randall W Smith
Witnesses STEPHEN J. FLAUSE

Address

Surveyor's Seal

REGISTERED
PROFESSIONAL
LAND SURVEYOR

Larry E. Monrean

OREGON
JULY 13, 1979
LARRY E. MONREAN
#1830

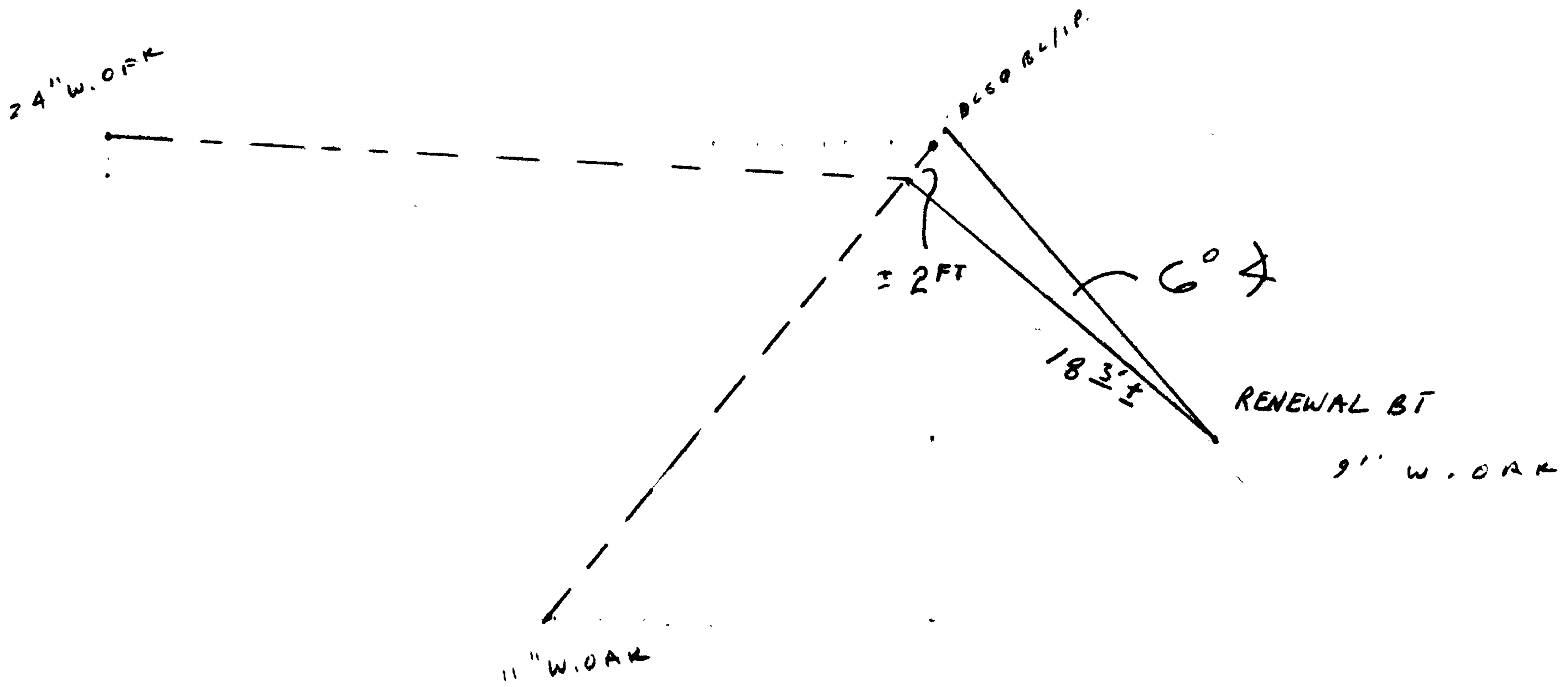

NEED 22° TO WORK
 APPROX 16° SLOPE
 TO 11" W. OAK