

GOVERNMENT CORNER RESTORATION FORM

Township 22S Range 5W Sec. 17 County DOUGLAS

State OR Date 6/28/88 No. _____

Corner Designation

S18	S17
S19	S20

- Condition Report Only
- Not Found
- Renewed
- Unrecorded
- Surveyed In
- Referenced Out

Previous Renewals #101

Monument(s) Found: (Condition and Source)

FD HAINES T-IRON OUT OF POSITION, LOOSLY SET AND BENT. T-IRON IS SET UPSIDE DOWN, WITH TOP SET 6 IN BELOW GROUND. T-IRON'S OVERALL LENGTH IS 4 FT.

T-IRON BEARS N 11° E, 17.0 FT FROM NEWLY SET ALSO BCLIP

STONES ARE SCATTERED THROUGH OUT AREA, NO DISTINCT MOUNDING, OR MARKS FOUND.

N/A

Accessories Found:

27" DIA, 1 1/2 FT HIGH D. FIR STUMP, A SMALL PORTION OF LOWER BLAZE IS LEFT ON STUMP, WE OPEN AND FIND PARTIAL SCRIBING "1" PROBABLY LOWER PORTION OF A "T", BEARS S 69 1/2° W, 338.0 FT PER REN #101

#186 X

RENEWAL

Monument Set (Procedure and Description)

A 1 1/4" OD BY 32" LONG DCSD BELL
IS SET AT A POSITION DETERMINED AT
RECORD BEARING AND DISTANCE FROM WILFORD
N. HAINES RENEWAL BT (REN#101). DCSD BELL
PROTRUDES 2 IN ABOVE GROUND.

Monument Detail

DOUGLAS COUNTY SURVEYORS
T 22 S
R 5 W
S18 | S17
S19 | S20
1988
OFFICE

New Accessories

11" DIA. W. OAK DOUBLE BLAZED AND SCRIBED "T22S R5W S19 CS BT"
BEARS S 6 1/4° W, 235.3 FT.

12" DIA. DOUBLE TRUNKED D. FIR DOUBLE BLAZED AND SCRIBED ON EAST
TRUNK "T22S R5W S19 CS BT" BEARS (TAKEN TO ROOT CROWN) S 79° W, 71.7 FT.

Sketch of Monument, Accessories, and General Area

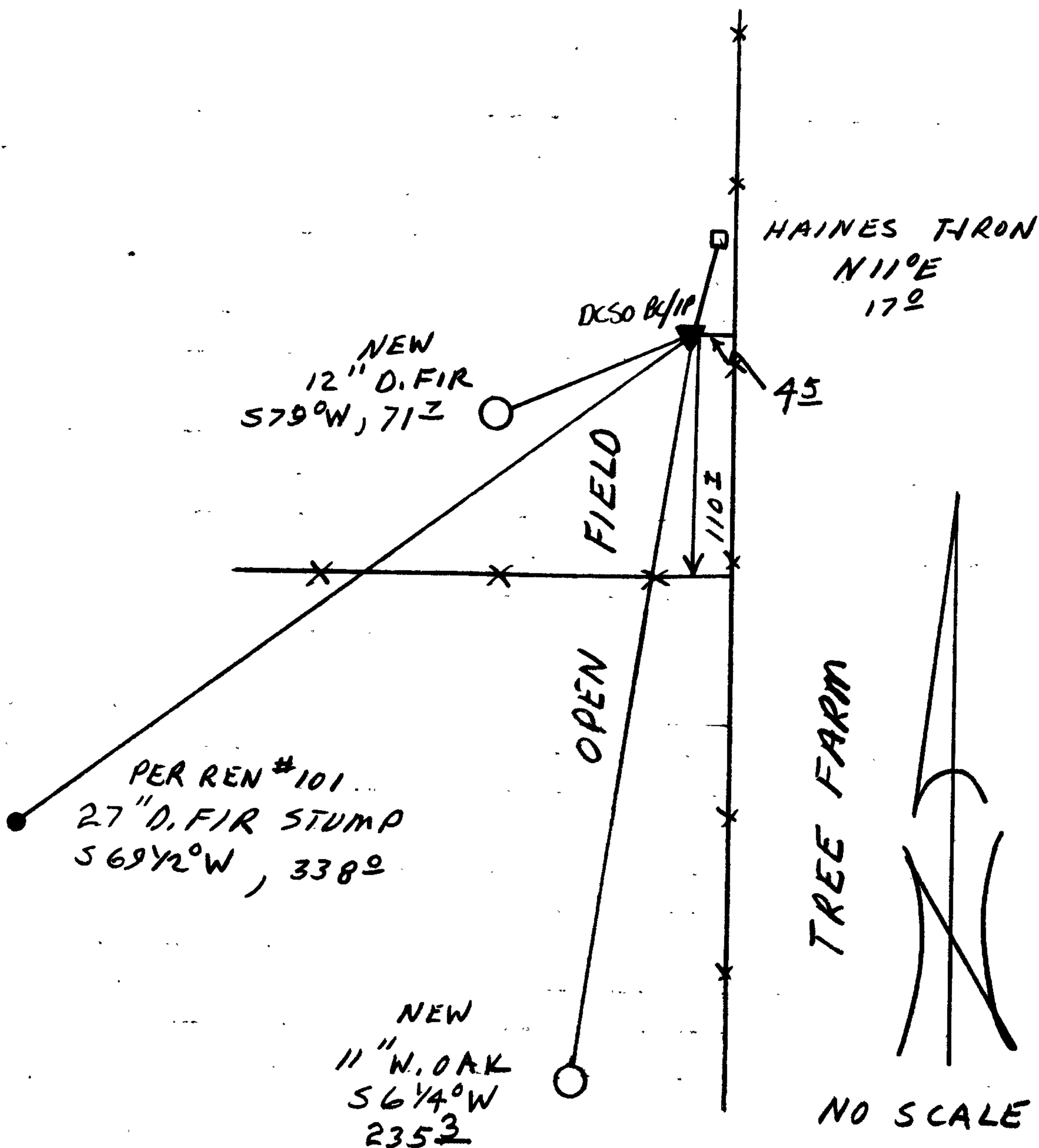

Location & Comments

Comp. Declin. 18° E
Agency DCSD
Party Chief RANDALL W. SMITH
Notekeeper Randall W. Smith
Witnesses STEPHEN J. FLAUSE

Address

Surveyor's Seal

REGISTERED
PROFESSIONAL
LAND SURVEYOR

Larry E. Monrean

OREGON
JULY 13, 1979
LARRY E. MONREAN
#1830

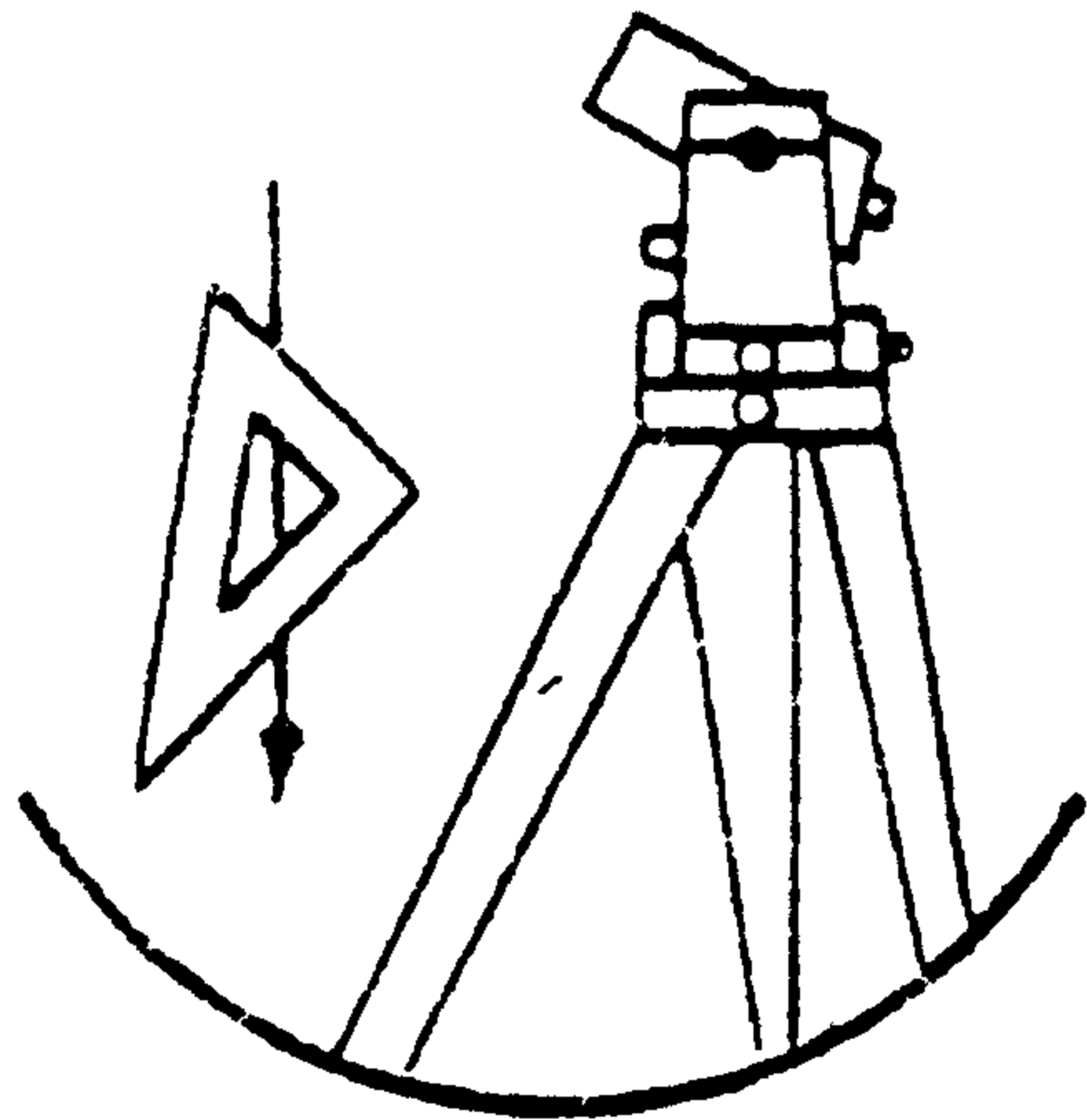

FRITZ INGRAM
COUNTY SURVEYOR

DOUGLAS COUNTY SURVEYOR'S OFFICE

ROOM 205 - JUSTICE BUILDING
ROSEBURG, OREGON 97470
PHONE 440-4272

May 5, 1988

Noel Hardie
Apt. 7, 4065 West 11th
Eugene, OR 97402

*P.O. Box 577
Drain (836-2003)
97435*

Dear Mr. Hardie:

Our office has been notified by Robert G. Dean, a Licensed Surveyor, that the section corner to Sections 17, 18, 19 and 20 in Township 22 South, Range 5 West is in poor condition. This section corner is on property you are leasing in the Hayhurst Road area.

As the Oregon Statutes require the County Surveyor to maintain these survey corners, we are requesting your permission to enter the property and renew the noted corner. The corner renewal would entail setting a brass cap monument (if possible) and blazing & scribing new bearing trees (if available).

We would like to do this work in the near future. Please advise us by phone or letter, if and when we may proceed. If keys are required to enter the property, please let us know. Thank you.

Sincerely,

Stephen Flause
Survey Technician

SJF/nw

5/11/88 - (11:30 am)

*Mr. Hardie called - OK to go on property BUT wants to give prior approval for any BT. as he is logging certain trees. (no locked gates) lives in barn - is usually around.
Tel. # 836-2003
C.S. 62/512-1*