

GOVERNMENT CORNER RESTORATION FORM

Township 30S Range 3W Sec. 29 County DOUGLAS

State OR Date 3/3/88 No. \_\_\_\_\_

Corner Designation

S30	S29
S31	S32

Condition Report Only  
 Not Found  
 Renewed  
 Unrecorded  
 Surveyed In  
 Referenced Out  
MONUMENT DETAIL

Previous Renewals 1893 GLO SURVEY, REN #84 (BY JOHN MARKHAM JR.)

Monument(s) Found: (Condition and Source)

ORIGINAL 1857 18 IN. NOW 31 IN. DIA. CORNER TREE, WITH BARK BLAZES FOUND ON THE SW, SE, NW, AND NORTH SIDE OF TREE. THE NORTH BLAZE SHOWS 5 AXE MARKS, THE EAST SIDE 3, AND THE SOUTH SIDE 2. WE OPENED SE AND SW BLAZES APPROX. 10 IN. AND FOUND NO SCRIBING, FACE, OR BURLING. NO SCRIBING WAS FOUND ON ANY OF THE BARK BLAZES.

1" I.D. IRON PIPE (REC. 3/4") PROTRUDING 3 IN. ABOVE GROUND PER REN #84. I.P. IS EAST 69.8 FT OF ORIGINAL CORNER TREE AS DESCRIBED ABOVE.

N/A

Accessories Found:

ORIG. BT'S

15" NOW 31" DIA. D. FIR WITH A POSSIBLE BLAZE WE OPENED AND FOUND BURL BUT NO SCRIBING. BEARS N54°W, 6.6 FT (REC. N40°W, 6.6 FT). (DUE TO LARGE AMOUNT OF DECAY IN THIS TREE AND IT'S LEANING POSITION WE ARE NOT ABLE TO MAKE A THOROUGH SEARCH FOR SCRIBING #84)

18" NOW APPROX. 20" DIA. BADLY ROTTEN D. FIR, ONLY VERY BOTTOM OF TRUNK AND ROOTS REMAIN, NO SCRIBING OR BLAZES FOUND BEARS S88°E, 23.1 FT.

POSSIBLE REMAINS OF ORIG. NE AND SW BADLY DECAYED BT'S FOUND AT RECORD BEARING AND DISTANCES.

1893 RENEWAL BT'S

11" NOW 12" DIA. D. FIR 12 FT HIGH SNAG WITH A FULLY HEALED SINGLE BLAZE WE OPEN AND FIND SCRIBING "R3W" BEARS N34°E, 14.5 FT (AGREES WITH REC)

18" NOW 31" DIA. D. FIR WITH A FULLY HEALED SINGLE BLAZE BEARS S41°E, 54.1 FT (AGREES WITH REC.)

10" NOW 12" DIA. D. FIR 7 FT HIGH SNAG WITH A FULLY HEALED SINGLE BLAZE BEARS S42°W, 38.0 FT (REC. S42°W, 31.0 FT).

#227X

RENEWAL

Monument Detail

Monument Set (Procedure and Description)

ORIGINAL CORNER TREE IS ALIVE, NO MONUMENTS SET.

N/A

New Accessories

8" DIA. CHINQUAPIN WITH A PISTOL BUTT MEASUREMENTS TAKEN TO CENTER OF ROOT CROWN DOUBLE BLAZED AND SCRIBED "T30S R3W S30 CS BT" BEARS N 30 1/2° W, 24.5 FT. 26" DIA. D. FIR DOUBLE BLAZED AND SCRIBED "T30S R3W S31 CS BT" BEARS S 28° W, 25.3 FT. 26" DIA. D. FIR BARK BLAZED AND SCRIBED "T30S R3W S29 CS BT" BEARS N 12° E, 15.4 FT.

Sketch of Monument, Accessories, and General Area

- ORIG. BT'S + CORNER TREE ● BT'S PER 1893 GLO SURVEY ○ 1" I.D. IRON PIPE PER REN #84 ● NEW BT'S

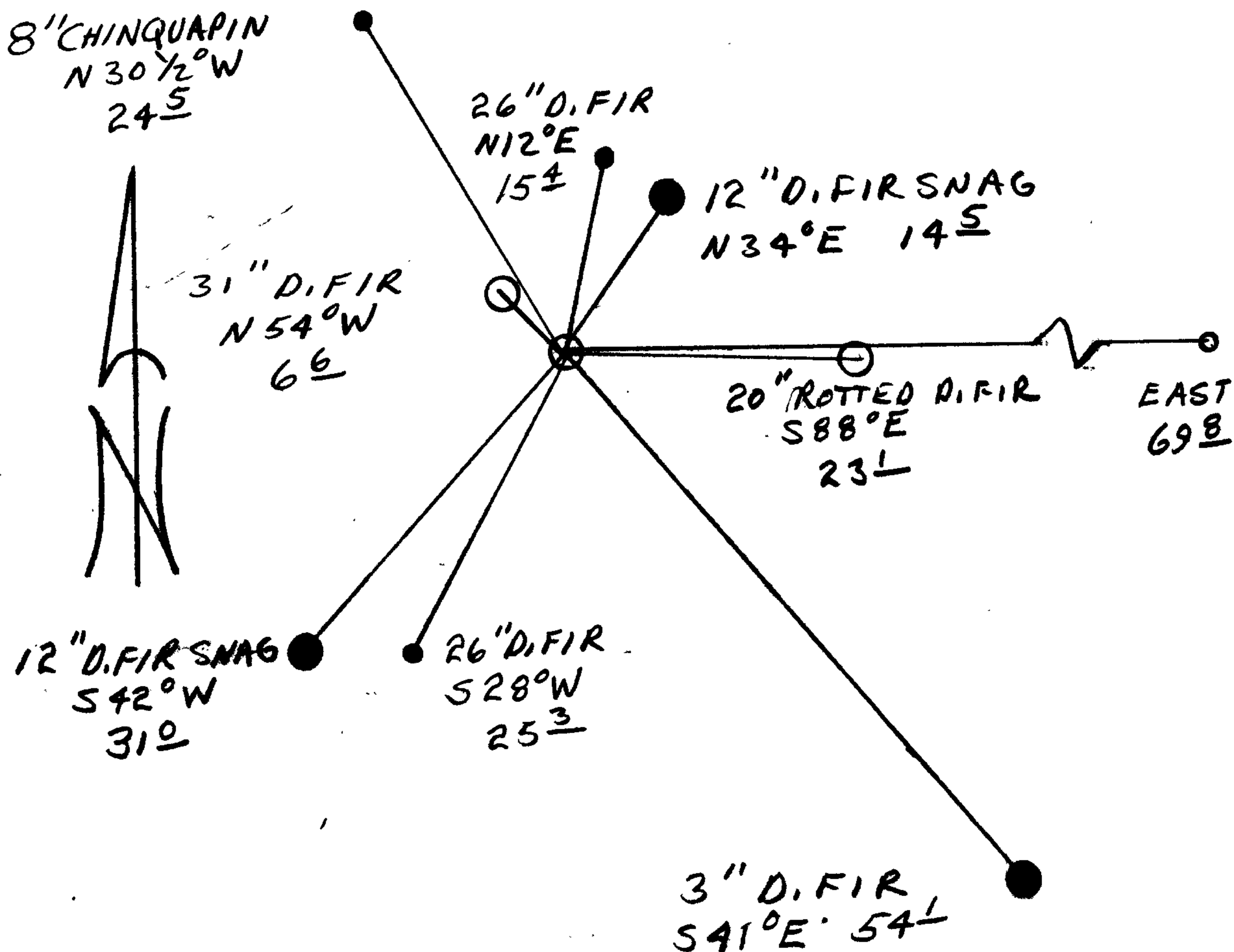

Location & Comments

SECTION CORNER AS MONUMENTED IN REN #84 IS APPARENTLY THE ~~FACT~~ WE COULD FIND NO RECORD OF OLD BT'S AS DESCRIBED IN REN #84. I.P. IS 28 YEARS OLD, MAY BE AN IMPORTANT POINT OF SURVEY. (SEE CONDITION REPORT DATED 3/3/88)

Comp. Declin. 18° E Agency DCSO Party Chief LARRY E. MONREAN Notekeeper RANDALL W. SMITH Witnesses STEPHEN J. FLAUSE

Surveyor's Seal

REGISTERED PROFESSIONAL LAND SURVEYOR

Larry E. Monrean

OREGON JULY 13, 1979 LARRY E. MONREAN #1830

GOVERNMENT CORNER RESTORATION FORM

Township 30S Range 3W Sec. 29 County DOUGLAS

State OREGON Date 3/3/88 No. \_\_\_\_\_

Corner Designation

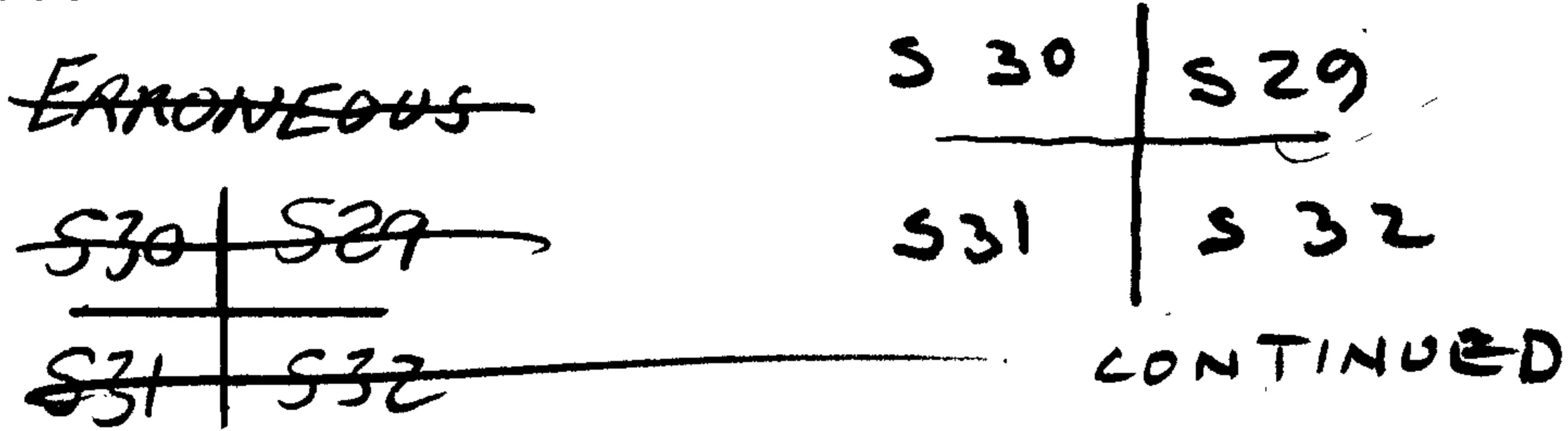

- Condition Report Only
- Not Found
- Renewed
- Unrecorded
- Surveyed In
- Referenced Out

Previous Renewals # 84

MONUMENT DETAIL

Monument(s) Found: (Condition and Source)

A 1 INCH I. D. IRON PIPE (RECORD 3/4" x 30" I.P.) FIRMLY SET AND PROTRUDING APPROXIMATELY 3 INCHES ABOVE GROUND (PER REN #84)

ORIGINAL 1857 18 IN. NOW 31 IN. DIA. CORNER TREE. (SEE CORNER RENEWAL DATED 3/3/88).

CORNER TREE BEARS WEST 69.8 FT FROM I.P.

N/A

Accessories Found:

~~X~~ B.T.'S AS RECORDED IN REN #84

24" NOW 28" DIA. D. FIR WITH A FULLY HEALED SINGLE BLAZE BEARS S29°W, 63.0 (AGREES WITH REN #84) SOURCE UNKNOWN.

30" NOW 32" DIA. D. FIR WITH A FULLY HEALED SINGLE BLAZE WHICH WAS PREVIOUSLY OPENED, WE REOPEN AND FIND POSSIBLE PIECES OF SCRIBING (APPROX. 90 YEARS OF OVER GROWTH EVIDENT) BEARS S70°E, 12.9 FT (AGREES WITH REN #84) SOURCE UNKNOWN.

30" NOW 30" DIA. D. FIR WITH A FULLY HEALED SINGLE BLAZE BEARS N54°E, 16.2 FT (AGREES WITH REN #84) SOURCE UNKNOWN

REN. BT'S PER REN #84

5" NOW 7" DIA. CHINQUAPIN IN A PARTIALLY HEALED DOUBLE BLAZE WITH ILLEGIBLE SCRIBE VISIBLE, BEARS S26°W, 38.0 FT (AGREES WITH REC.)

12" NOW 14" DIA. DEAD AND DOWN MADRONE WITH BARK SCRIBING VISIBLE "3S 30S" BEARS N44°W, 17.3 FT (AGREES WITH REC.)

12" NOW 13" DIA. MADRONE WITH A PARTIALLY HEALED DOUBLE BLAZE, SCRIBING VISIBLE "R3W S29 BT" BEARS N10°E, 25.2 FT (AGREES WITH REC.)

RENEWAL

Monument Set (Procedure and Description)

NONE

Monument Detail

N/A

New Accessories

NONE

Sketch of Monument, Accessories, and General Area

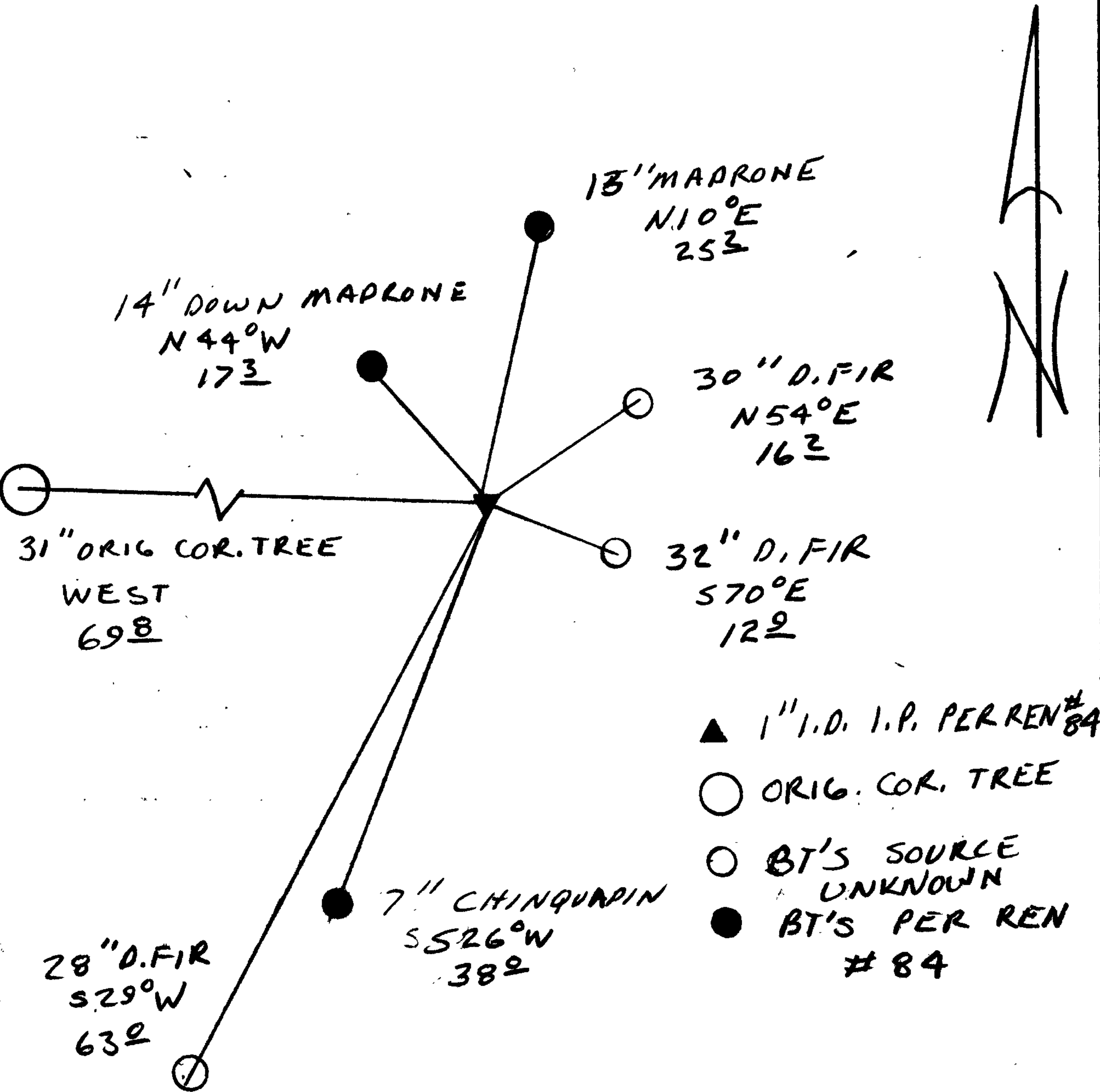

Location & Comments

FOR INFORMATION ON ORIGINAL CORNER SEE RECENT RENEWALS DATED 3/3/88. (SHEET 1 OF 2) I.P. CORNER IS APPARENTLY IN ERROR WE COULD FIND NO RECORD OF O.B.T.'S AS RECORDED IN REN #84. I.P. IS 28 YEARS OLD, MAY BE AN IMPORTANT POINT OF SURVEY

Comp. Declin. 18° E  
 Agency DCSO  
 Party Chief LARRY E. MONREAN  
 Notekeeper RANALL W. SMITH  
 Witnesses STEPHEN J. FLAUSE

Surveyor's Seal