

GOVERNMENT CORNER RESTORATION FORM

Township 28S Range 1W Sec. 5 County DOUGLAS

State OR Date 3/23/88 No. _____

Corner Designation

$\frac{1}{4}$ $\frac{S5}{S8}$

- Condition Report Only
- Not Found
- Renewed
- Unrecorded
- Surveyed In
- Referenced Out

Previous Renewals #39

Monument(s) Found: (Condition and Source)
A 10" X 10" X 4" STONE, WITH NO
MARKS, FIRMLY SET AND PROTRUDING
3 IN. ABOVE GROUND. STONE
RECORDED AS A 10" X 4" X 6" IN REN.
#39 AND ORIGINALLY AS A 12 X 10 X 6.

N/A

MONUMENT DETAIL

Accessories Found:

10" NOW 16" DIA. 6 FT HIGH HEMLOCK STUMP WITH A FULLY HEALED
SINGLE BLAZE, BEARS N 30° E, 10.6 FT (AGREES WELL WITH
RECORD PER. REN #39) ORIGINAL BT.

10" PINE NOW 16" DIA. 6 FT HIGH STUMP (SPECIES OF TREE
MAY BE WRONG, BARK LOOKS SIMILAR TO W. FIR) HAS A
FULLY HEALED, SINGLE BLAZE, OPENED AND SCRIBING FOUND
"4 S" BEARS S 22° W, 36.7 FT (AGREES WELL WITH RECORD
PER. REN #39) ORIGINAL BT.

18" NOW 18" DIA. 5 FT HIGH HEMLOCK STUMP WITH NAIL IN
BASE ON NORTH SIDE BEARS S 32° W, 8.8 FT TO HEAD OF
NAIL (RECORD S 28 1/2° W, 8.8 FT) PER REN # 39

10" HEMLOCK UPROOTED AND OUT OF GROUND
(RECORD S 59 1/2° E, 10.0 FT). PER REN #39.

METAL WITNESS POST AND SIGN BEARS N 50° W, 1.9 FT
(RECORD N 60° W, 1.9 FT) PER. REN. #39

#43X

RENEWAL

Monument Set (Procedure and Description)

POSITION OF STONE IS REFERENCED AND A 2 3/8" BRASS CAP ON A 1" I.D. X 32" LONG IRON PIPE SET AT REFERENCED POSITION, PROTRUDES 6 IN. ABOVE GROUND, STONE IS SET ALONG NORTHEAST EDGE OF BC/JP FLUSH WITH GROUND.

Monument Detail

DOUGLAS COUNTY SURVEYORS

T 285 RIW

1/4 $\frac{55}{58}$

1988

OFFICE

New Accessories

20" DIA. 14" HIGH D. FIR STUMP WITH A BOAT SPIKE STAMPED "BO1" SET THROUGH A BEARING TREE TAG INTO TOP OF STUMP NEAR CENTER. BOAT SPIKE BEARS N 89° E, 10.6 FT.

15" DIA. 12" HIGH HEMLOCK STUMP WITH A BOAT SPIKE STAMPED "BO2" SET THROUGH A BEARING TREE TAG INTO TOP OF STUMP NEAR CENTER. BOAT SPIKE BEARS N 40° W, 43.5 FT.

Sketch of Monument, Accessories, and General Area

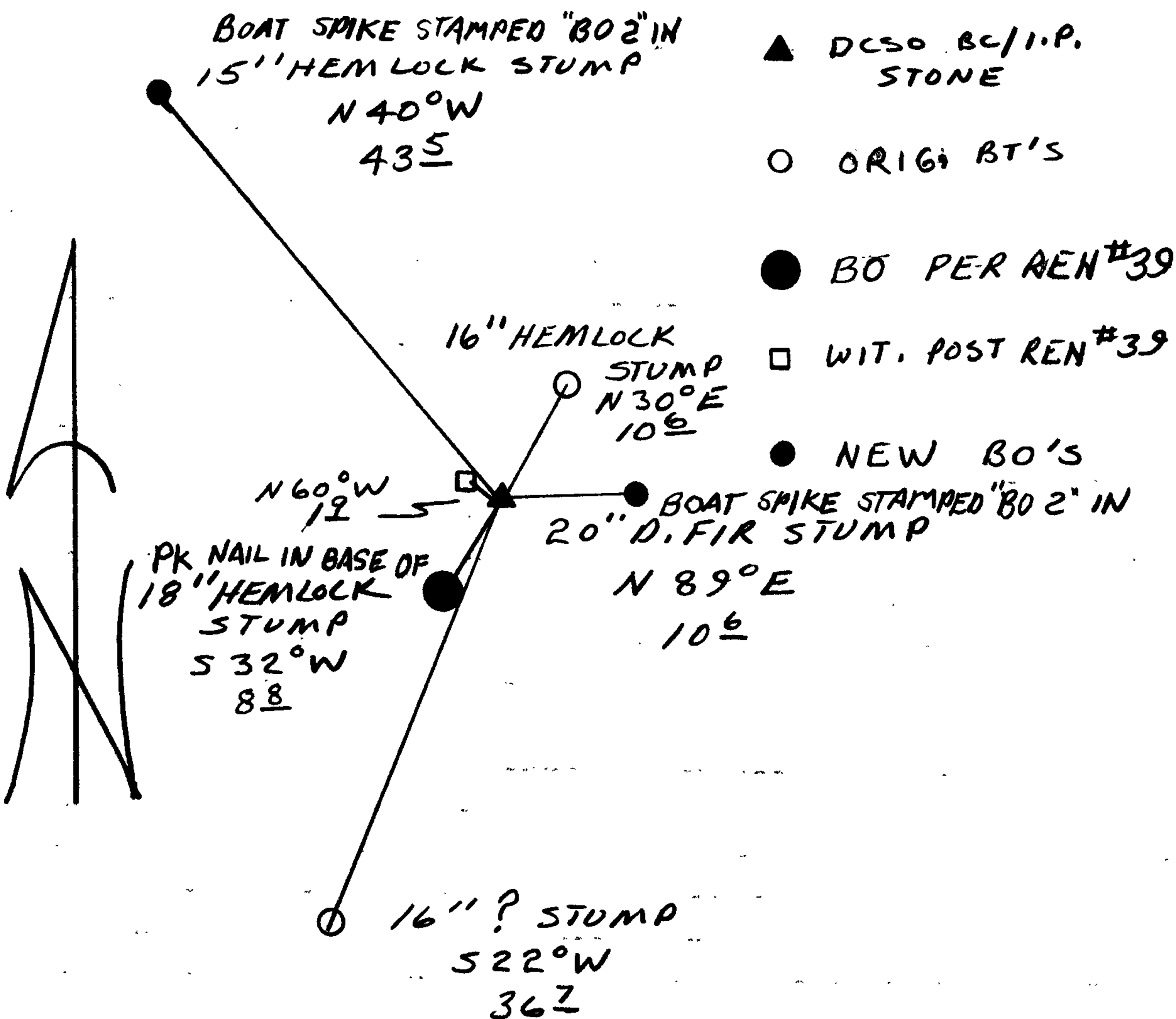

Location & Comments

CORNER LIES APPROX. 300 FT WEST OF EAST EDGE OF CLEAR CUT AND APPROX. 250 FT EAST OF LANDING AT END OF SPUR ROAD.

Comp. Declin. 18° E
 Agency DCSO
 Party Chief RANDALL W SMITH
 Notekeeper STEPHEN J FLAUSE
 Witnesses Steph J. Flause

Address

Surveyor's Seal

REGISTERED
PROFESSIONAL
LAND SURVEYOR

Larry E. Monrean

OREGON
JULY 13, 1979
LARRY E. MONREAN
#1830

GOVERNMENT CORNER RESTORATION FORM

FILED
RECEIVED

Township 28 S Range 1 W Sec. 5 County Douglas

APR 11 1984

State OREGON Date 3-29-84 No. _____

COUNTY SURVEYOR
DOUGLAS COUNTY, ORE.

Corner Designation

$\frac{1}{4}$ SS
SB

- Condition Report Only
- Not Found
- Renewed
- Unrecorded
- Surveyed In
- Referenced Out

Previous Renewals

MONUMENT DETAIL

Monument(s) Found: (Condition and Source)

Corner set by Homer D. ANGELL, 1902

Found: Basalt stone 10" x 4" x 6" High
(R-12"x10"x6") no marks visible

Accessories Found:

Hemlock 14" diam, N 30° E (R-N 25° E) 10.6 Ft. with a healed blaze. Painted 6" red band around tree.

Pine ^{SNA6} 18" diam, S 22° W, 36.7 Ft. (R-37.6 Ft) with a healed blaze. Painted 6" red band around tree.

39 +

C.S. File No. ~~5930~~ 62/50-13

RENEWAL

Monument Set (Procedure and Description)

Monument Detail

No monument set AT THIS TIME.
Monument should be set after
timber unit is cut.

New Accessories

Set 40 d. NAIL in base of 10" hemlock - Nail head bears $S 79\frac{1}{2}^{\circ} E$
10⁰ FT. painted 6" red band around tree

Set 40 d. NAIL in base of 18" hemlock - Nail head bears $S 28\frac{1}{2}^{\circ} W$
8⁰ FT. painted 6" red band around tree

Set guard post with 54-4 sign $N 60^{\circ} W$ 1⁹ FT

Sketch of Monument, Accessories, and General Area

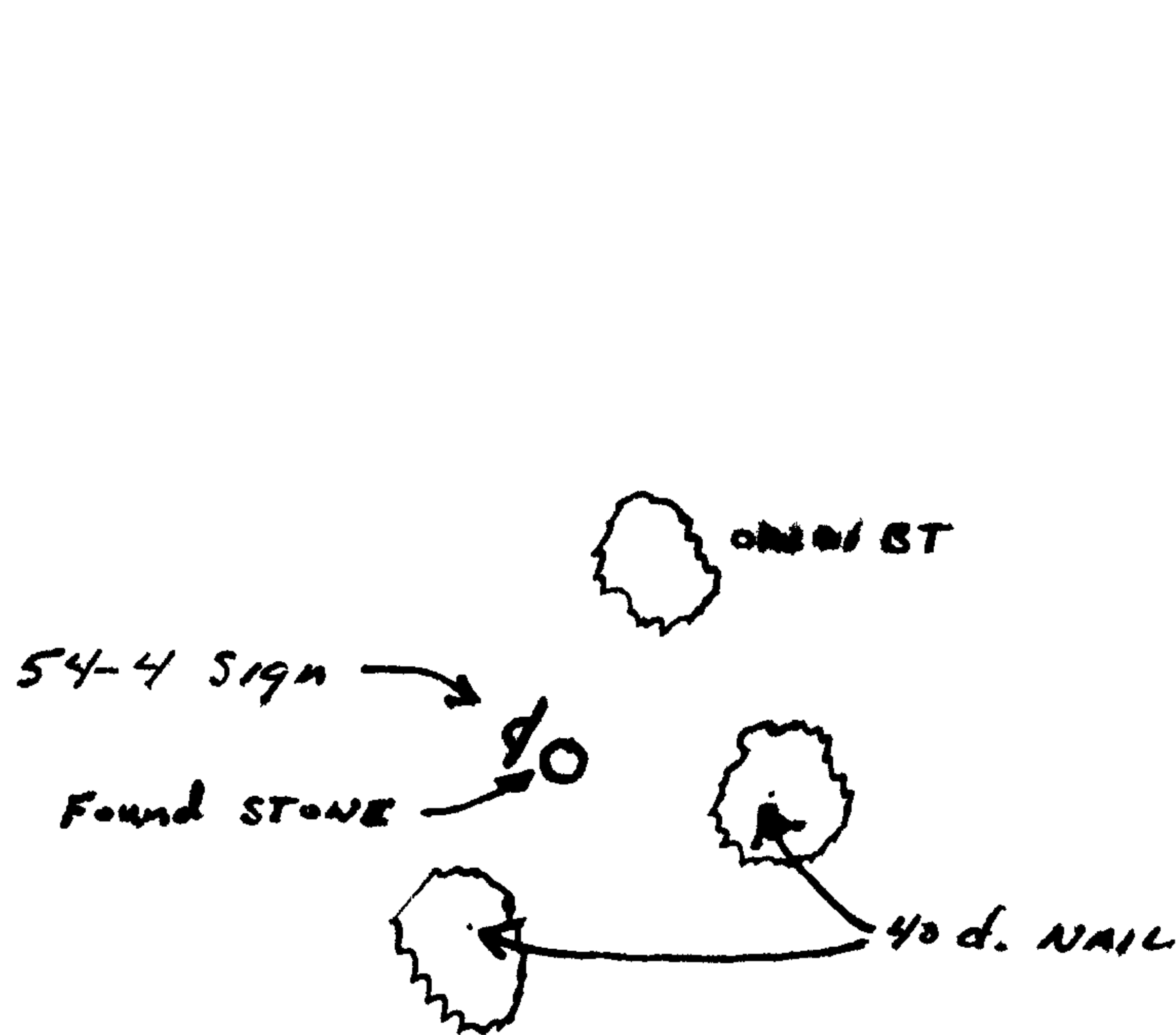

ORIG.
BT
(SNAG)

Location & Comments

CORNER FALLS ± 200 FEET inside
Proposed clear cut

Comp. Declin. $17^{\circ} E$
Agency USFS - Umpqua Nof
Party Chief Tim LANDRUM
Notekeeper Leonard HERZSTEIN
Witnesses Dennis Thrall

REGISTERED Surveyor's Seal
PROFESSIONAL
LAND SURVEYOR

Jan N. Landrum 4/4/84

OREGON
FEBRUARY 4, 1983
JAMES N. LANDRUM
2024