

GOVERNMENT CORNER RESTORATION FORM

Township 24S Range 7W Sec. 1 County DOUGLAS
State OR Date 1/25/88 No. _____

Corner Designation

S2 | S1
S11 | S12

Condition Report Only
 Not Found
 Renewed
 Unrecorded
 Surveyed In
 Referenced Out

Previous Renewals #34

MONUMENT DETAIL

Monument(s) Found: (Condition and Source)
A BRASS CAP ON A 1" I.P. MARKED AS AT RIGHT. BC/IP WAS MOWED OFF WITH 7" IN OF IRON PIPE ATTACHED TO BRASS CAP. REMAINING IRON PIPE PROTRUDES 7" IN OUT OF GROUND WITH TOP BENT WEST. BEARING AND DISTANCES OF ACCESSORIES TAKEN TO PLUMB POSITION OF BENT IRON PIPE (PER REN #34).

COUNTY SURVEYORS OFFICE
T 24S

S2 | S1
S11 | S12
R 7W
1958

18" X 13" X 3" STONE FOUND LAYING FLAT ON EAST EDGE OF PLUMB POSITION OF BENT IRON PIPE NEAR SURFACE (SOURCE UNKNOWN)

Accessories Found:

18" NOW 54" DIA. B. OAK WITH FULLY HEALED BLAZES BEARS S30°W, 47.7 FT (ORIG. REC. S5°W, 46.2 FT) ORIG. BT, RE-Scribed IN REN #34

ORIG. SOUTH EAST BT IS GONE A DEPRESSION IN GROUND IS FOUND NEAR BEARING AND DISTANCE.

24" NOW 62" DIA. B. OAK WITH A BURNT OUT FACE NO SCRIBING SEEN, BEARS N10°E, 196.6 FT (REC. N10°E, 194.7 FT. POSSIBLE FACE MEASUREMENT) ORIG BT

18" NOW 36" DIA OAK WITH A PREVIOUSLY OPENED NOW BURNT AND ROTTED BLAZE, NO SCRIBING FOUND, BEARS N84°W, 145.5 FT (REC. N84°W, 143.8 POSSIBLE FACE MEASUREMENT). ORIG BT

14" NOW 18" DIA. B. OAK WITH A FULLY HEALED DOUBLE BLAZE BEARS N10°E, 61.5 (AGREES WITH REC.) PER REN #34

2" NOW 12" DIA. W. OAK WITH A FULLY HEALED DOUBLE BLAZE BEARS S55°20'E, 31.8 FT (AGREES WITH REC.) PER REN #34

15" NOW 19" DIA. W. OAK WITH A FULLY HEALED DOUBLE BLAZE BEARS N81°W, 108.5 FT (REC. N81°W, 109.0 FT) PER. REN #34

RENEWAL

Monument Set (Procedure and Description)

A 2 3/8" IN. BRASS CAP ON A 1/4 IN OUTSIDE DIA. BY 31 IN LONG I.P. IS SET FLUSH WITH GROUND, MARKED AS AT RIGHT. 1958 BRASS CAP WITH 7 IN. OF IRON PIPE SET 5 IN. BELOW GROUND ALONG SOUTH EDGE OF NEW BC/I.P. 18" X 13" X 3" STONE WAS UNDISTURBED WHILE SETTING NEW BC/I.P. LIES ALONG EAST EDGE OF NEW BC/I.P. CORNER POSITION IS PERPETUATED AT THE PLUMB POSITION OF BENT TOP IRON PIPE SET IN REN #34. THIS POSITION IS REFERENCED AND ABOVE MONUMENTS SET.

Monument Detail

DOUGLAS COUNTY SURVEYORS
T24S
S2 | S1
S11 | S12
R7W
1988

New Accessories

NONE

Sketch of Monument, Accessories, and General Area

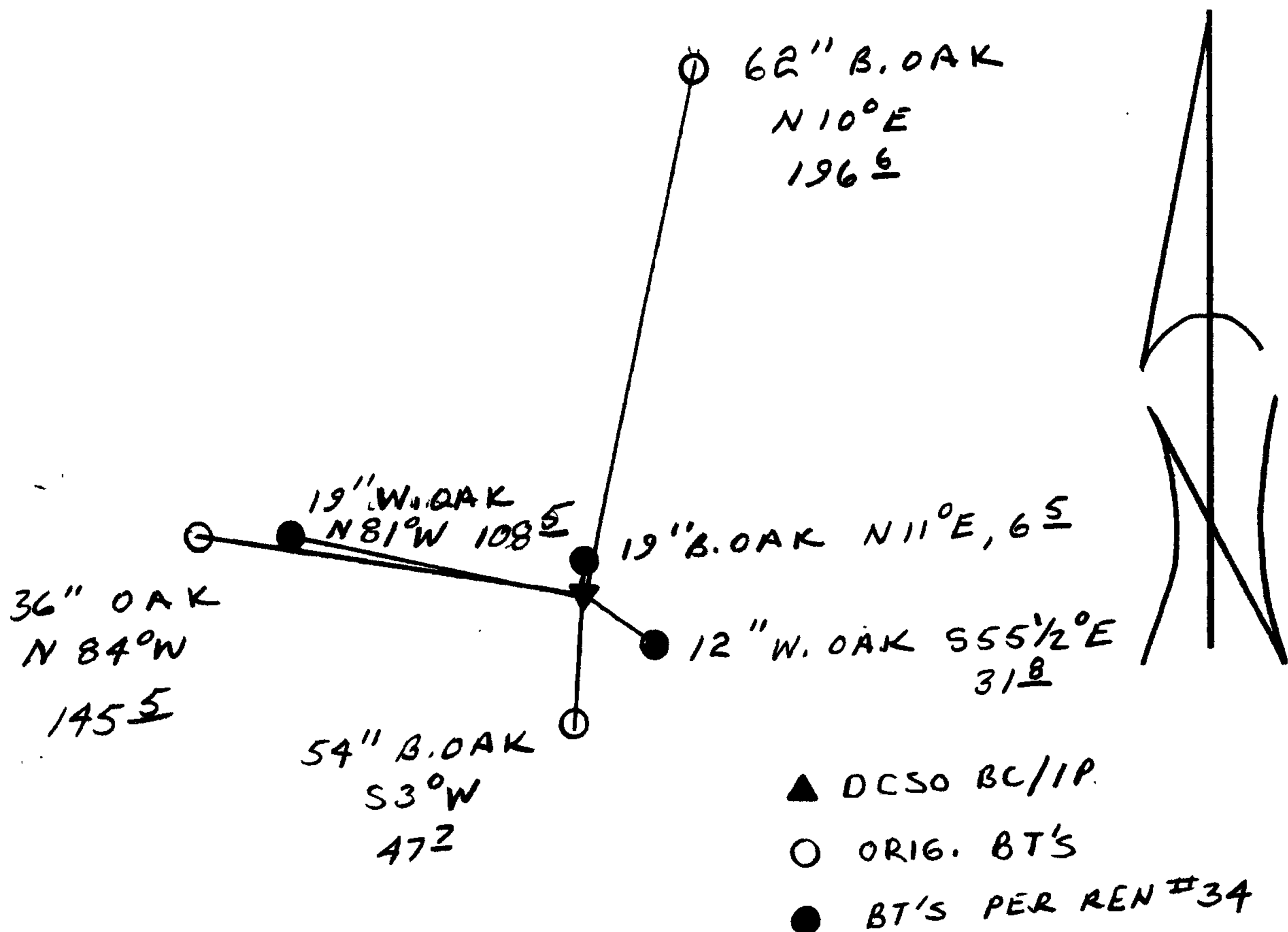

Location & Comments

CORNER LIES ON A WESTERLY SLOPING HILLSIDE

Comp. Declin. 18 1/2° E
Agency DCSO
Party Chief RANDALL W SMITH
Notekeeper Randall W Smith
Witnesses STEPHEN J FLAUSE

Surveyor's Seal

REGISTERED PROFESSIONAL LAND SURVEYOR

Larry E. Monrean
OREGON
JULY 13, 1979
LARRY E. MONREAN
#1830