

GOVERNMENT CORNER RESTORATION FORM

Township 21S Range 6W Sec. 4 County DOUGLAS

State OR Date 3/1/88 No. _____

Corner Designation

$\frac{1}{4}$ S5 | S4

- Condition Report Only
- Not Found
- Renewed
- Unrecorded
- Surveyed In
- Referenced Out

Previous Renewals M105-45 #140

Monument(s) Found: (Condition and Source)

A 5/8" I.R. WITH PLASTIC CAP
MARKED "MARK + ASSOCS" FIRMLY
SET AND PROTRUDING 5 IN. ABOVE
GROUND. PER M105-45

N/A

Accessories Found:

A LIMITED SEARCH WAS MADE FOR ORIGINAL CORNER
AND BEARING TREES, NONE WERE FOUND.

#141 X

RENEWAL

Monument Set (Procedure and Description)

A DCSO 2 1/2" BRASS CAP ON A 1/2" DIA. X 31" LONG IRON PIPE WAS SET AT REFERENCED POSITION OF 5/8" I.R. DCSO BC/IP. PROTRUDES 3 IN ABOVE GROUND MARKED AS AT RIGHT. 5/8" I.R. SET ALONG NORTHEAST EDGE OF DCSO BC/IP, PROTRUDING 2 IN ABOVE GROUND.

DCSO BC/IP PERPETUATES A SURVEY POINT AS DETERMINED BY D.E. MARX (M105-45)

Monument Detail

DOUGLAS COUNTY SURVEYORS

T 21 S

1/4 S 51 S 4

R 6 W

1988

New Accessories

7" DIA. HEMLOCK DOUBLE BLAZED AND SCRIBED "1/4 S 5 CS BT" BEARS N 54° W, 22.1 FT

22" DIA. D. FIR DOUBLE BLAZED AND SCRIBED "1/4 S 5 CS BT" BEARS S 15 1/2° W, 12.3 FT

5" DIA. D. FIR DOUBLE BLAZED AND SCRIBED "X BT" BEARS N 42° E, 22.7 FT

6" DIA. D. FIR DOUBLE BLAZED AND SCRIBED "1/4 S 4 CS BT" BEARS N 80° E, 35.8 FT

Sketch of Monument, Accessories, and General Area

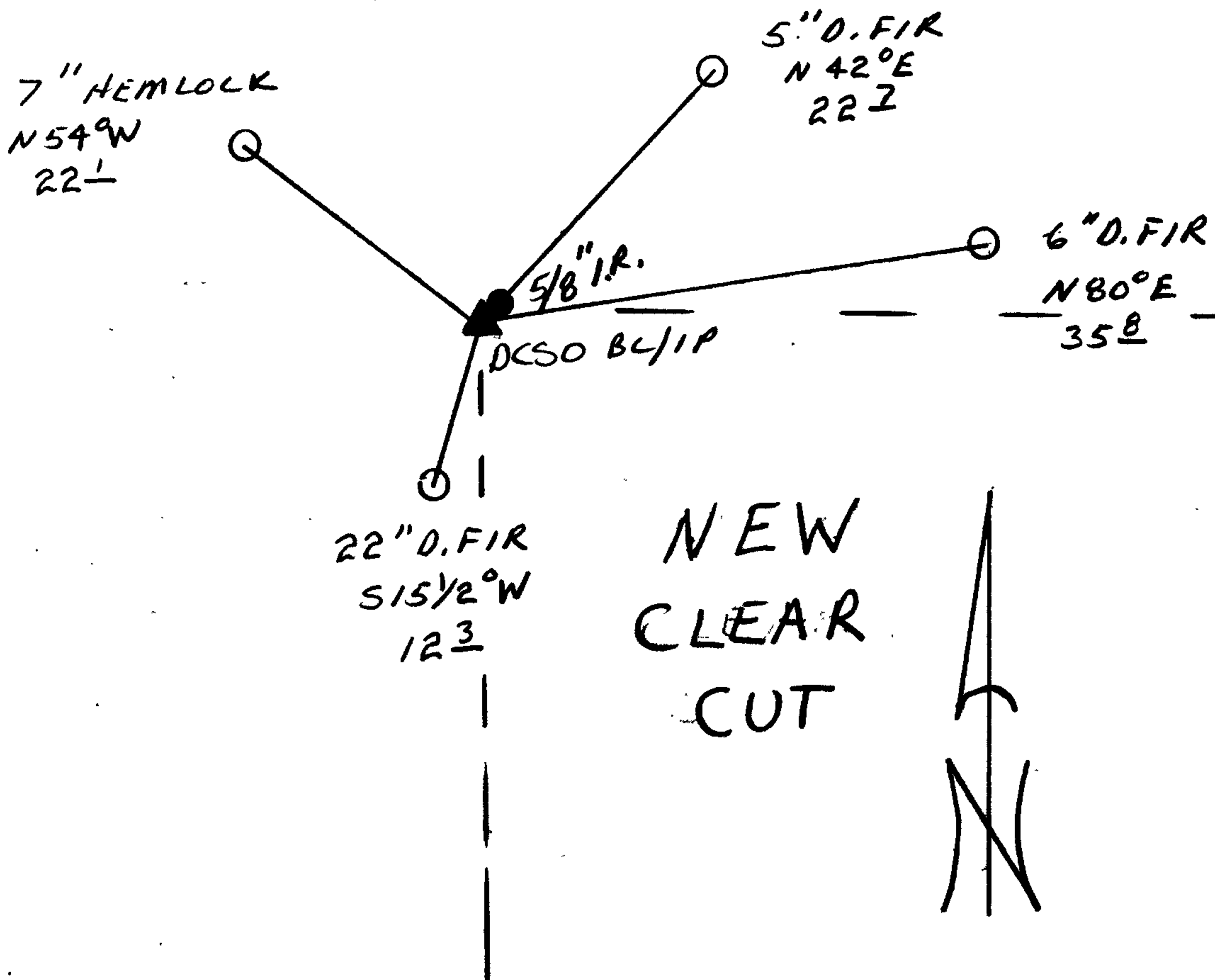

Location & Comments

CORNER LIES ON A STEEP NORTH SLOPE APPROX 500 FT NORTH OF AN EAST - WEST RIDGE AND APPROX. 200 FT SOUTH WEST OF THE CONVERGENCE OF TWO GULLIES.

Comp. Declin. 18 1/4° E
Agency DCSO
Party Chief RANDALL W SMITH
Notekeeper Randall W Smith
Witnesses STEPHEN J FLAUSE

Surveyor's Seal

REGISTERED PROFESSIONAL LAND SURVEYOR

Larry E. Monrean

OREGON JULY 12, 1979 LARRY E. MONREAN #1830