

GOVERNMENT CORNER RESTORATION FORM

Township 22S Range 13W Sec. 13 County DOUGLAS

State OR Date 1/14/88 No. _____

Corner Designation

NW 1/16

- Condition Report Only
- Not Found
- Renewed
- Unrecorded
- Surveyed In
- Referenced Out

Previous Renewals M 1-74, CS 51/252, M 56-14

Monument(s) Found: (Condition and Source)

TWO IRON PIPES WERE FOUND IN THE GENERAL VICINITY OF THE NW 1/16 CORNER, ONE AN IRON PIPE USED AS THE NW 1/16 CORNER IN SURVEY M 56-14 (1 1/2" I.D. I.P. PROTRUDING 8 IN ABOVE GROUND REC. 2" I.A.) SOURCE UNKNOWN; THE OTHER A 1 1/2 IN I.D. IRON PIPE WITH A CONCRETE BASE (REC. 2" I.P.) FOUND OUT OF GROUND, PROBABLY USED AS NW 1/16 COR. IN SURVEY C.S. 51/252. SOURCE UNKNOWN. NO OTHER MONUMENTS FOUND.

N/A

FILED

JAN 21 1988

COUNTY SURVEYOR DOUGLAS COUNTY, OR

Accessories Found:

NONE

RENEWAL

Monument Set (Procedure and Description)

A 3 INCH DIAMETER BRASS CAP MARKED AS AT RIGHT, SET IN CONCRETE FILLED 8"x42" CONCRETE BELLTILE. MONUMENT PROTRUDES 4" ABOVE GROUND. IRON PLACED INSIDE BELLTILE FOR FUTURE MAGNETIC DETECTION. THE I.P. USED AS NW 1/4 CORNER IN SURVEY M 56-14 WAS DETERMINED TO BE IN POOR RELATIONSHIP WITH OTHER FOUND MONUMENTS ALONG THE 1/4 LINE TO THE EAST, IT'S POSITION WAS FOUND TO BE OVER 16 FEET NORTH OF LINE. THE POSITION OF THE NW 1/4 CORNER IS DETERMINED BY PROJECTING A LINE FROM THE SW 1/4 CORNER WESTERLY THROUGH THE MOST WESTERLY MONUMENT SET BY HINTZ (C551/252) AND USING THE HINTZ RECORD DISTANCE OF 158.8 FT TO RE-ESTABLISH THE NW 1/4 CORNER.

Monument Detail

DOUGLAS COUNTY SURVEYOR'S OFFICE
T 22 S

NW 1/4 + S13

R 13 W

1988

New Accessories

- 7" DIA. SHORE PINE DOUBLE BLAZED AND SCRIBED "NW 1/4 S13CS BT" BEARS N 64° E, 11.7 FT.
- 10" DIA. SHORE PINE DOUBLE BLAZED AND SCRIBED "NW 1/4 S13CS BT" BEARS N 65° W, 18.5 FT.
- POWER POLE BEARS S 45° W, 6.2 FT.
- 1 1/2" IRON PIPE I.P. PROTRUDING 8 IN. ABOVE GROUND BEARS N 10° W, 16.24 FT.
- METAL WIT. POST BEARS SOUTH, 2.0 FT

Sketch of Monument, Accessories, and General Area

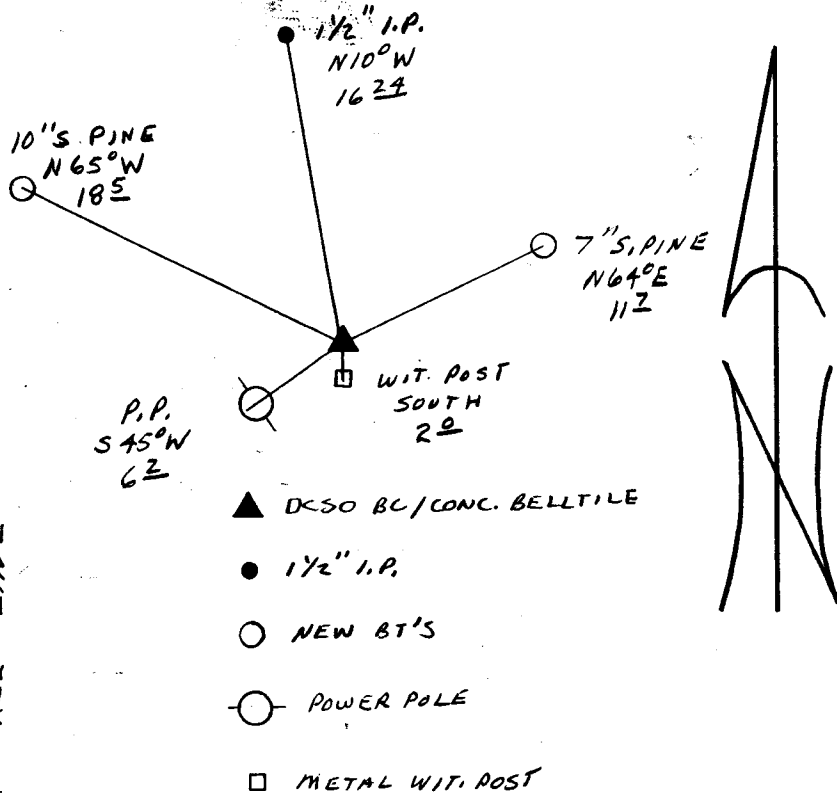

Location & Comments

CORNER LIES ON A NORTH-SOUTH RIDGE APPROX. 40 FT EAST OF TREE LINE AND EDGE OF SAND DUNES.

Comp. Declin. 18 1/2° E
 Agency DCSO
 Party Chief RANDALL W. SMITH
 Notekeeper Randall W. Smith
 Witnesses STEPHEN J. FLAUSE

Surveyor's Seal

REGISTERED
PROFESSIONAL
LAND SURVEYOR.

Handwritten signature

OREGON
JULY 13, 1979
LARRY E. MONREAN
#1830